



47, Pope Street, Maidstone, ME16 8LG
£265,000

About this property.....

If you are looking for a well presented 2 bedroom home in Maidstone then look no further. This one is really well laid out with a useful entrance hall to keep the draughts out and a separate first floor bathroom off a landing, so no need to go through a bedroom to get to the bathroom as is often the case with this style of property. The property boasts double glazing, gas central heating and a neatly presented rear garden.

The location is great for commuters, being a short distance from Maidstone West station which has high-speed trains to London St Pancras in as little as 51 minutes.

Situation.....

Maidstone, the county town of Kent, is a shopper's paradise with a vibrant mix of unique stores and popular high street brands. Foodies will also be spoilt for choice with a range of options from traditional afternoon tea to fine dining experiences. The town's buzzing nightlife is another highlight, with a variety of pubs, bars and entertainment venues to suit all tastes.

Outdoor enthusiasts will find plenty to keep them busy too, from cruising down the river on the Kentish Lady to exploring the many cycling and walking routes that showcase the region's charm and heritage. Families will love attractions such as Kent Life Heritage Farm and the 450-acre Mote Park, offering unforgettable experiences for all ages.

Maidstone is home to several primary and secondary schools, including four grammar schools. Commuting to London is a breeze with direct train links from Maidstone East and Maidstone West stations, with journey times as short as 51 minutes. The town also has excellent road connections, with easy access to the M20 motorway junctions 5 to 7 providing routes to London and the coast.









What the owner says.....

This is a warm and comfortable house with character and a nice size garden to sit in and enjoy the nice British weather. The road is wider than most in the area and parking is adequate. Within a short walk you are in the countryside and there is a bus stop at the bottom of the road. Maidstone is a 10 minute drive away.

47, Pope Street, Maidstone, ME16 8LG

Ground Floor

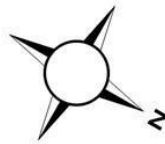
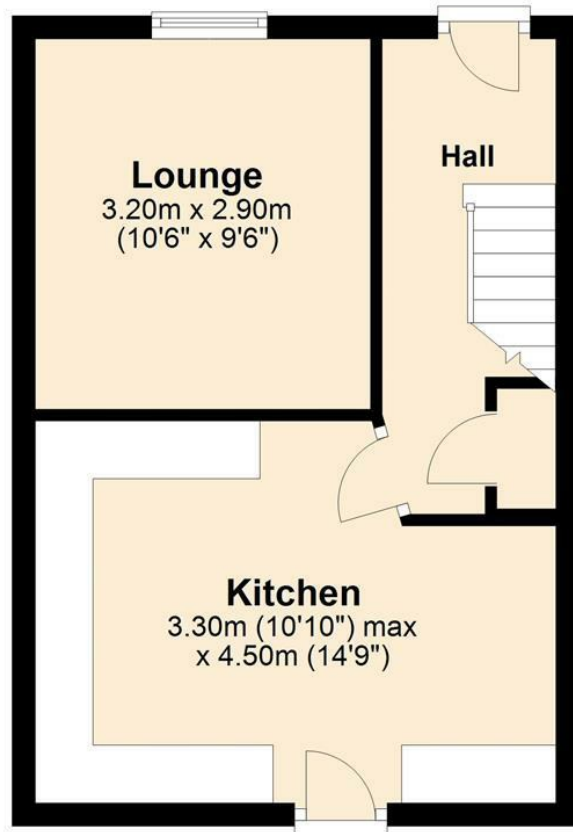

First Floor

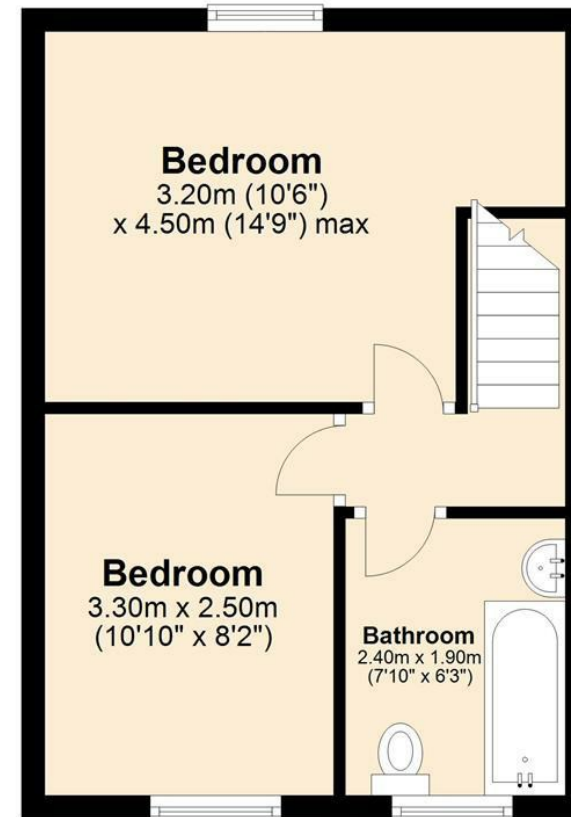

Total area: approx. 59.5 sq. metres (639.9 sq. feet)

Agents Notes

Floor plans produced for illustrative purposes only. The position and sizes of doors, windows, rooms and other items are approximate and no responsibility is taken for any error, omission or mis-statement. These particulars are produced for information only and do not form part of any contract. The agent has not had sight of any title documents. Fixtures, fittings and services not tested.



bluebell-estates.co.uk