



6, Sandling Court, Sandling Lane, Penenden Heath, Maidstone, ME14 2HR
£195,000

About this property.....

OPEN DAY SATURDAY 19TH JULY - BY APPOINTMENT ONLY

Chain Free # Driveway & Garage #Share Of Freehold # Garden.

Welcome to 6 Sandling Court, a GROUND FLOOR maisonette located in the picturesque area of Penenden Heath, Maidstone. This CHAIN FREE property boasts 1 reception room, 2 cosy bedrooms, and a well-maintained kitchen and bathroom, making it the perfect home for a small family or a couple looking to settle down.

One of the standout features of this property is the ample PARKING space it offers - with parking for 2 - 3 vehicles on the DRIVEWAY to the front and the GARAGE to the rear adding convenience and also extra storage space. Additionally, the front and rear GARDENS provide an outdoor space where you can relax and unwind, perfect for enjoying time outside on a sunny afternoon.

With approximately 86 years left on the lease, a SHARE OF THE FREEHOLD, gas central heating, double glazing and a modern light filled interior we think this home would make a great purchase.

Don't miss out on the opportunity to make Sandling Court your new home - book a viewing today and experience the charm and comfort this property has to offer.

Situation.....

The area of Pendenden Heath on the North side of Maidstone, boasts a parade of local shops and recreational facilities on 'the Heath'. Maidstone is the County town of Kent and as such boasts extensive retail, entertainment and leisure facilities in addition to numerous state and grammar educational establishments. The town has mainline train links via Maidstone East train station giving journey times to London of just over 1 hour. The town also has links to junctions 5, 6 and 7 of the M20 providing road access to London.









Useful Information.....

Property is sold with 1/6th share of the freehold
Original lease term 125 years from 24/06/1986
No ground rent payable
Approximate current annual share of costs such as buildings insurance and accounting is £400 per flat.

6, Sandling Court, Sandling Lane, Penenden Heath, Maidstone, ME14 2HR

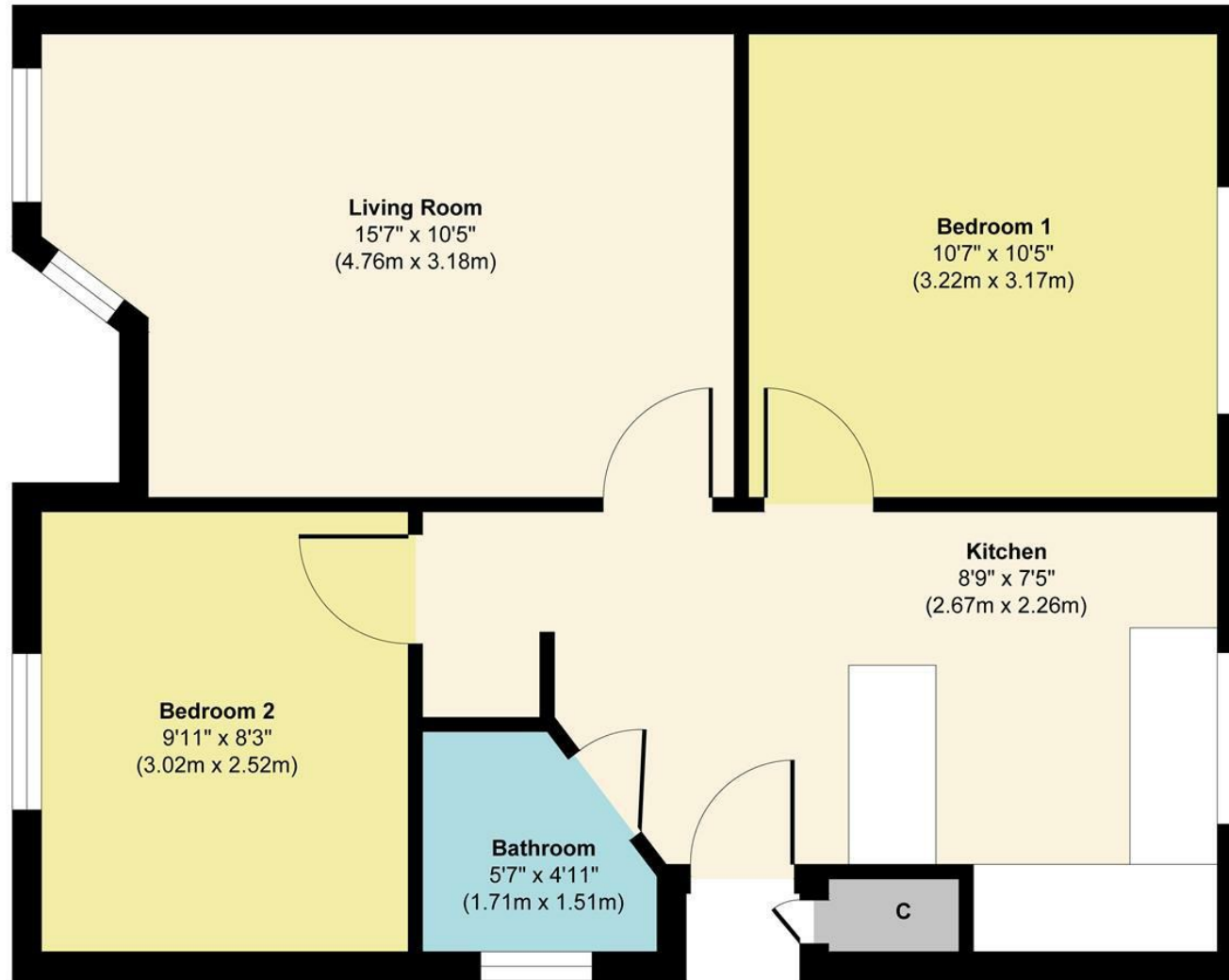

Floor Plan
Approximate Floor Area
527 sq. ft
(49.01 sq. m)

Approx. Gross Internal Floor Area 527 sq. ft / 49.01 sq. m

Illustration for identification purposes only, measurements are approximate, not to scale.

Produced by Elements Property

Agents Notes

Floor plans produced for illustrative purposes only. The position and sizes of doors, windows, rooms and other items are approximate and no responsibility is taken for any error, omission or mis-statement. These particulars are produced for information only and do not form part of any contract. The agent has not had sight of any title documents. Fixtures, fittings and services not tested.



bluebell-estates.co.uk

