



Williams
PROPERTIES



Dalesford Road, AYLESBURY

Williams are pleased to offer a first floor flat situated in the sought after Stoke Grange development. The property comprises of an entrance hall, lounge/diner, well appointed and kitchen with white goods included, bathroom with luxury wash basin and bath with an independent shower over. There is also a good size bedroom allocated parking and an outdoor storage cupboard. Available 27th April 2020. No pets!

£650 Per month

Energy Efficiency Rating			Environmental Impact (CO ₂) Rating		
Very energy efficient - lower running costs	Current	Potential	Very environmentally friendly - lower CO ₂ emissions	Current	Potential
	65	78		57	64
England & Wales			England & Wales		

90 Dalesford Road
| AYLESBURY | Buckinghamshire | HP21 9XZ

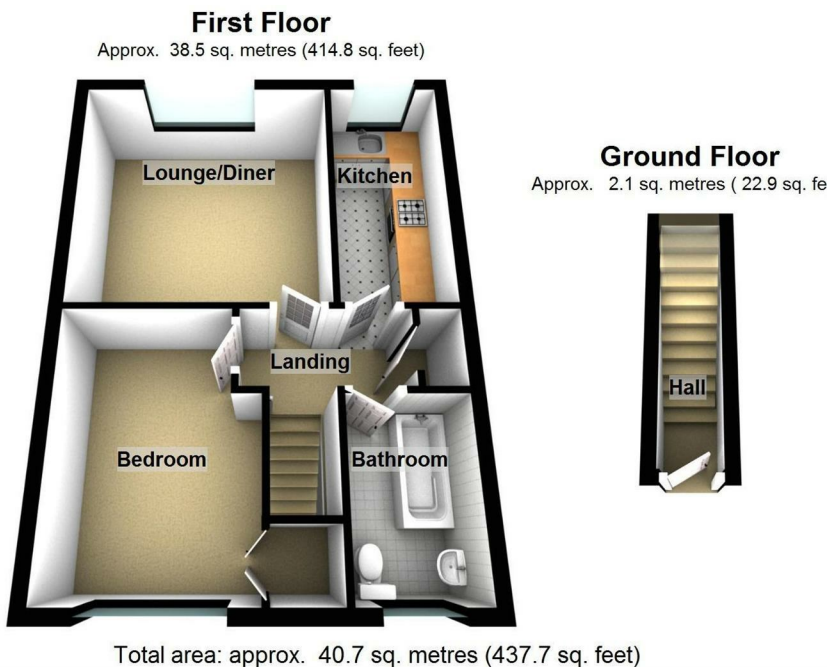

For clarification, we wish to inform perspective purchasers that we have prepared these sales particulars as a general guide. We have not carried out a detailed survey, nor tested the services, appliances and specific fittings. Room sizes are approximate and rounded; they are taken between internal wall surface and therefore include cupboards/shelves, etc. Accordingly, they should not be relied upon for carpets and furnishings. Formal notice is also given that all fixtures and fittings, carpets, curtains/blinds and kitchen equipment, whether fitted or not are deemed removable by the vendor unless specifically itemised within these particulars.

8-10 Temple Street, Aylesbury
Buckinghamshire HP20 2RQ
t: 01296 435600
e: info@williams.properties
www.williamsaylesbury.co.uk