

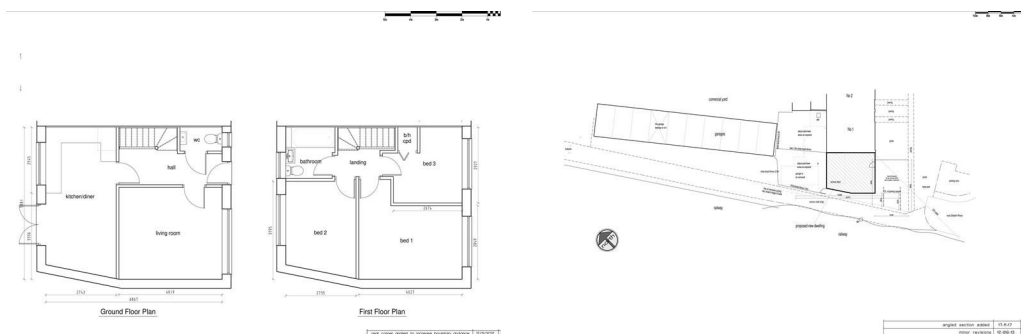

**Williams**  
PROPERTIES



## Dolphin Place, Aylesbury

**BUILDING PLOT** - Planning permission approved for a three bedroom end of terrace property. Planning Application No -17/01710/APP  
Call Williams Properties for further information - 01296 435600

**Price £100,000**

Plot 1 Dolphin Place

| Aylesbury | Buckinghamshire | HP21 7TG

### Aylesbury Town

A central location within easy reach of local amenities including shopping, sports facilities, eateries, bars and for commuters a mainline rail service which reaches London Marylebone in about 55 minutes. The A41 gives fast access to both the M40 & M25 motorway network.

Gross internal floor area of planned new house is 80 sq metres or 861 sq feet.  
Overall plot size is 146.5 sq metres or 1577 sq feet.



For clarification, we wish to inform perspective purchasers that we have prepared these sales particulars as a general guide. We have not carried out a detailed survey, nor tested the services, appliances and specific fittings. Room sizes are approximate and rounded; they are taken between internal wall surface and therefore include cupboards/shelves, etc. Accordingly, they should not be relied upon for carpets and furnishings. Formal notice is also given that all fixtures and fittings, carpets, curtains/blinds and kitchen equipment, whether fitted or not are deemed removable by the vendor unless specifically itemised within these particulars.

8-10 Temple Street, Aylesbury  
Buckinghamshire HP20 2RQ  
t: 01296 435600  
e: [info@williams.properties](mailto:info@williams.properties)  
[www.williamsaylesbury.co.uk](http://www.williamsaylesbury.co.uk)



**Williams**  
PROPERTIES