



Low Street | Sherburn In Elmet | LS25 6BB

£290,000

Three bedroom semi-detached | Council Tax Band D | EPC Rating B

Emsleys | estate agents

***IMPRESSIVE FAMILY HOME. SIMPLY STUNNING MODERN LIVING. CLOSE TO AMENITIES. ***

A stunning family home situated in the heart of Sherburn in Elmet. Built in 2022 by Wheatley Developments, the property has been finished to a high standard throughout and is situated close to local amenities. Additional benefits include privacy screening on the windows, acoustic insulation and is set up for EV charging. The internal accommodation briefly comprises to the ground floor; an entrance hall with stairs rising to the first floor, a downstairs WC, a versatile study room, a modern open plan kitchen/diner/family room fitted with a range of wall and base units with Quartz worksurfaces as well as a variety of built in appliances with French doors leading onto the rear garden and a lounge positioned to the rear of the property.

To the first floor there is a beautiful feature central landing, three well double bedrooms with the master benefitting from an en suite shower room. There is also a lovely family bathroom fitted with a four piece suite comprising a bath, shower, WC and hand wash basin.

Externally to the rear is an enclosed garden with a patio area that is equipped with electric sockets, ideal for an electric heater under the large pergola, perfect for alfresco dining all year round. There is also parking for two cars plus an additional shared visitor space.





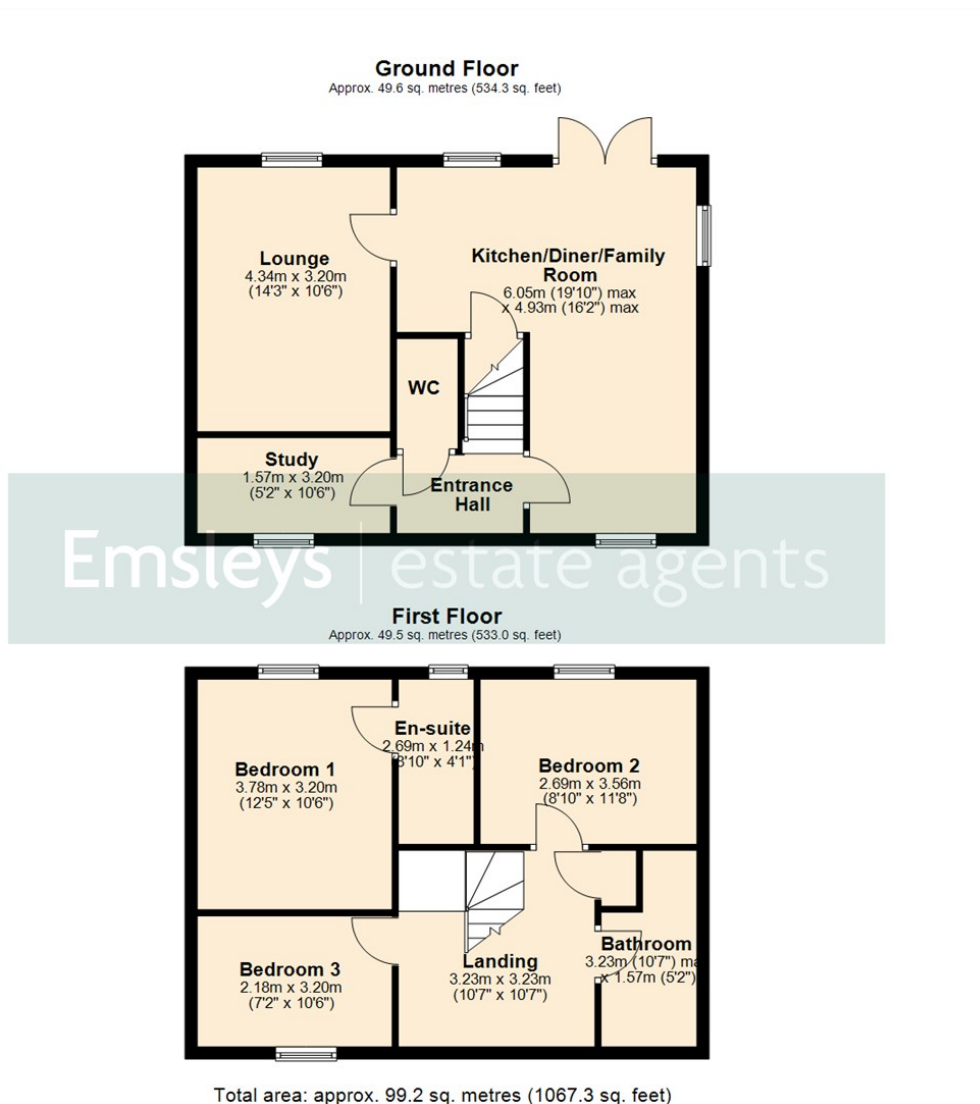

These details are for guidance only and complete accuracy cannot be guaranteed. If there is any point, which is of particular importance, verification should be obtained. They do not constitute a contract or part of a contract. All measurements are approximate. No guarantee can be given with regard to planning permissions or fitness for purpose. No apparatus, equipment, fixture or fitting has been tested. Items shown in photographs are NOT necessarily included. Interested Parties are advised to check availability and make an appointment to view before travelling to see a property.



4 Wolsey Parade | Sherburn In Elmet | Leeds | LS25 6BQ
t: 01977 680088 www.emsleysestateagents.co.uk

Emsleys | estate agents