



Woodland Crescent | Rothwell | LS26 0PJ

£195,000

Two bedroom terrace | Council Tax Band A | EPC Rating D

Emsleys | estate agents

*****MODERN FITTED KITCHEN/DINER. GARDEN. CLOSE TO AMENITIES. IDEAL FIRST TIME BUYER OPPORTUNITY.*****

Set in the charming area of Woodland Crescent in Rothwell, Leeds, this delightful mid-terrace house offers a perfect blend of comfort and convenience. With two well-proportioned bedrooms, this property is ideal for small families, couples, or individuals seeking a peaceful retreat.

Upon entering, you are welcomed into a cosy reception room that provides a warm and inviting atmosphere, perfect for relaxation or entertaining guests. A stunning updated fitted kitchen/diner completes the lovely ground floor space. The layout of the home is thoughtfully designed, ensuring that every space is utilised effectively.

The property boasts a modern bathroom, which is both functional and stylish, catering to all your daily needs. The home is complemented by an additional enclosed garden adjacent to the rear patio garden, providing a private outdoor space for gardening, al fresco dining, or simply enjoying the fresh air.

Situated in a friendly neighbourhood, this home is conveniently located near local amenities, schools, and parks, making it an excellent choice for those who appreciate community living.

This mid-terrace house on Woodland Crescent is not just a property; it is a place where memories can be made. Whether you are looking to buy or rent, this charming home is ready to welcome you. Call now to arrange your viewing.





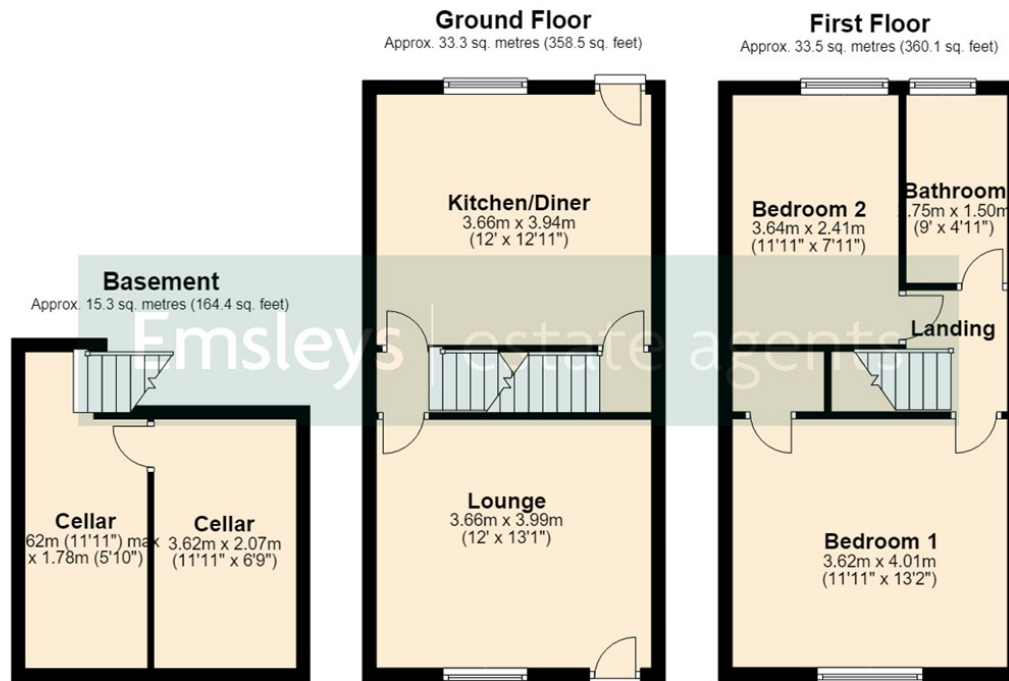

Total area: approx. 82.0 sq. metres (883.0 sq. feet)

These details are for guidance only and complete accuracy cannot be guaranteed. If there is any point, which is of particular importance, verification should be obtained. They do not constitute a contract or part of a contract. All measurements are approximate. No guarantee can be given with regard to planning permissions or fitness for purpose. No apparatus, equipment, fixture or fitting has been tested. Items shown in photographs are NOT necessarily included. Interested Parties are advised to check availability and make an appointment to view before travelling to see a property.



65 Commercial Street | Rothwell | Leeds | LS26 0QD
t: 0113 201 4040 www.emsleysestateagents.co.uk

Emsleys | estate agents