



Brayton Garth | | LS14 5HB

£170,000

Three Bedroom Mid Terrace | Council Tax Band A | EPC Rating E

Emsleys | estate agents

***** THREE BEDROOM MID-TERRACE * IDEAL FOR FIRST TIME BUYERS *****

This property is ideally suited for first-time buyers seeking a beautiful starter home or investors desirably looking for a property in a prime area. With a total of three generously proportioned bedrooms, all with double dimensions, the house is spacious and accommodating.

The house features a ground floor w.c., lounge, separate dining room with large windows that invite a cascade of natural light into the rooms, creating an inviting ambience. There is a kitchen ready to cater to all of your culinary needs. The property features bathroom with shower.

The garden is a real highlight - ideal for summer BBQs or outdoor entertainment.

Easy access to public transport links, nearby schools and local amenities reflect the property's convenient location. Ideal for commuters requiring access to Leeds, Wetherby and York, with main arterial roads providing access to surrounding districts and motorway networks, including the A64 York Road.

***** Call now to arrange your viewing *****

This property is a non standard construction known locally as a 'Parkwall'. Applicants should notify their mortgage provider before completing an application.





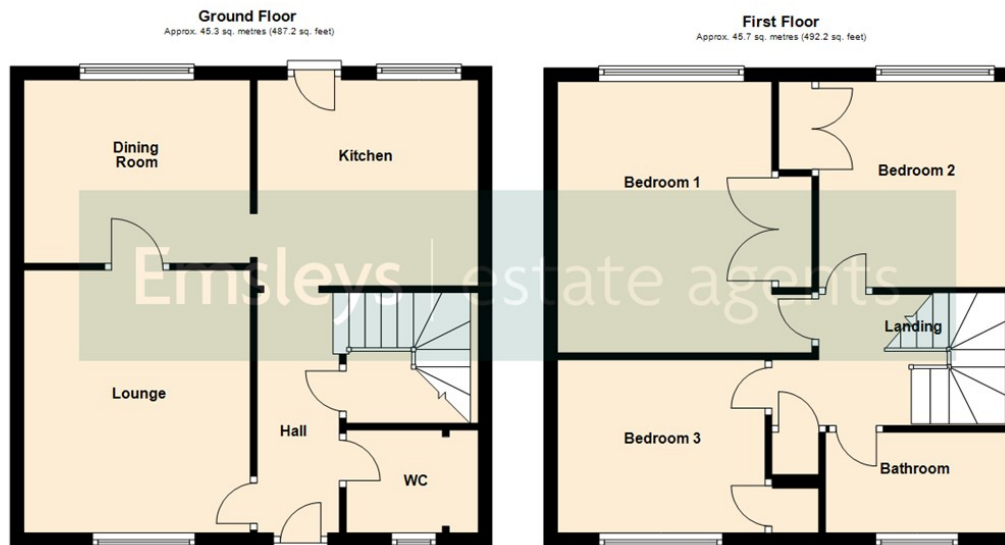

Ground Floor
Approx. 45.3 sq. metres (487.2 sq. feet)

First Floor
Approx. 45.7 sq. metres (492.2 sq. feet)

Total area: approx. 91.0 sq. metres (979.4 sq. feet)

These details are for guidance only and complete accuracy cannot be guaranteed. If there is any point, which is of particular importance, verification should be obtained. They do not constitute a contract or part of a contract. All measurements are approximate. No guarantee can be given with regard to planning permissions or fitness for purpose. No apparatus, equipment, fixture or fitting has been tested. Items shown in photographs are NOT necessarily included. Interested Parties are advised to check availability and make an appointment to view before travelling to see a property.

35 Austhorpe Road | Crossgates | Leeds | LS15 8BA
t: 0113 284 0120 | www.emsleysestateagents.co.uk

Emsleys | estate agents