



Sandgate Drive | Kippax | LS25 7QW

£460,000

Three/Four Bedroom Detached Bungalow | Council Tax Band E | EPC Rating C

Emsleys | estate agents

* STONE BUILT THREE/FOUR BEDROOM DETACHED BUNGALOW * 0.28 ACRE PLOT * SPACIOUS ACCOMMODATION - STUNNING CONDITION * DOUBLE GARAGE & OFF ROAD PARKING FOR MULTIPLE CARS *

Delightful detached bungalow, offering a perfect blend of comfort and space. Set on a generous and stunning 0.28-acre plot, this stone-built residence boasts three well-proportioned bedrooms, with the potential for a fourth bedroom in the dining room, making it an ideal choice for families or those seeking extra space.

Upon entering, you are greeted into the heart of the home - the spacious dining kitchen. The kitchen features a range-style cooker that will delight any culinary enthusiast. The layout is designed for both functionality and warmth, ensuring that family gatherings and dinner parties are a pleasure. There are two inviting reception rooms, the dining room with a feature casement window and a large lounge with bi-folding doors that look out into the manicured garden.

The property is complemented by a large modern bathroom with a five piece suite, offering both a walk in shower area and a free standing bath. There are three generous bedrooms - a larger than average master bedroom and an en-suite WC to bedroom three. Outside, there is a detached garage with an electric door, and off road parking for multiple vehicles, which is a rare find in this area. The well-maintained mature gardens surrounding the bungalow provide a private outlook to the rear, creating a tranquil retreat. The gardens are beautifully stocked and well planned, with an addition of a paved patio area and a charming summerhouse, perfect for enjoying the outdoors during the warmer months.

This bungalow is not just a home; it is a lifestyle choice, offering generous accommodation in a peaceful setting. With its excellent location and pristine condition, it presents a wonderful opportunity for those looking to settle in a friendly community.!





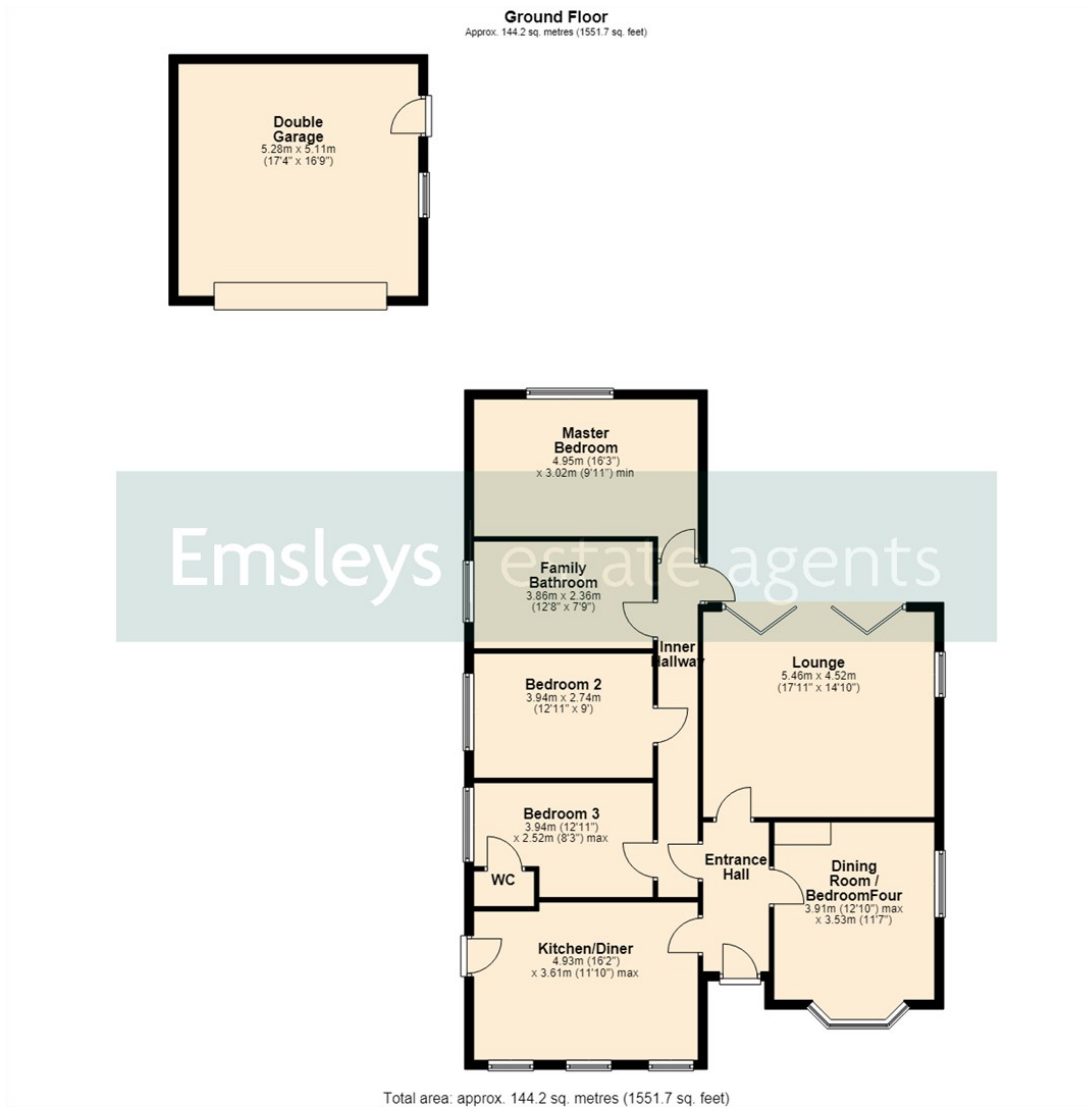

Emsleys estate agents



These details are for guidance only and complete accuracy cannot be guaranteed. If there is any point, which is of particular importance, verification should be obtained. They do not constitute a contract or part of a contract. All measurements are approximate. No guarantee can be given with regard to planning permissions or fitness for purpose. No apparatus, equipment, fixture or fitting has been tested. Items shown in photographs are NOT necessarily included. Interested Parties are advised to check availability and make an appointment to view before travelling to see a property.

6 Main Street | Garforth | Leeds | LS25 1EZ
t: 0113 286 4000 www.emsleysestateagents.co.uk

Emsleys | estate agents