

FLOOR PLAN

DIMENSIONS

- Porch
- Entrance Hall
- Lounge
14' x 17'06 (4.27m x 5.33m)
- Conservatory
7'01 x 10'07 (2.16m x 3.23m)
- Dining Kitchen
16'06 x 12' (5.03m x 3.66m)
- Utility Cupboard
4'06 x 4'01 (1.37m x 1.24m)
- Bedroom One
15' x 12'02 (4.57m x 3.71m)
- Bedroom Two
15' x 10' (4.57m x 3.05m)
- Bedroom Three
9'02 x 10'02 (2.79m x 3.10m)
- Bathroom
51 x 8'07 (15.54m x 2.62m)
- Separate WC
2'07 x 8'07 (0.79m x 2.62m)

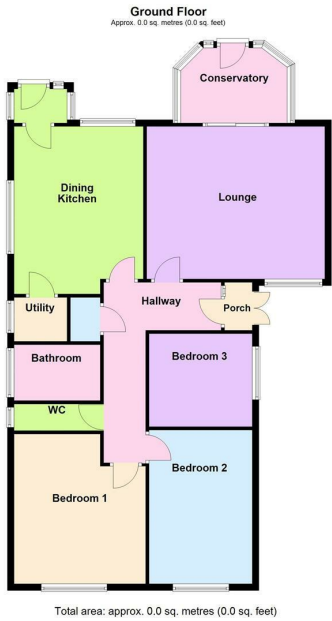

OVERVIEW

- Deceptively Spacious Detached Bungalow
- Generous Plot In Lovely Location
- Porch & Entrance Hall
- Lounge & Conservatory
- Dining Kitchen & Utility
- Three Bedrooms
- Bathroom & Separate WC
- Driveway, Garage & Fabulous Garden
- Viewing Is A Must
- EER - tbc, Freehold, Tax Band - D

LOCATION LOCATION....

Nestled amidst green spaces and parks, Glen Parva offers a peaceful retreat from the hustle and bustle of city life while remaining well-connected to urban conveniences. Residents enjoy easy access to local shops, supermarkets, and eateries, ensuring everyday needs are met within close proximity. The area is characterised by its family-friendly environment, with excellent schools and recreational facilities nearby. Picturesque walking paths and nature trails provide opportunities for outdoor exploration and leisure activities, making Glen Parva an ideal location for nature enthusiasts and active individuals alike.

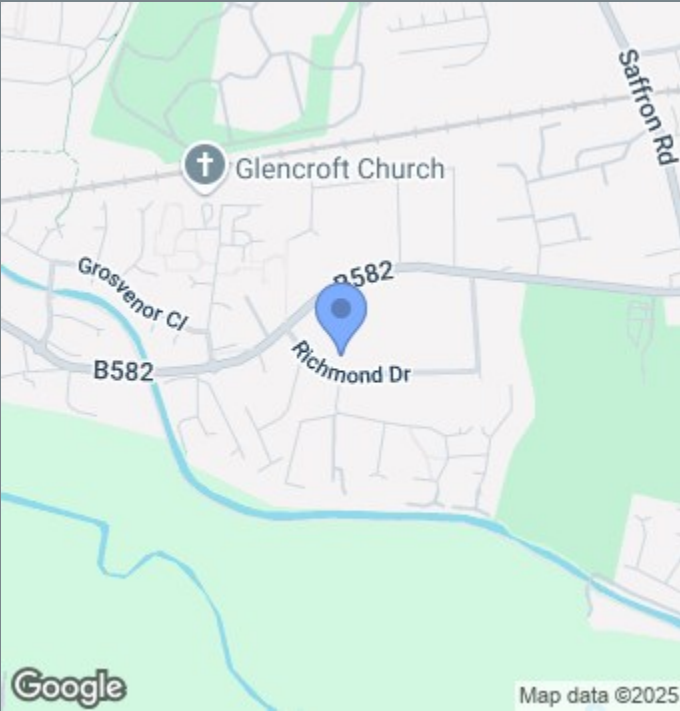

THE INSIDE STORY

Nestled in a highly sought-after and tranquil location, this charming detached bungalow is a true hidden treasure. Tucked away behind a sweeping drive-in, drive-out driveway, the property immediately impresses with its kerb appeal and generous footprint. Step through the welcoming porch into a light-filled entrance hall, where the warmth of this delightful home begins to unfold. The lounge is an elegant retreat, featuring a striking feature fireplace making it perfect for curling up on cooler evenings and has patio doors that open seamlessly into a bright conservatory, inviting the garden in and creating a wonderful space for relaxing or entertaining year-round. The heart of the home is the generously sized dining kitchen, boasting classic wooden wall and base units, plenty of counter space, and ample room for a large dining table and chairs. A door leads into the garden, making al fresco dining and summer barbecues a breeze. The adjoining utility room provides valuable extra space for laundry and storage. There are three well-proportioned bedrooms, with Bedrooms One and Two benefitting from fitted wardrobes for effortless organisation. The family bathroom is a sanctuary of relaxation, featuring a luxurious spa bath, a separate shower cubicle, and a modern vanity sink unit. A separate WC adds further convenience. Outside, the property truly shines. The extensive, well-established garden is a haven of tranquillity, offering a wealth of mature trees, vibrant borders, and sweeping lawns. A charming patio area is perfect for outdoor entertaining, while the dedicated vegetable and fruit plot invites green-fingered enthusiasts to grow their own. A delightful summer house offers an idyllic spot to unwind with a book or glass of wine, surrounded by nature. A detached garage and the spacious driveway provide plenty of parking and storage options.

