

Milestone

RESIDENTIAL

CELEBRATING 125 YEARS

22 Church Road, Ashford, TW15 2UY

T: 01784 800322

E: enquiries@milestone-residential.com

Coniston Court Cumberland Road, Ashford, TW15 3DR



Asking Price £312,500 Leasehold



A most impressive and spacious 2 double bedroom modern purpose-built apartment on first floor of this attractive development with the advantage of 2 bathrooms and entry phone system with communal grounds and allocated parking. Long lease with low outgoings.

Coniston Court Cumberland Road, Ashford, TW15 3DR

FOR SALE

A viewing is highly recommended to appreciate this excellent first floor flat with entry phone system and allocated parking. Features include a spacious communal entrance hall with stairway to the first floor. The properties generous entrance hall has access off to 2 double bedrooms (the master with en suite facilities) second bathroom and large double aspect living room having an open plan modern kitchen with breakfast bar. A fine opportunity to buy an impressive home or rental investment.

LOCATION

Quietly situated just a few minutes' walk to Ashford station and town centre. Staines shopping centre and Sunbury are also hand together the Heathrow airport and Ashford Hospital. The M25 and M3 motorways are just minutes' drive away.

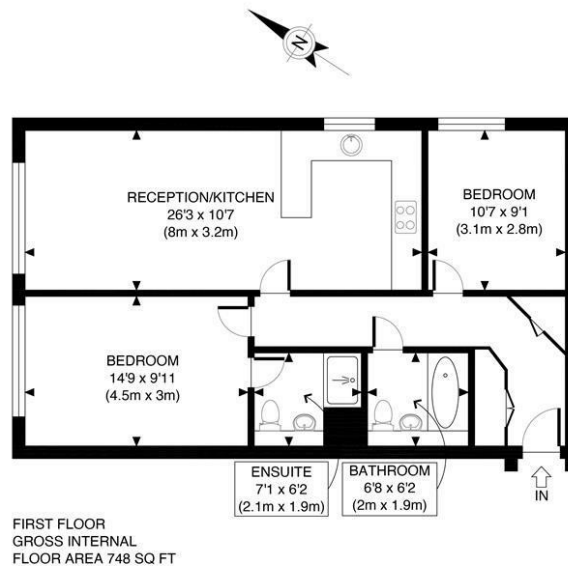

APPROX. GROSS INTERNAL FLOOR AREA 748 SQ FT / 69 SQM	Coniston Court
Disclaimer: Floor plan measurements are approximate and are for illustrative purposes only. While we do not doubt the floor plan accuracy and completeness, you or your advisors should conduct a careful, independent investigation of the property in respect of monetary valuation	date 16/03/23
	photoplan

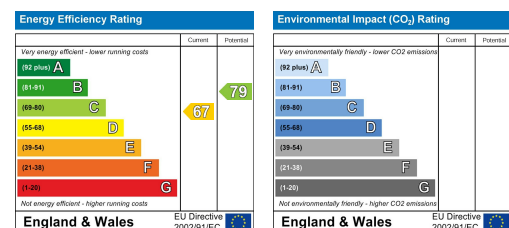

It is our aim to provide particulars that are both accurate and reliable but they are not guaranteed and would not form part of any offer or contract. Please contact us if you require clarification and we would be happy to assist. Please also note that the appliances and heating system have not been tested and therefore, no warranties can be given as to their condition.