

**24 Fairholme Road, Ashford, London TW15 2LH**



**Asking Price £310,000 Leasehold**



**A spacious 2 double bedroom ground floor maisonette with private, sunny aspect garden and garage. Located in a desirable residential road just a short walk to the town centre. Long lease with low outgoings.**



24 Fairholme Road, Ashford, London TW15 2LH

For Sale:

A Splendid ground floor purpose built maisonette providing 2 double bedrooms, spacious lounge with access to a delightful private garden. Double aspect dated kitchen and bathroom with white suite. Having the added advantage of front garden, double glazing, gas central heating and a garage. Long lease with low outgoings with no forward chain.

Location:

Quietly situated in a desirable residential road within a short walk of Ashford town centre and station, with local bus routes close to hand to Staines, Sunbury and Heathrow Airport, with access to the M3 and M25 motorways.

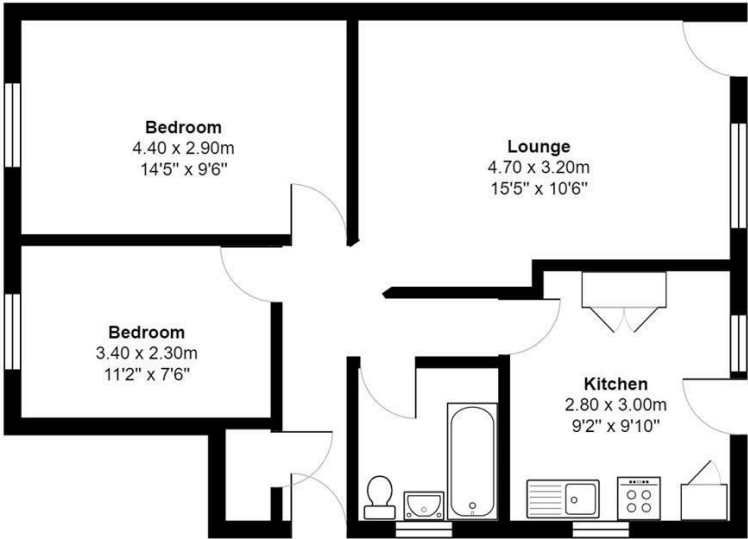

Total Area: 58.0 m<sup>2</sup> ... 624 ft<sup>2</sup>

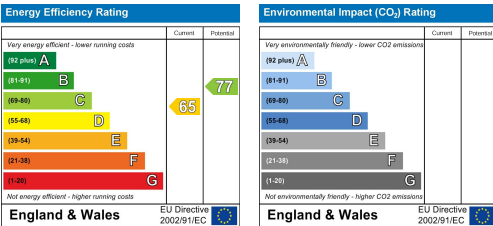

It is our aim to provide particulars that are both accurate and reliable but they are not guaranteed and would not form part of any offer or contract. Please contact us if you require clarification and we would be happy to assist. Please also note that the appliances and heating system have not been tested and therefore, no warranties can be given as to their condition.