

7 Woodlawn Crescent, Whitton, Middlesex TW2 6BB



Asking Price £599,950 Freehold



A UNIQUE OPPORTUNITY TO ACQUIRE A BEAUTIFULLY PRESENTED, CLEVERLY EXTENDED THREE BEDROOM SEMI DETACHED CHALET BUNGALOW IDEALLY SITUATED ON THIS REQUESTED RESIDENTIAL ROAD WITHIN 1/2 MILE OF WHITTON HIGH STREET AND STATION.

7 Woodlawn Crescent, Whitton, Middlesex TW2 6BB

FOR SALE:

This lovely family home has been much improved by the current sellers and features two delightful open plan reception rooms with the living room having a feature wood burning stove. The dining room is a stunning room with vaulted ceiling and bi fold doors leading to the garden. There is a well fitted kitchen and separate utility room. The receiving hall is particularly spacious and leads into an inner hall/study. There are also two good size bedrooms (one with fitted wardrobes and one with walk in dressing area and fitted cupboards). There is also a stylish downstairs shower/wc with four piece suite. Upstairs the loft has been converted to provide an additional good size double bedroom with ensuite shower/wc. Outside the front garden has been paved and provides ample off road parking. with the rear garden being well secluded and comprising a patio area, lawn and two timber sheds. An early viewing is highly recommended to appreciate the space, style and character of this fine home.

LOCATION:

Woodlawn Crescent is a quiet, requested residential road comprising similar style bungalows conveniently situated within 1/2 mile of Whitton High Street and railway station. Local buses are on hand to provide easy access into Twickenham as well as road links to the M3/M25 corridor.

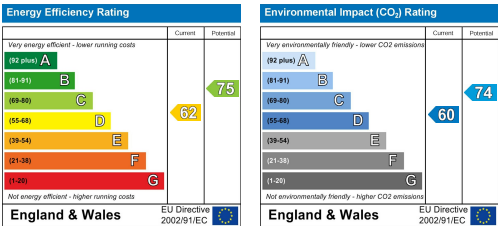
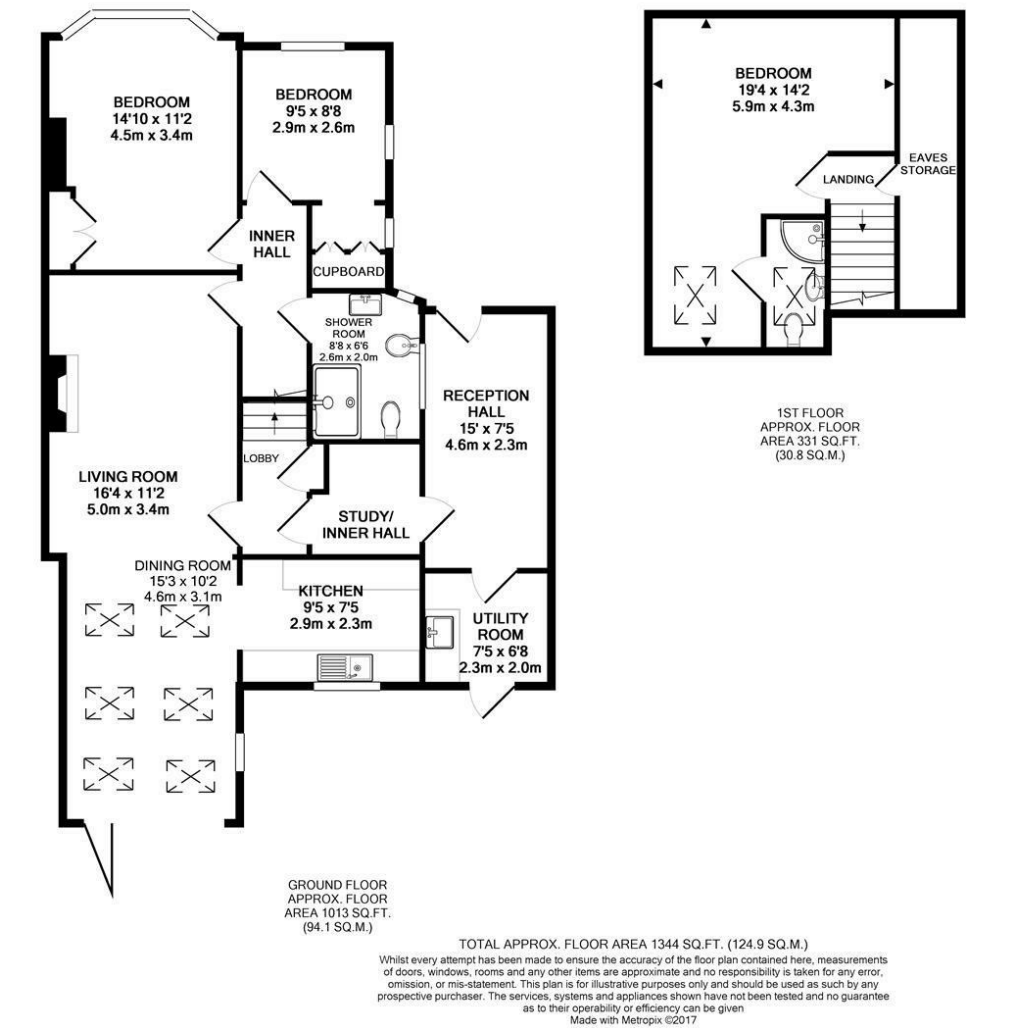

It is our aim to provide particulars that are both accurate and reliable but they are not guaranteed and would not form part of any offer or contract. Please contact us if you require clarification and we would be happy to assist. Please also note that the appliances and heating system have not been tested and therefore, no warranties can be given as to their condition.