

**22 Montrose Avenue, Whitton, Middlesex TW2 6HB**



**Asking Price £649,950 Freehold**



**A SUBSTANTIAL THREE BEDROOM, SEMI DETACHED FAMILY HOME, IDEALLY SITUATED IN ONE OF WHITTON'S MOST REQUESTED RESIDENTIAL ROADS, OFFERED FOR SALE WITH GREAT POTENTIAL TO EXTEND AND REMODEL AT A REALISTIC ASKING PRICE.**



22 Montrose Avenue, Whitton, Middlesex TW2 6HB

FOR SALE:

THIS BRIGHT & AIRY, THREE BEDROOM, SEMI DETACHED FAMILY HOME OFFERS GREAT SCOPE AND POTENTIAL TO FURTHER EXTEND TO CREATE A SUBSTANTIAL FAMILY HOME ( SUBJECT TO USUAL PLANNING CONSENTS). FEATURES INCLUDE TWO GOOD SIZE, SEPARATE RECEPTION ROOMS, FITTED KITCHEN AND UPSTAIRS, THREE WELL PROPORTIONED BEDROOMS, FAMILY BATHROOM & SEPARATE WC. Outside there is a front garden providing off road parking which leads to an attached garage and the rear garden which is laid mainly to lawn, with flower and shrub borders. An early viewing is highly recommended to appreciate this property which is offered for sale at a competitive asking price.

LOCATION:

Montrose Avenue is a requested residential road ideally situated approximately 100 yards from Whitton High Street with its busy shops cafes and railway station. Twickenham town center with its more comprehensive facilities is also close to hand.

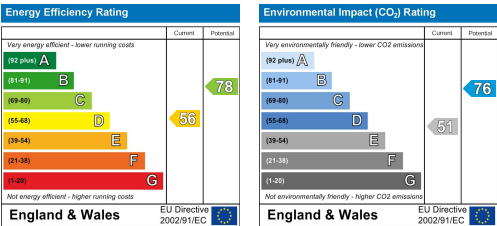
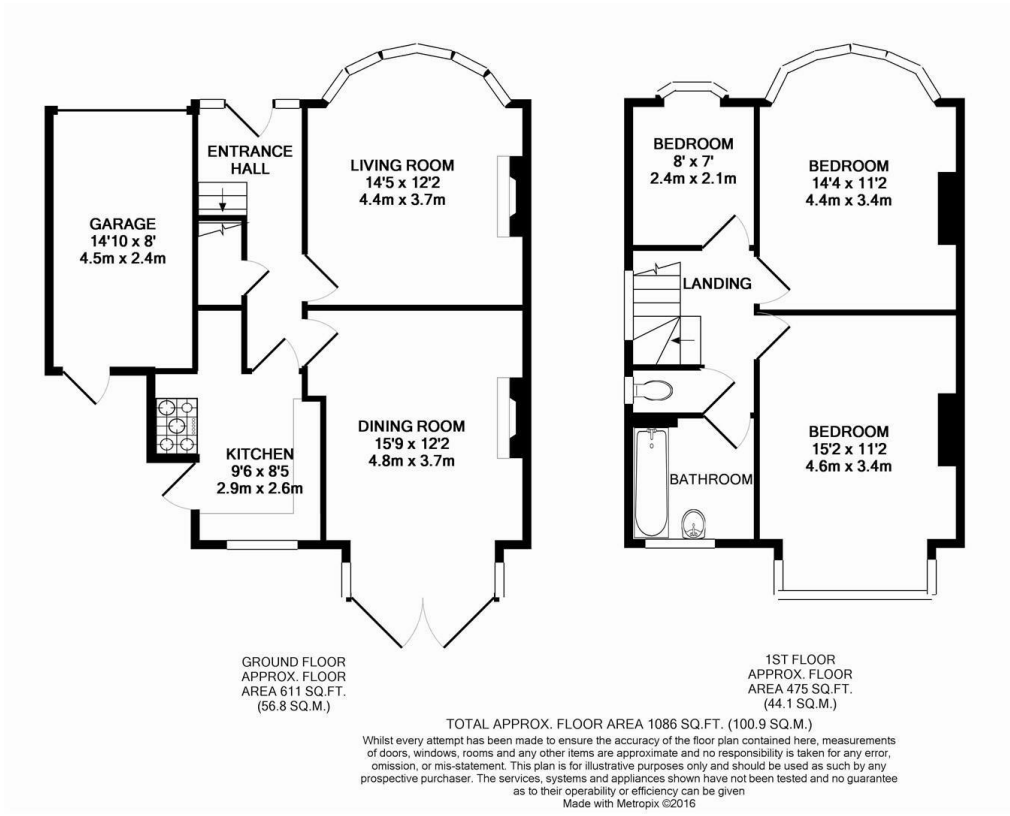

It is our aim to provide particulars that are both accurate and reliable but they are not guaranteed and would not form part of any offer or contract. Please contact us if you require clarification and we would be happy to assist. Please also note that the appliances and heating system have not been tested and therefore, no warranties can be given as to their condition.