



Fonthill Road, Hove, Sussex, BN3 6HD

Asking Price £240,000

mishon
welton

like this?

See more online at
mishonwelton.co.uk



Asking Price £240,000

- Top Floor Apartment
- One Double Bedroom
- Light And Airy Throughout
- Beautifully Presented
- Lovely Elevated Views
- Close To Hove Station
- 3D TOUR AVAILABLE
- MUST BE VIEWED

Description

3D TOUR AVAILABLE ONLINE

This lovely one bedroom apartment, is tucked away on the top floor of this attractive period building. With an appealing "split level" layout, the property provides light and airy living space, while enjoying some fine elevated views at the rear towards Hove Park and over the surrounding area.

This apartment would make an ideal first time purchase and will be of particular interest to commuters, being within close proximity of Hove mainline station.

Church Road with it's extensive range of bars and restaurants is within a quarter of a mile and the lovely Hove Park is also close by.

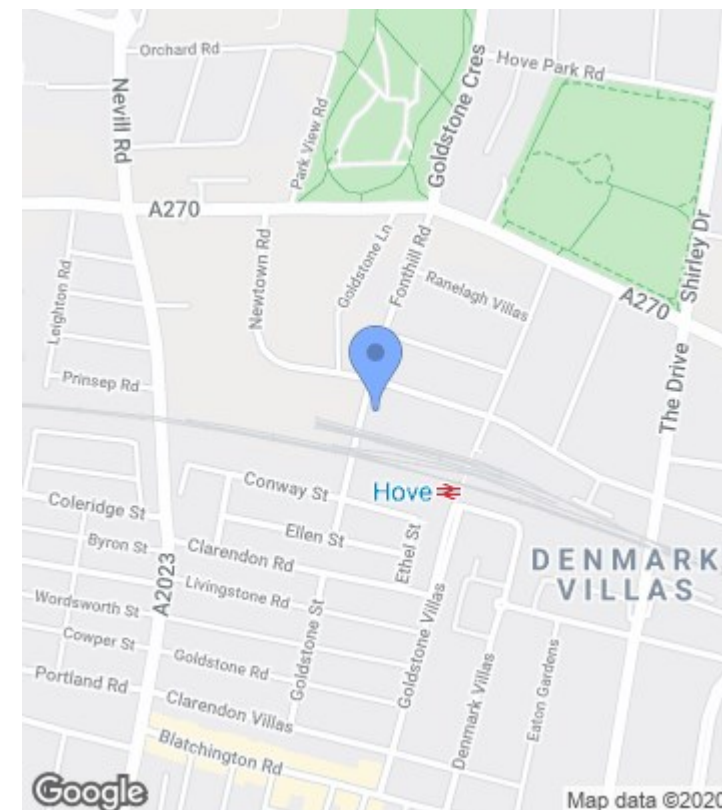

Area

Hove station is just a short walk away from your doorstep as is Church Road with it's extensive range of bars and restaurants is within a quarter of a mile and the lovely Hove Park close by.



Fonthill Road, Hove

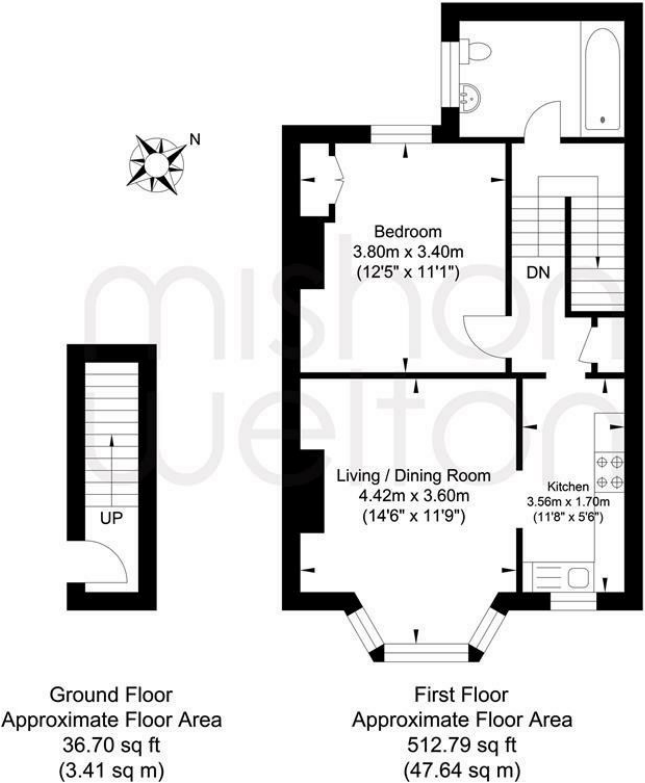

Approximate Gross Internal Area = 51.05 sq m / 549.49 sq ft
Illustration for identification purposed only, measurements are approximate, not to scale.
Copyright GDImpact 2020

The information provided about this property does not constitute or form part of an offer or contract, nor may be it be regarded as representations. All interested parties must verify accuracy and your solicitor must verify tenure/lease information, fixtures & fittings and, where the property has been extended/converted, planning/building regulation consents. All dimensions are approximate and quoted for guidance only as are floor plans which are not to scale and their accuracy cannot be confirmed. Reference to appliances and/or services does not imply that they are necessarily in working order or fit for the purpose.

