



Selbon

Residential sales & lettings

Drovers End, Fleet,
Hampshire, GU51 2XB

Guide price £475,000 Freehold



01252 979300
Selbonproperty.co.uk

- Three Bedroom Family Home
- Kitchen/Breakfast Room
- En-Suite Shower Room & Family Room
- Corner Position In Cul-De-Sac
- Close to Local Amenities
- Living Room
- Orangery
- Garage (Part Converted to Office)
- Driveway Parking
- Close to Fleet Train Station

Selbon Estate Agents are delighted to offer to the market this three bedroom family home, ideally situated on the popular Ancells Farm development.

The property has been updated by the current owners and offers a stunning kitchen/breakfast/family room with bi-folding doors opening into a south facing rear garden.

Within the kitchen/breakfast/family room this space offers an attractive skylight giving the room plenty of natural light. The kitchen has been re-fitted to a high standard and offers a functional island with a range of appliances including double oven, induction hob, dishwasher and additional appliance space.

Access to the garden can be found through a set of bi-folding doors from the family room and just off the kitchen you will find the refitted downstairs W.C. The 19ft living room, offers a feature gas fireplace and plenty of storage.

The first floor offers three bedrooms with the main bedroom benefitting from built-in wardrobes and a refitted en-suite shower room. The first-floor accommodation is finished with the main bathroom which offers a wash basin, W.C and bath with shower overhead.

Externally the Southerly facing garden has been re-modelled by the current owners and features some attractive landscaping and planting. The garden is mainly laid to lawn with a patio area immediately to the rear and a decking area by the garage with a brick-built BBQ.

The garage has been converted to create a gym or home office with storage found at the front. The property also offers driveway parking.

Ancells Farm has a local parade of shops with a Tesco's express, hairdressers, café and a fish and chip shop all within close proximity. Also Ancells Farm has the added benefit of a local pub, bus stops, park and easy access to Fleet Pond and Fleet Train Station.









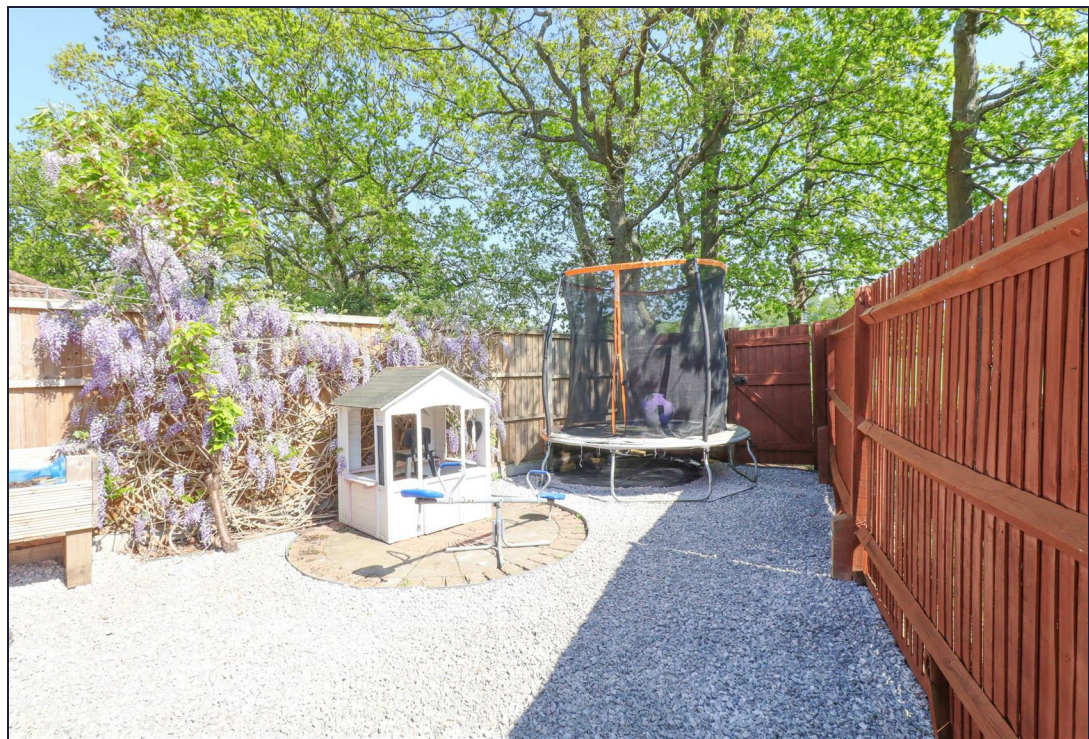



Floor Plans

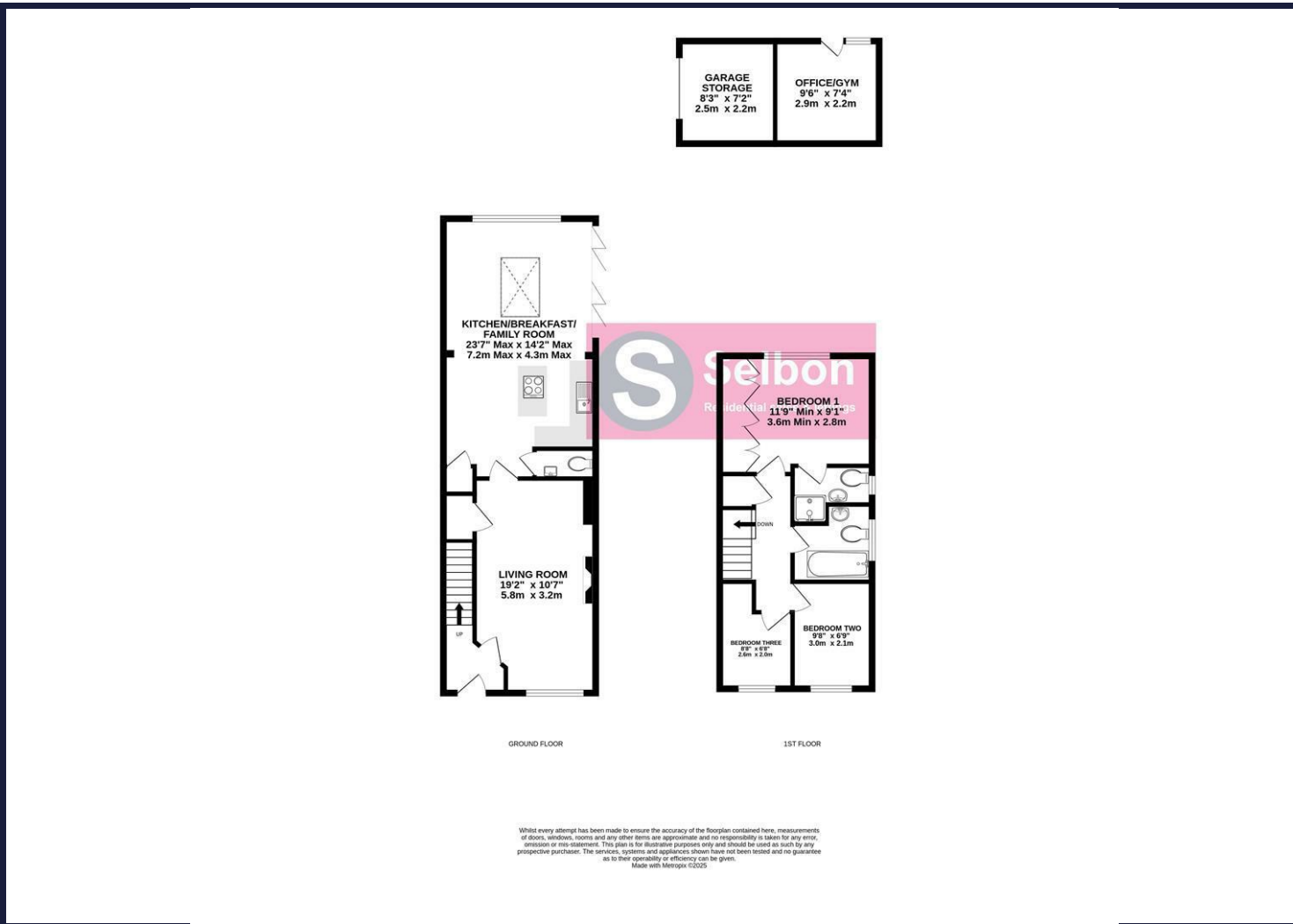

Area Map

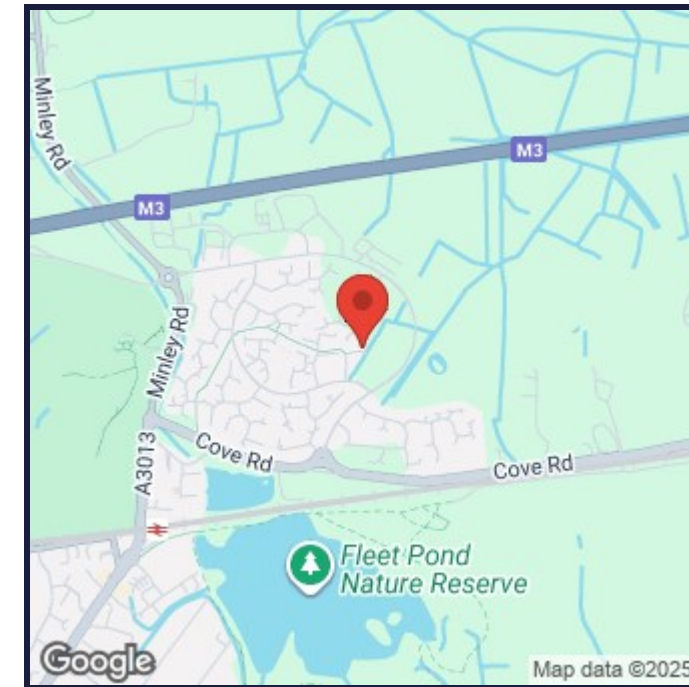

Energy Performance Graph

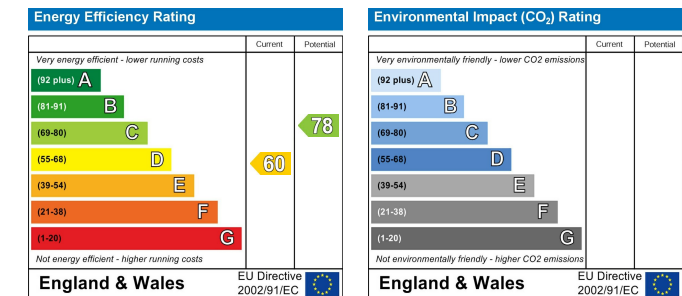

Viewing

For further information on this property or to arrange a viewing please contact Selbon Estate Agents on 01252 979300

We give notice that these particulars are produced in good faith and in accordance with the Consumer Protection from Unfair Trading Regulations 2008 (CPR). They are set out as a general guide only and do not constitute any part of a contract or warranty whatsoever. Intending purchasers should not rely on them as statements of representation of fact, but must satisfy themselves by inspection or otherwise as to their accuracy. No person in the employment of Selbon has any authority to make or give any representation or warranty whatever in relation to the property. A detailed survey has not been carried out nor have the services, heating systems, appliances or specific fittings been tested. Any photograph incorporated within these particulars shows only certain parts of the property and it must not be assumed that any contents or fixtures and fittings shown in the photographs are either included with the property or indeed remain in it. Room sizes shown and any floor plans should not be relied upon for carpets and furnishings. If there is any point which is of particular importance to you we will be pleased to check the information for you and confirm that the property remains available. This is particularly important if you are contemplating travelling some distance to view the property.

Council Tax Band: D

Selbon Property Services Ltd

Registered Office, 16 Levignen Close, Church Crookham, Fleet, Hampshire, GU52 0TW

Company Registration Number: 12108205 VAT Number: 370 7956 65

Tel: 01252 979300 Email: sales@selbonproperty.co.uk