

Ground Floor
Approx 49 sq m / 532 sq ft

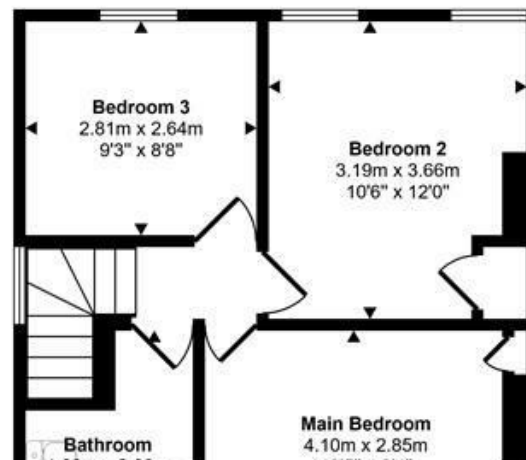

— Mor
selling an



Westfield
Sturminster Newton

Positioned on the edge of Sturminster Newton, this well-proportioned semi-detached home is a welcoming family property. Enjoying a slightly



This floorplan is only for illustrative purposes and is not to scale. Measurements of rooms, doors, windows, and any items are approximate and no responsibility is taken for any error, omission or mis-statement. Icons of items such as bathroom suites are representations only and may not look like the real items. Made with Made Snappy 360.

t. 01258 473030
sales@mortonnew.co.uk
www.mortonnew.co.uk

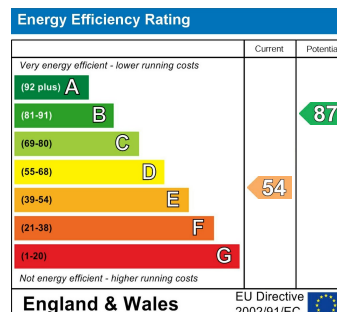

space, a good-sized garden backing onto open space, and a garage. It's a good option for a wide range of buyers.

The current owners have undertaken a programme of improvements including a new kitchen, a recent extension and general refurbishment. The property is in excellent condition and offers a great opportunity for those looking for a home with scope for personal touch. The garden is well maintained and the combination of the house and garden combine to create a truly special home.

Sturminster Newton is a thriving North Dorset town with excellent schooling and everyday amenities, as well as a wealth of leisure and Trailway. This property offers the balance of everything you need to make it well suited to families, upsizers and downsizers.

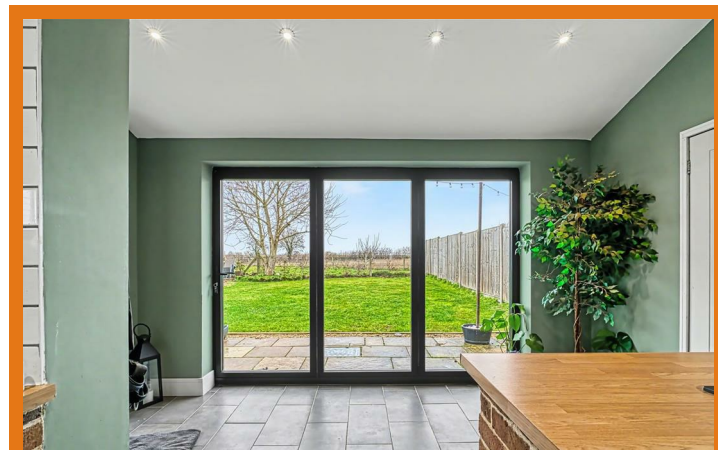

Inside

The accommodation is arranged over two floors and is well balanced, with generous room proportions throughout.

The main living spaces are bright and inviting, providing comfortable areas for everyday living and entertaining. The kitchen/dining room forms a real hub of the home and has been updated with modern gloss units, wood-effect laminate

for and p
recent im
complete

Outside

The prop
generous
front and
with the n
open field
westerly
excellent
and even



worktops and an eye-level double oven. There is ample space for a dining table, and doors open directly onto the rear garden, allowing the inside and outside to flow together naturally.

Upstairs, there are three well-sized bedrooms, all offering good natural light and flexibility for family life or home working. The family bathroom has been refurbished to a modern standard and serves all bedrooms.

Overall, the interior feels well cared

The garden
with patio
room for
landscap
to the rear
and open
to town a

There is
along with
external s
practicali

Useful In

DISCLAIMER: These particulars, whilst believed to be accurate are set out as a general statements or representation of fact, but must satisfy themselves by inspection or otherwise. Sizes should not be relied upon for carpets and furnishings. The measurements given are a property.