



£175,000

St Johns Court, Ware

St Johns Court, Ware, SG12 7SE

Keith Ian are pleased to offer this modern ground floor studio apartment situated within this popular and sought after residential development on the outskirts of Ware Town Centre. This apartment benefits from gas central heating. open plan kitchen living and sleeping area plus shower room and two allocated parking spaces one of which is under cover (carport).

Ware is located 24 miles North of Central London and within easy reach of the capital and other large towns via its many road links such as the A10 and A414.

The historic town centre offers a superb array of amenities including supermarkets, boutique shops, restaurants and public houses. The River Lee runs through the town centre with its famous Gazebo's and boasts scenic walks towards Hertford to the West and Broxbourne to the South.

The mainline station is located approximately 1 mile from the property and offers services into Liverpool Street in around 40 minutes. Other services are available from Broxbourne providing access to Stansted and Cambridge and services from Tottenham Hale across London.

STUDIO ROOM

KITCHEN

BATHROOM

CARPORT + ALLOCATED SPACE

LEASEHOLD INFORMATION

Ground rent is £199.00 per year

Service charge is £950.00 annual payment

Lease term is 88 years.

Information been provided via the vendor, please check prior to completion with your solicitor.

WHAT3WORDS

///ramp.rival.cage

COUNCIL TAX

Band B

Annual fee approx 1,562.82, 2022/2023





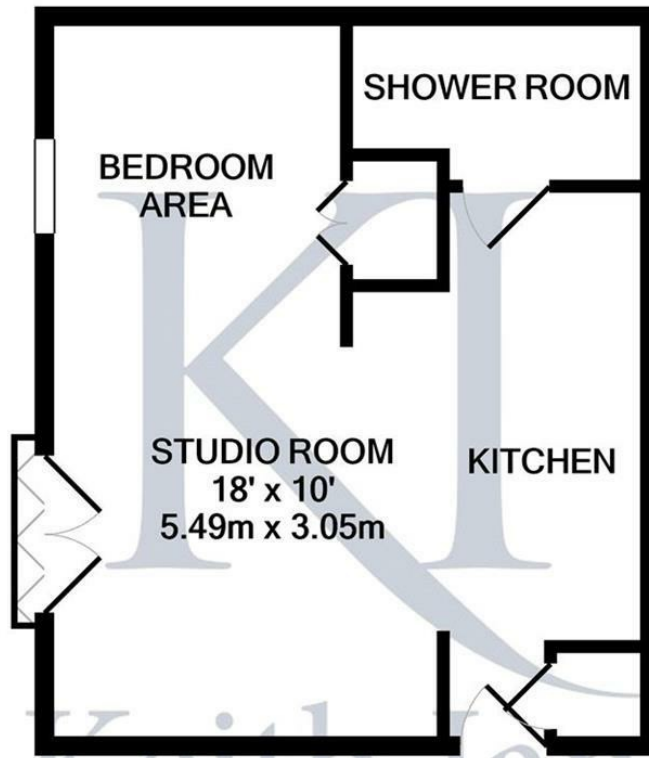

TOTAL APPROX. FLOOR AREA 278 SQ.FT. (25.8 SQ.M.)

Whilst every attempt has been made to ensure the accuracy of the floor plan contained here, measurements of doors, windows, rooms and any other items are approximate and no responsibility is taken for any error, omission, or mis-statement. This plan is for illustrative purposes only and should be used as such by any prospective purchaser. The services, systems and appliances shown have not been tested and no guarantee as to their operability or efficiency can be given
 Made with Metropix ©2022

These particulars are believed to be correct but their accuracy is not guaranteed and they do not form part of any contract. Whilst every effort is made to ensure the accuracy of these details, it should be noted that the above measurements are approximate only. Any internal photographs are intended as a guide only and it should not be assumed that any of the furniture/fittings are included in any sale. Where shown, details of lease, ground rent and service charge are provided by the vendor and their accuracy cannot be guaranteed, as the information may not have been verified and further checks should be made either through your solicitor. Where appliances, including central heating, are mentioned, it cannot be assumed that they are in working order, as they have not been tested. Please also note that wiring, plumbing and drains have not been checked.

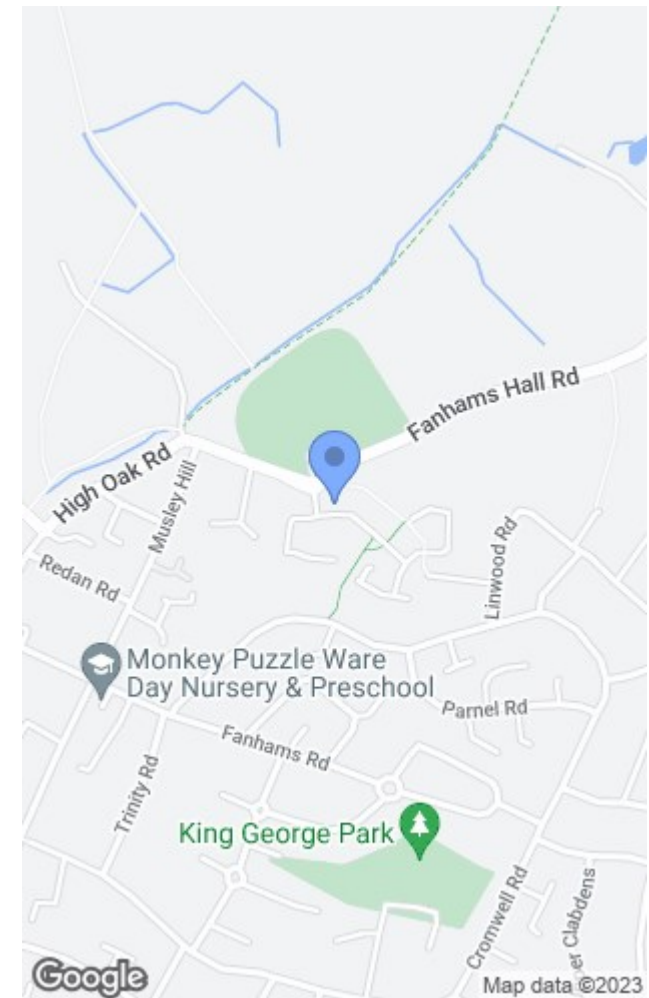

Energy Efficiency Rating		Current	Potential
Very energy efficient - lower running costs			
(92 plus) A			
(81-91) B			
(69-80) C			
(55-68) D			
(39-54) E			
(21-38) F		76	78
(1-20) G			
Not energy efficient - higher running costs			
England & Wales		EU Directive 2002/91/EC	

Environmental Impact (CO ₂) Rating		Current	Potential
Very environmentally friendly - lower CO ₂ emissions			
(92 plus) A			
(81-91) B			
(69-80) C			
(55-68) D			
(39-54) E			
(21-38) F			
(1-20) G			
Not environmentally friendly - higher CO ₂ emissions			
England & Wales		EU Directive 2002/91/EC	

T: 01920 463131
 ware@keithian.com
 www.keithian.com



Offices at Cheshunt Ware and Buntingford
 Managing Director Ian F. Robertson
 Keith Ian Ltd trading as Keith Ian Partnership. Registered in England. No. 4700202