



ESTATE AGENTS

70a, Rye Road, Hastings, TN35 5DG

Web: [www.pcmestateagents.co.uk](http://www.pcmestateagents.co.uk)  
Tel: 01424 839111

Price £370,000



PCM Estate Agents are delighted to offer to the market an opportunity to secure this THREE/ FOUR BEDROOMED DETACHED FAMILY HOME with ANNEXE located in the popular Ore region of Hastings, within close proximity to local schooling and within easy reach of Ore Village and Hastings town centre itself.

The property is well-presented throughout and offers spacious accommodation arranged over two floors. The main house comprises an entrance hallway, MODERN FITTED KITCHEN-BREAKFAST ROOM, separate LOUNGE-DINER with access onto the garden, DOWNSTAIRS WC, first floor landing, THREE GOOD SIZED BEDROOMS and a family bathroom. The additional feature of this property is its separate ANNEXE which was formerly the garage and offers a BEDROOM with EN SUITE SHOWER ROOM plus a KITCHENETTE with its own front and side doors.

Externally the property also benefits from a PRIVATE AND SECLUDED REAR GARDEN whilst to the front there is OFF ROAD PARKING for multiple vehicles. If you are looking for a SPACIOUS FAMILY HOME with ANNEXE ACCOMMODATION in this sought-after region of Hastings, look no further than this example and call the owners sole agent now to book your immediate viewing to avoid disappointment.

#### **RPRIVATE FRONT DOOR**

Leading to;

#### **SPACIOUS ENTRANCE HALLWAY**

Stairs rising to the first floor accommodation, under stairs storage cupboards, radiator, door to;

#### **KITCHEN-BREAKFAST ROOM**

12'11 x 11' (3.94m x 3.35m)

Modern and comprising a range of eye and base level units with worksurfaces over, four ring electric hob with extractor above and oven below, integrated fridge freezer, integrated dishwasher, space and plumbing for washing machine, inset sink with mixer tap, double glazed window to front aspect. Open plan to;

#### **LOUNGE-DINER**

22'3 x 11'5 narrowing to 9'11 (6.78m x 3.48m narrowing to 3.02m)

Feature fire surround, two double glazed windows to rear aspect, double doors opening up onto the garden, two radiators, wall mounted thermostat control, space for dining table and chairs, return door to hallway.

#### **DOWNSTAIRS WC**

Dual flush wc, wash hand basin, radiator, double glazed obscured window to front aspect.

#### **FIRST FLOOR LANDING**

Loft hatch.

#### **BEDROOM**

13' x 11'5 (3.96m x 3.48m)

Double glazed double doors opening up onto a balcony, double glazed window to front aspect, radiator.

#### **BALCONY**

Enclosed private balcony with artificial lawn.

#### **BEDROOM**

11'5 x 9'11 (3.48m x 3.02m)

Double glazed window to rear aspect, radiator.

#### **BEDROOM**

10'5 max x 8'11 max (3.18m max x 2.72m max)

Built in wardrobe, double glazed window to rear aspect, radiator.

#### **BATHROOM**

10'4 x 4'9 (3.15m x 1.45m)

P shaped panelled bath with mixer tap and shower attachment, shower screen, dual flush wc, wash hand basin, chrome ladder style radiator, double glazed obscured window to front aspect, inset ceiling spotlights, tiled walls, tiled flooring.

#### **ANNEXE ACCOMMODATION**

Formerly the garage.

#### **KITCHENETTE**

9'3 x 6' (2.82m x 1.83m)

Comprising a range of eye and base level units with worksurfaces, stainless steel inset sink with mixer tap, double glazed window and door to front aspect, space and plumbing for washing machine, space for fridge.

#### **BEDROOM**

14'2 x 9'5 (4.32m x 2.87m)

Double doors onto garden, double glazed window to rear aspect, radiator, loft hatch, door to;

#### **EN SUITE SHOWER ROOM**

Wc, wash hand basin, walk in shower with shower screen, double glazed obscured window to side aspect, tiled walls.

#### **REAR GARDEN**

Private and secluded with patio area ideal for seating and entertaining, featuring an area of artificial lawn, enclosed fenced boundaries.

Council Tax Band: D







GROUND FLOOR

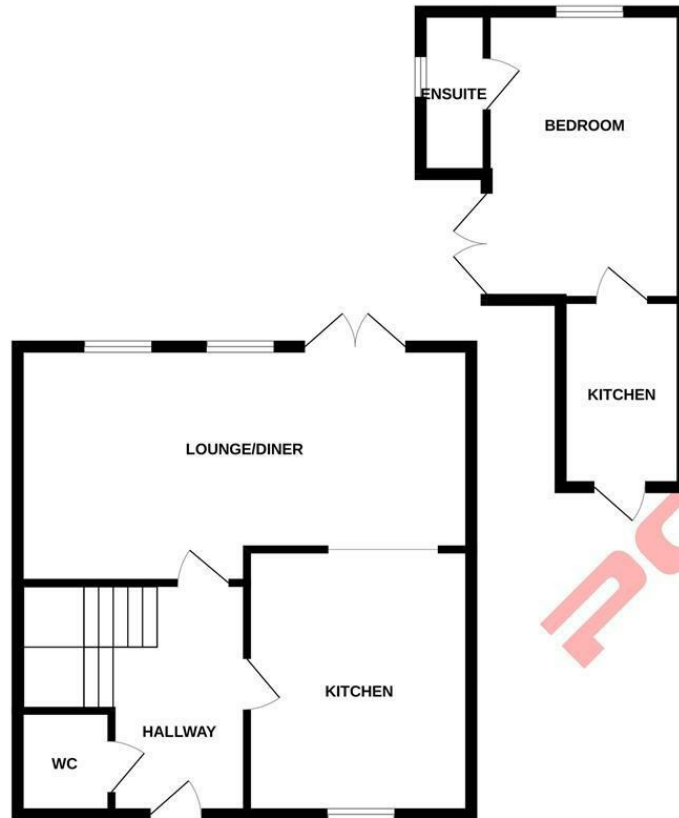

1ST FLOOR



Whilst every attempt has been made to ensure the accuracy of the floorplan contained here, measurements of doors, windows, rooms and any other items are approximate and no responsibility is taken for any error, omission or mis-statement. This plan is for illustrative purposes only and should be used as such by any prospective purchaser. The services, systems and appliances shown have not been tested and no guarantee as to their operability or efficiency can be given.  
Made with Metropix ©2023

PCM endeavour to maintain accurate depictions of properties in Floor Plans and descriptions, however, these are intended only as a guide and purchasers must satisfy themselves by personal inspection. PCM have not tested any services, appliances, equipment or facilities, and nothing in these details should be deemed to be a statement that they are in good working order or that the property is in good structural condition or otherwise.

