

Land Adjacent 22, Copper Beeches, St. Leonards-on-sea, TN37 7RR

PCM are pleased to offer an opportunity to purchase a BUILDING PLOT with permission for the erection of 4 BEDROOM DETACHED FAMILY House with integral garage. This plot is located in a particularly sought-after area of St Leonards. Further details can be found on Hastings Planning website under reference HS/FA/05/00655

Please call the owners agents now on 01424 839111 to avoid disappointment.

Council Tax Band:



GROUND FLOOR
646 sq.ft. (60.0 sq.m.) approx.

1ST FLOOR
710 sq.ft. (66.0 sq.m.) approx.

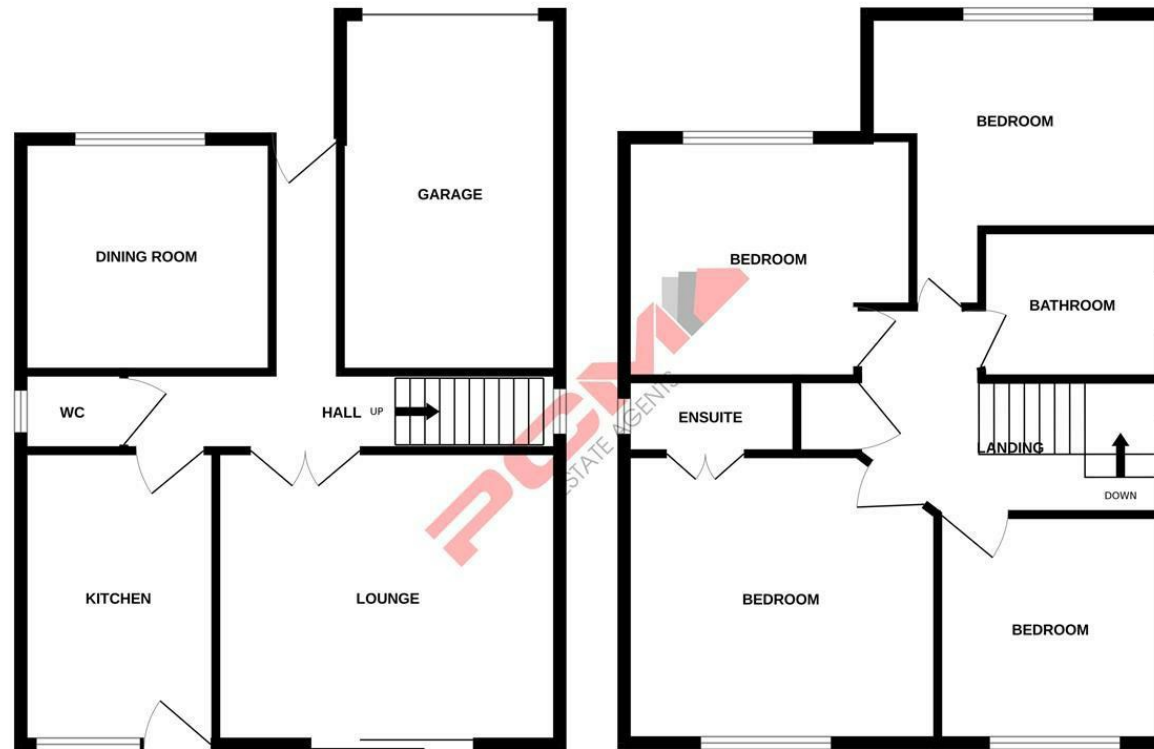

TOTAL FLOOR AREA : 1356 sq.ft. (126.0 sq.m.) approx.

Whilst every attempt has been made to ensure the accuracy of the floorplan contained here, measurements of doors, windows, rooms and any other items are approximate and no responsibility is taken for any error, omission or mis-statement. This plan is for illustrative purposes only and should be used as such by any prospective purchaser. The services, systems and appliances shown have not been tested and no guarantee as to their operability or efficiency can be given.
Made with Metropix ©2023

PCM endeavour to maintain accurate depictions of properties in Floor Plans and descriptions, however, these are intended only as a guide and purchasers must satisfy themselves by personal inspection. PCM have not tested any services, appliances, equipment or facilities, and nothing in these details should be deemed to be a statement that they are in good working order or that the property is in good structural condition or otherwise.

Energy Efficiency Rating		
	Current	Potential
Very energy efficient - lower running costs		
(92 plus) A		
(81-91) B		
(69-80) C		
(55-68) D		
(39-54) E		
(21-38) F		
(1-20) G		
Not energy efficient - higher running costs		
England & Wales	EU Directive 2002/91/EC	

Environmental Impact (CO ₂) Rating		
	Current	Potential
Very environmentally friendly - lower CO ₂ emissions		
(92 plus) A		
(81-91) B		
(69-80) C		
(55-68) D		
(39-54) E		
(21-38) F		
(1-20) G		
Not environmentally friendly - higher CO ₂ emissions		
England & Wales	EU Directive 2002/91/EC	