



ESTATE AGENTS

111, Edmund Road, Hastings, TN35 5LE

Web: www.pcmestateagents.co.uk
Tel: 01424 839111

Price £400,000

PCM Estate Agents are delighted to present to the market this THREE BEDROOM plus LOFT ROOM, VICTORIAN BAY FRONTED TERRACED HOUSE offering exceptionally well-proportioned FAMILY ACCOMMODATION arranged over three floors comprising a spacious entrance hall, BAY FRONTED LIVING ROOM with OPEN FIRE, separate DINING ROOM, large KITCHEN-BREAKFAST ROOM with access onto a utility cupboard and to the GOOD SIZED GARDEN. To the first floor there are THREE WELL-PROPORTIONED BEDROOMS in addition to a family bathroom, separate wc and EN-SUITE to the master, whilst to the second floor is a LOFT ROOM that could be used for many different purposes.

To the front of the property is an area of hard-standing with potential for off road parking subject to the planning consents to lower the kerb. The GARDEN is a GOOD SIZE and is mainly laid to lawn with a stone patio abutting the property and a section of decked patio to the rear of the garden benefitting from SEA VIEWS.

Located in the upper CLIVE VALE region of Hastings, just a short walk down into Hastings Historic Old Town and within easy reach of a number of popular schooling establishments and bus routes, within easy walking distance to amenities located within Ore, including Ore railway station.

If you are seeking an OLDER STYLE CHARACTERFUL well-proportioned FAMILY HOME in the CLIVE VALE region, please call now to arrange your viewing.

DOUBLE GLAZED FRONT DOOR

Leading to;

VESTIBULE

Wood laminate flooring , door opening to;

ENTRANCE HALL

Stairs rising to upper floor accommodation, radiator, wood laminate flooring, under stairs storage cupboard, wall mounted thermostat control for gas fired central heating, coving to ceiling, door to;

LIVING ROOM

15'8 x 13'5 (4.78m x 4.09m)

Cornicing, high ceilings, picture rail, wood laminate flooring, television point, radiator, exposed brick chimney breast with open fire, double glazed bay window to front aspect.

DINING ROOM

11'7 x 11'4 (3.53m x 3.45m)

Wood laminate flooring, radiator, high ceilings, picture rail, double glazed window to rear aspect.

KITCHEN-BREAKFAST ROOM

23'3 x 9'9 narrowing to 6'6 (7.09m x 2.97m narrowing to 1.98m)

Coving to ceiling, combination of part tiled walls and oak wood flooring, space for breakfast table, double radiator, down lights. The kitchen itself is fitted with a range of eye and base level cupboards and drawers with work surfaces over, four ring gas hob with extractor above, inset one ½ bowl drainer/ sink unit with mixer tap, space and plumbing for dishwasher, space for tall fridge freezer, four ring gas hob with cooker hood above and waist level double oven, two double glazed windows to side aspect, double glazed French doors to garden, door to;

UTILITY CUPBOARD

Space and plumbing for washing machine and tumble dryer, tiled flooring and a newly installed wall mounted Worcester Bosch combination boiler, installed in 2021.

FIRST FLOOR LANDING

Stairs rising to loft room, radiator, wood flooring, under stairs storage cupboard, door to;

BEDROOM

15'7 into bay x 13' (4.75m into bay x 3.96m)

Exposed wooden floorboards, cornicing, radiator, double glazed bay window to front aspect with lovely views extending down Edmund Road towards the East Hill and towards the sea, door to;

EN-SUITE SHOWER ROOM

Tiled walls, tiled flooring, shower enclosure with electric shower, pedestal wash hand basin with mixer tap, dual flush low level wc, ladder style heated towel rail, double glazed pattern glass window to front aspect.

BEDROOM TWO

11'9 x 10'8 (3.58m x 3.25m)

Built in cupboard, high ceilings, radiator, double glazed window to rear aspect with views over the garden.

BEDROOM THREE

11' x 10'3 (3.35m x 3.12m)

Fireplace, built in airing cupboard with immersion heater, double glazed window to rear aspect with views over the garden.

BATHROOM

Stand alone Victorian style bathtub with Victorian style mixer tap and shower attachment with shower over bath, wash hand basin, column style radiator/ heated towel rail, part tiled walls, tiled flooring, double glazed pattern glass window to side aspect.

SEPARATE WC

Low level wc, exposed floorboards, double glazed pattern glass window to front aspect.

LOFT ROOM

16'6 x 10'9 (5.03m x 3.28m)

Wood flooring, storage, radiator, Velux window to rear aspect.

FRONT GARDEN

Pathway to front door, planting beds with mature shrubs and plants, block paved hard-standing with potential for off road parking subject to the relevant planning consents to lower the kerb.

REAR GARDEN

Stone patio abutting the property and leading down the side elevation, section of lawn with a raised decked patio to the rear section of the garden having views extending towards the sea. The garden has a variety of mature plants and shrubs, ample outside space to sit out and enjoy for families.



GROUND FLOOR

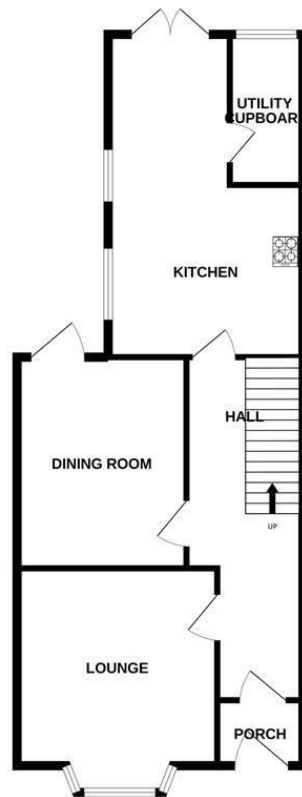

1ST FLOOR



2ND FLOOR

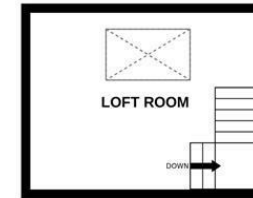

Whilst every attempt has been made to ensure the accuracy of the floorplan contained here, measurements of doors, windows, rooms and any other items are approximate and no responsibility is taken for any error, omission or mis-statement. This plan is for illustrative purposes only and should be used as such by any prospective purchaser. The services, systems and appliances shown have not been tested and no guarantee as to their operability or efficiency can be given.
Made with Metropix ©2022

PCM endeavour to maintain accurate depictions of properties in Floor Plans and descriptions, however, these are intended only as a guide and purchasers must satisfy themselves by personal inspection. PCM have not tested any services, appliances, equipment or facilities, and nothing in these details should be deemed to be a statement that they are in good working order or that the property is in good structural condition or otherwise.

