



ESTATE AGENTS

**2 Kenrith Court, St. Helens Crescent, Hastings, TN34  
2SQ**

Web: [www.pcmestateagents.co.uk](http://www.pcmestateagents.co.uk)  
Tel: 01424 839111

**Price £130,000**



PCM Estate Agents are delighted to present to market this ONE BEDROOMED LOWER GROUND FLOOR FLAT in Kenrith Court with LOVELY VIEWS OVER ALEXANDRA PARK and well thought out accommodation, restricted for the OVER 60's.

Accommodation comprises entrance hall, LOUNGE-DINING ROOM, kitchen, ONE BEDROOM and a SHOWER ROOM. The property has a OUTSTANDING VIEWS over Alexandra Park, COMMUNAL LOUNGE and COMMUNAL LAUNDRY ROOM. The property also benefits from DOUBLE GLAZING and ELECTRIC HEATING and a healthy length lease.

Located close to bus routes providing ease of access to Hastings town centre and the seafront, please call the owners agents now to book your immediate viewing to avoid disappointment.

#### **ENTRANCE HALL**

Doors leading to:

#### **LOUNGE-DINING ROOM**

16' x 9' (4.88m x 2.74m)

Double glazed window to front overlooking Alexandra Park, electric heater, electric coal effect fire, lifeline pull cord.

#### **KITCHEN**

6' x 5' (1.83m x 1.52m)

Fitted with a range of eye and base level cupboards and drawers, part tiled walls, inset stainless steel sink-drainer, space for electric cooker, extractor fan, space for fridge freezer,

#### **BEDROOM**

13' x 9' (3.96m x 2.74m)

Double glazed window to front aspect overlooking Alexandra Park, telephone point, large storage cupboard, electric heater, lifeline pull cord.

#### **SHOWER ROOM**

6' x 5' (1.83m x 1.52m)

Walk in shower with electric shower unit with seat and hand rail, low level wc, wash hand basin, tiled walls, non slip flooring, extractor for ventilation, lifeline pull cord.

#### **TENURE**

We have been advised of the following by the vendor:

Lease: Approximately 961 years remaining

Maintenance & Review Period: £1774.40 per annum/ Reviewed 31st March each year.

Ground Rent& Review Period: £308 per annum/ Reviewed 31st March each year.

#### **COMMUNAL FACILITIES**

Including lounge and laundry room.







GROUND FLOOR

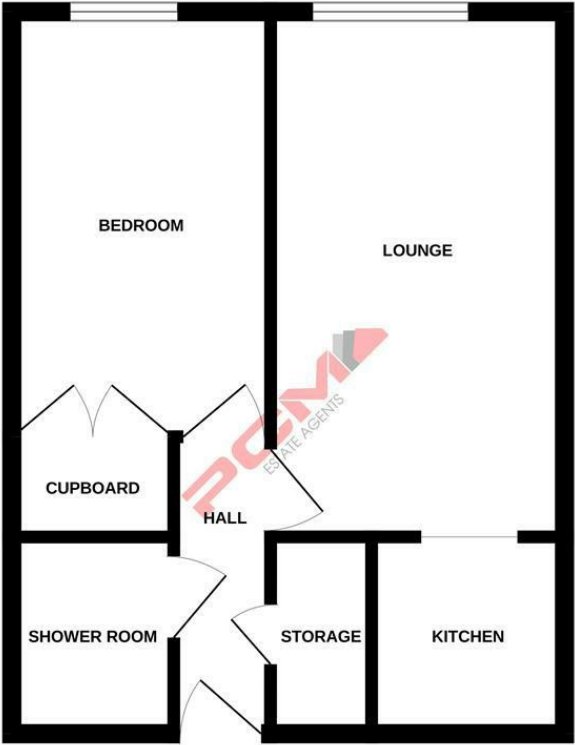

Whilst every attempt has been made to ensure the accuracy of the floorplan contained here, measurements of doors, windows, rooms and any other items are approximate and no responsibility is taken for any error, omission or mis-statement. This plan is for illustrative purposes only and should be used as such by any prospective purchaser. The services, systems and appliances shown have not been tested and no guarantee as to their operability or efficiency can be given.  
Made with Metropix ©2023

PCM endeavour to maintain accurate depictions of properties in Floor Plans and descriptions, however, these are intended only as a guide and purchasers must satisfy themselves by personal inspection. PCM have not tested any services, appliances, equipment or facilities, and nothing in these details should be deemed to be a statement that they are in good working order or that the property is in good structural condition or otherwise.

