



Harvey Clough Road, Sheffield S8 8PG

Guide Price £150,000

****Guide Price: £150,000 - £160,000 ****

Virtual Tour Available

SK Estate Agents are pleased to present - for SALE with NO ONWARD CHAIN - this well-presented and neutrally decorated, three bedroom, semi-detached property located in the highly sought after residential area of Norton Lees. Close to a host of local amenities, well served for excellent transport links to Sheffield City Centre, and within easy walking distance of both Meersbrook and Graves Park, this property would be ideally suited to first-time buyers and investors alike. The property comprises: lounge, dining kitchen, three bedrooms, shower room, and a private rear garden.

Tenure: Freehold



Entrance Hall

Entry through front-facing UPVC external door with glazed frosted top section. Having gas central heating radiator, laminate flooring, and carpeted staircase rising to the first floor.

Lounge

11'9" x 10'9" (3.60m x 3.29m)

A well-proportioned lounge having front-facing double glazed UPVC window, feature chimney breast, gas central heating radiator, and laminate flooring.

Dining Kitchen

12'2" x 8'0" (3.73m x 2.45m)

The dining kitchen has a good range of wall and base units in beech effect with contrasting roll top work surfaces incorporating stainless steel bowl and half sink with drainer and mixer tap, and four ring gas hob with electric fan assisted oven below. Having tile effect vinyl flooring, tiled splashbacks, gas central heating radiator, two rear-facing double glazed UPVC windows, and space for a washing machine, tumble dryer and dishwasher. Also housing the Worcester gas combination boiler.

A wooden door gives access into a rear entry having a large storage pantry, under-stair storage, and side-facing external wooden door.

Landing

Having loft access via hatch and carpeted flooring.

Shower Room

5'8" x 4'9" (1.74m x 1.46m)

A well-presented shower room with white three piece suite comprising; low flush WC, wash hand basin set within a vanity unit with mixer tap, and thermostatic shower. Having rear-facing obscured double glazed UPVC window, vertical heated towel rail, and tiled floor to ceiling.

Bedroom One

8'11" x 11'0" (2.72m x 3.37m)

Neutrally decorated principal bedroom having carpeted flooring, gas central heating radiator, and front-facing UPVC double glazed window.

Bedroom Two

9'3" x 8'0" (2.83m x 2.45m)

A good-sized second bedroom having gas central heating radiator, carpeted flooring, and a double glazed UPVC window with views out over the rear.

Bedroom Three

6'5" x 7'7" (1.98m x 2.33m)

Having gas central heating radiator, front-facing double glazed UPVC window, and carpeted flooring.

Outside

To the front of the property lies a paved buffer garden with shrubbery and access to rear via wooden gate.

To the rear is a private and mainly laid to lawn garden with an attractive patio area for outdoor seating.



sales • letting • property management



Website: www.skestateagents.co.uk

Email: info@skestateagents.co.uk

Address: 868 Chesterfield Road, Woodseats, Sheffield, S8 0SH

Telephone: 0114 2749730

Company No: 08028567



In accordance with the Property Misdescriptions Act (1991) we have prepared these property particulars as a general guide to a broad description of the property. They are not intended to constitute part of an offer or contract. We have not carried out a structural survey and the services, appliances and the specific fittings have not been tested. All photographs, measurements, floor plans and distances referred to are given as a guide only and should not be relied upon for the purchase of carpets or any other fixtures or fittings.

Lease details, ground rent and service charges (where applicable) are given as a guide only and should be checked by your solicitor prior to exchange of contracts. The copyright of all details, photographs and floor plans remains that of SK Estate Agents



sales • letting • property management



Website: www.skestateagents.co.uk **Email:** info@skestateagents.co.uk
Address: 868 Chesterfield Road, Woodseats, Sheffield, S8 0SH

Telephone: 0114 2749730
Company No: 08028567

Approx Gross Internal Area
56 sq m / 602 sq ft

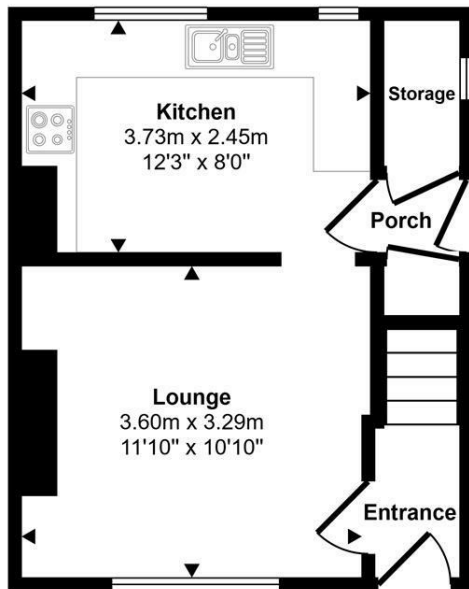

Ground Floor
Approx 28 sq m / 297 sq ft

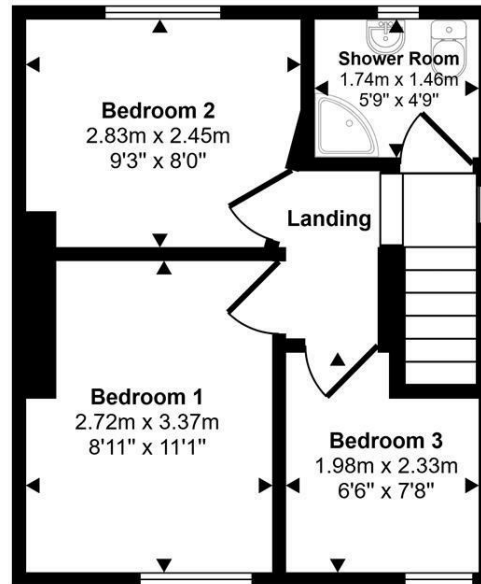

First Floor
Approx 28 sq m / 305 sq ft

This floorplan is only for illustrative purposes and is not to scale. Measurements of rooms, doors, windows, and any items are approximate and no responsibility is taken for any error, omission or mis-statement. Icons of items such as bathroom suites are representations only and may not look like the real items. Made with Made Snappy 360.

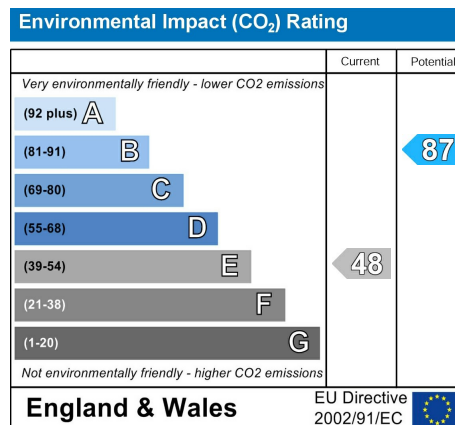
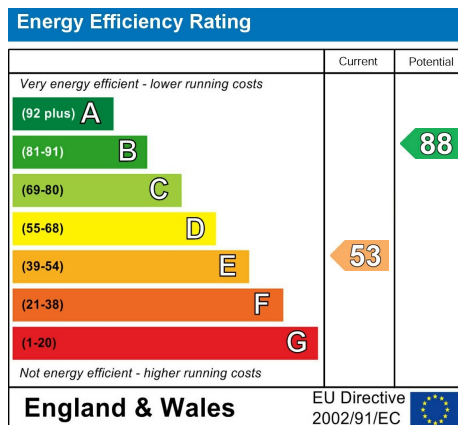

sales • letting • property management



Website: www.skestateagents.co.uk

Email: info@skestateagents.co.uk

Telephone: 0114 2749730

Address: 868 Chesterfield Road, Woodseats, Sheffield, S8 0SH

Company No: 08028567