



60 Spring Gardens, Hazel Grove, Stockport, Cheshire, SK7 4AE

mosley jarman

60 Spring Gardens, Hazel Grove, Stockport, Cheshire, SK7 4AE

£995 Per Calendar Month

- Parking - Off road parking to the front for two/three cars. Single garage
- Heating - Gas central heating
- Mains - Gas, electric, water and drainage
- EPC rating - D (63/85)
- Council Tax band - C (Stockport).
- Refuse - Stockport Council operate a chargeable garden waste disposal service. For full details please visit www.stockport.gov.uk/garden-waste
- **Flood Risk - There is a very low flood risk for this property.
- *Broadband - Openreach, and Virgin Media. You may be able to obtain broadband service from these Fixed Wireless Access providers covering your area. EE, and Three
- *Mobile - Likely coverage by EE. Limited coverage by O2, Three, and Vodafone.
- * Information provided by Ofcom checker and isn't guaranteed. Mosley Jarman take no responsibility for inaccuracies and advise potential buyers to do their own checks before committing to renting the property. ** Information provided by GOV.UK





60 Spring Gardens, Hazel Grove, Stockport, Cheshire, SK7 4AE

Per Calendar Month £995 Per Calendar Month

Enjoying a position at the top of a cul-de-sac, which is just a short walk from the centre of Hazel Grove, is this deceptively spacious mid-terrace home which would make an ideal home for couples and families alike. An internal viewing will briefly reveal a living room which leads through to a modern fitted dining kitchen. On the first floor a landing provides access to three generous sized bedrooms and a modern fitted bathroom complete with shower unit over the bath. The property is double-glazed and has gas fired central heating. There are gardens to the front and rear. UNFURNISHED. AVAILABLE: IMMEDIATELY



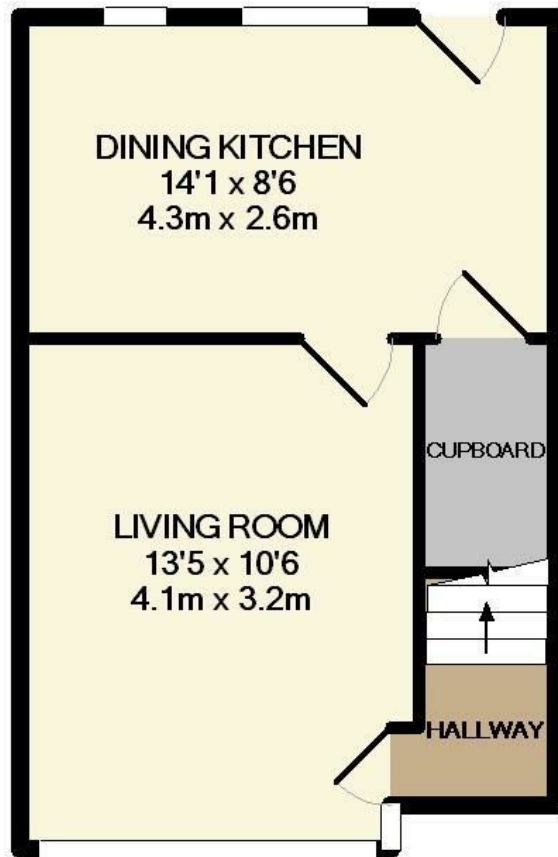

GROUND FLOOR
APPROX. FLOOR
AREA 303 SQ.FT.
(28.1 SQ.M.)

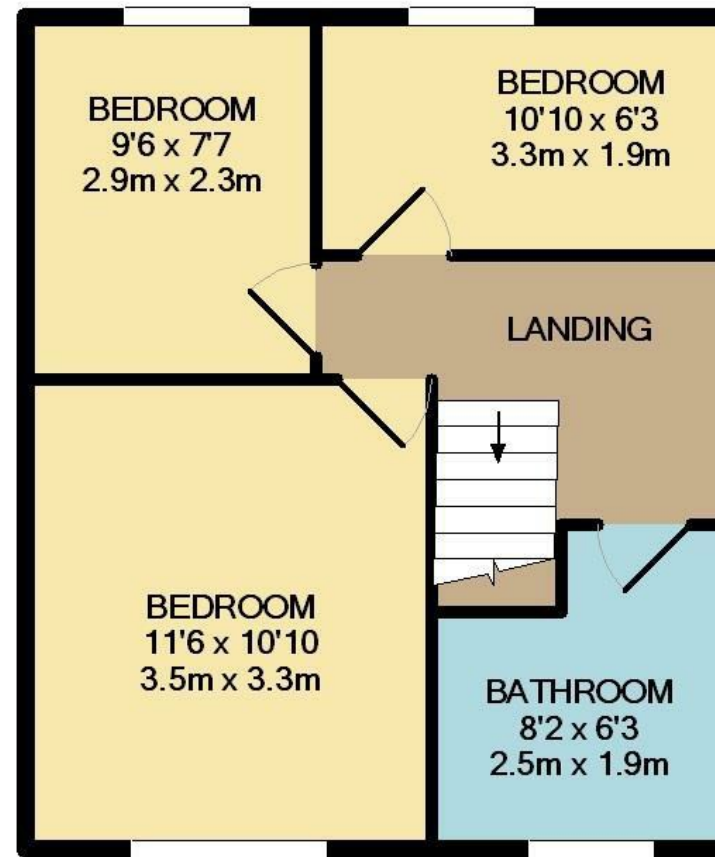

1ST FLOOR
APPROX. FLOOR
AREA 404 SQ.FT.
(37.5 SQ.M.)

TOTAL APPROX. FLOOR AREA 706 SQ.FT. (65.6 SQ.M.)

Whilst every attempt has been made to ensure the accuracy of the floor plan contained here, measurements of doors, windows, rooms and any other items are approximate and no responsibility is taken for any error, omission, or mis-statement. This plan is for illustrative purposes only and should be used as such by any prospective purchaser. The services, systems and appliances shown have not been tested and no guarantee as to their operability or efficiency can be given.
Made with Metropix ©2021