

24 Mount Pleasant
Wilmslow, SK9 4AP



mosley jarman



24 Mount Pleasant, Wilmslow, SK9 4AP

Offers Over £700,000

A beautifully presented and remodelled three double bedroom, two-bathroom 1920's detached family home situated in a quiet cul de sac only a few minutes' walk from Carrs Park, Wilmslow town centre and Wilmslow train station. The property retains a host of original features and charm including high ceilings & coving and benefits from UPVC double glazing, gas fired central heating run by a combination boiler, off road parking and landscaped garden.

The accommodation comprises a porch leading to a spacious and welcoming reception hallway with a downstairs WC, a dual-aspect living room featuring a bay window, stylish media wall, and a charming log burner. To the rear of the property is a stunning open-plan living kitchen, fitted with contemporary matching wall and base units, integrated AEG appliances including induction hob, wine fridge, and a large island breakfast bar. This space also offers a generous dining and living area with log burner and bi-fold doors opening onto the garden, creating an ideal setting for both everyday living and entertaining. A utility room completes the ground floor and has been recently upgraded with bespoke storage solutions.

To the first floor, a landing provides access to the loft via a pull-down ladder. There is potential to convert the loft into a fourth bedroom subject to planning consent. The principal bedroom suite features fitted wardrobes, ornamental fire place and a recently installed contemporary en-suite shower room, complete with a walk-in shower. There are two further well-proportioned double bedrooms, one of which benefits from fitted wardrobes and an ornamental fire place, along with a superbly refitted family bathroom finished to a high standard.



- Remodelled three double bedrooms detached family home
- Close to Carrs Park, Wilmslow town centre and Wilmslow train station
- Utility room and down stairs wc
- Two bathrooms
- Landscaped garden
- Cul de sac location
- Beautifully presented throughout
- Stunning living kitchen
- Off road parking for several cars
- Garden room



The Grounds & Gardens

To the front of the property is a driveway, extending down the side of the house, providing off-road parking for several cars. To the rear is a beautifully landscaped garden featuring a patio, lawn, dedicated BBQ area, and a composite decked terrace—ideal for outdoor entertaining. The garden is further enhanced by a versatile garden room/home office, complete with heating and electrics, making it suitable for year-round use.

The Location

Wilmslow is a vibrant, sought-after town located in Cheshire, renowned for its blend of scenic beauty, excellent transport links, and a strong sense of community. Known for its high standard of living, Wilmslow offers a variety of shops, restaurants, and local amenities, making it a popular choice for families and professionals alike. The town is surrounded by picturesque countryside, including the nearby Bollin Valley, offering plenty of outdoor recreational opportunities. With its close proximity to Manchester, excellent schools, and easy access to Wilmslow train station, which provides direct routes to London, Wilmslow is a perfect balance of convenience and rural charm. Its attractive combination of lifestyle and location makes it one of the most desirable places to live in the region.

Important Information

Council Tax Band: E

EPC grade: D

Heating - Gas central heating (radiators)

Mains - Gas, Electric, waters and drains

Property Construction- Brick built with tiled roof

Flood Risk*: Very low risk of flooding from rivers & seas. Low risk of surface water flooding.

Broadband***: Openreach- FTTP (Fibre to the Premises). You may also be able to obtain broadband service from these Fixed Wireless Access providers covering your area for Virgin Media, EE & Three*

Mobile Coverage***: Mobile coverage at the property available with all main providers*.

Some limited indoor & outdoor coverage.

Parking: Off road parking available

Rights of Way & Restrictive Covenants: TBC

Tenure:-Freehold

* Information provided by GOV.UK

***Information provided by Ofcom checker.

The information isn't guaranteed. Mosley Jarman take no responsibility for inaccuracies and advise potential buyers to do their own checks before committing to purchase.

Postcode: **SK9 4AP**

What 3 Words: **trades.flat.stand**

Council Tax Band: **E**

EPC Rating: **D**

Tenure: **Freehold**

OUTBUILDINGS
112 sq.ft. (10.4 sq.m.) approx.

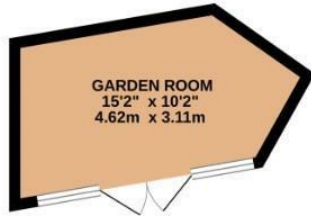

GROUND FLOOR
757 sq.ft. (70.3 sq.m.) approx.



1ST FLOOR
645 sq.ft. (59.9 sq.m.) approx.

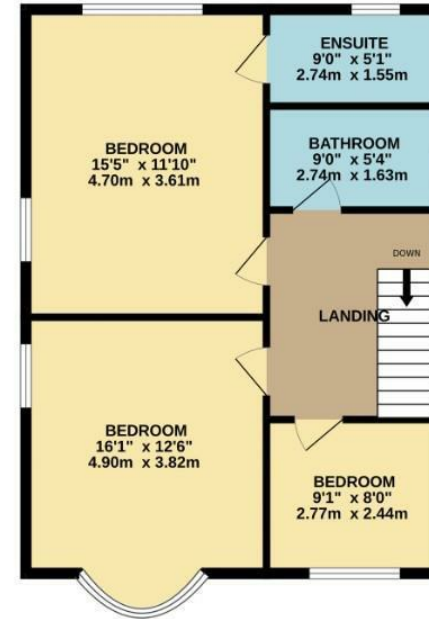

TOTAL FLOOR AREA : 1514 sq.ft. (140.6 sq.m.) approx.

Whilst every attempt has been made to ensure the accuracy of the floorplan contained here, measurements of doors, windows, rooms and any other items are approximate and no responsibility is taken for any error, omission or mis-statement. This plan is for illustrative purposes only and should be used as such by any prospective purchaser. The services, systems and appliances shown have not been tested and no guarantee as to their operability or efficiency can be given.

Made with Metropix ©2026

44 Alderley Road, Wilmslow, Cheshire, SK9 1NY

Email: wilmslow@mosleyjarman.co.uk

T: 01625 444899
www.mosleyjarman.co.uk

mosley jarman

PROPERTY MISDESCRIPTIONS ACT 1991: The Agents has not tested any apparatus, equipment, fixtures and fittings, or services, so cannot verify that they are in working order or fit for the purpose. The buyer is advised to obtain verification from his or her Professional Buyer. References to the Tenure of the property are based on information supplied by the Vendor. The agents have not had sight of the title documents. The buyer is advised to obtain verification from their Solicitor. You are advised to check the availability of any property before travelling any distance to view.