

16, Malpas Court, Northallerton  
Approximate Gross Internal Area  
Main House = 89 Sq M/958 Sq Ft

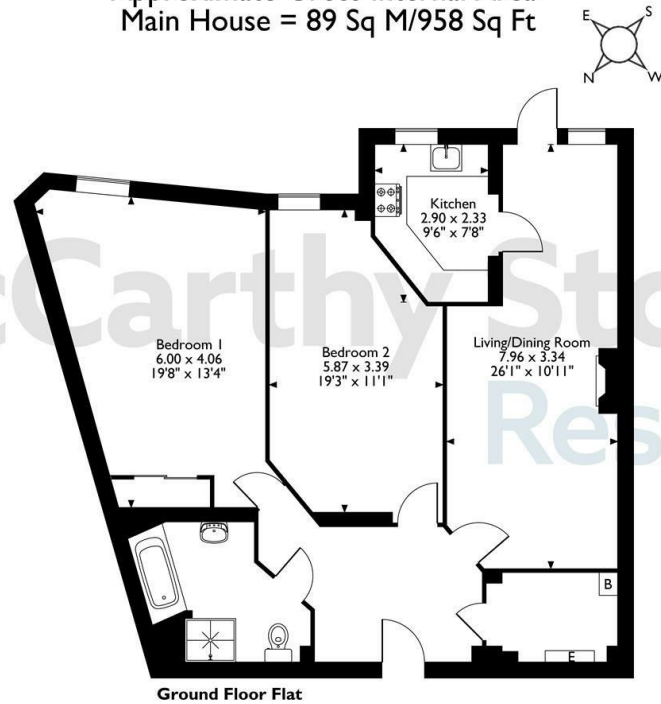

The position & size of doors, windows, appliances and other features are approximate only.  
© ehous. Unauthorised reproduction prohibited. Drawing ref. dig/8639216/DST.

Council Tax Band: D

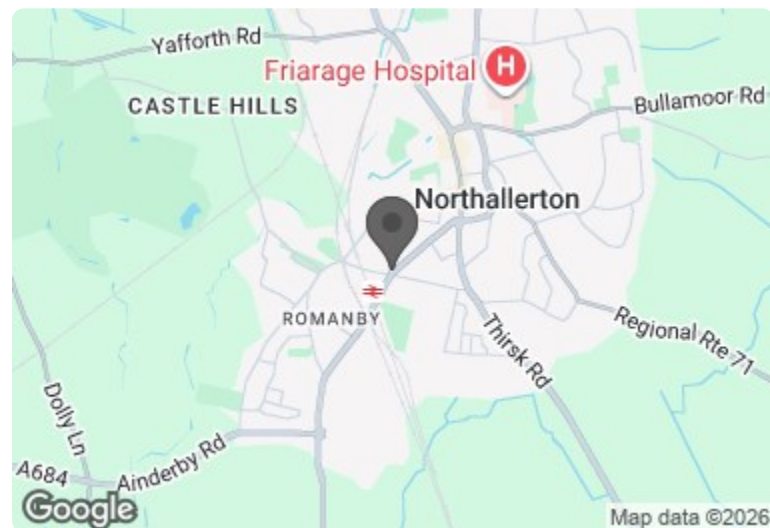

Energy Efficiency Rating		Current	Potential
Very energy efficient - lower running costs			
(92 plus) <b>A</b>			
(81-91) <b>B</b>			
(69-80) <b>C</b>			
(55-68) <b>D</b>		78	81
(39-54) <b>E</b>			
(21-38) <b>F</b>			
(1-20) <b>G</b>			
Not energy efficient - higher running costs			
<b>England &amp; Wales</b>		EU Directive 2002/91/EC	

## 16 Malpas Court

Malpas Road, Northallerton, DL7 8TG

**PRICE REDUCED**



**PRICE REDUCTION**

**Asking price £130,000 Leasehold**

A larger than average two bedroom retirement apartment for the OVER 70's, situated on the ground floor with it's own patio area. The excellent communal facilities include an in-house restaurant and communal lounge where social events take place and offering quality care services delivered by McCarthy Stone experienced CQC registered Estates team.

**Call us on 0345 556 4104 to find out more.**

resales@mccarthyandstone.co.uk | mccarthyandstoneresales.co.uk

This floor plan is not drawn to scale and is for illustrative purposes only. Any measurements, floor areas (including any total floor area), openings and orientation are approximate and for guidance only. McCarthy Stone Resales do not take liability for any error, omission or misstatement. All parties must rely on their own inspections. It should not be assumed that any furniture or fittings contained in the photographs are included in any sale. All details referring to time and distances to localities are approximate. Details regarding any common charges and other applicable fees are provided by the seller and should not be relied on without verification and further checks made through a solicitor/conveyancer. Please contact the Property Consultant for further information that Appliances (including central heating) have not been tested, therefore it cannot be assumed that they are in good working order. All interested parties are advised to check availability and make an appointment before travelling to view the property to avoid disappointment or wasted time or travel expenses. The details contained within this brochure are for information purposes only and do not form part of any agreement. All purchases will be subject to contract terms. © All artwork (photos and floorplans) and written content are the sole property and copyright of McCarthy & Stone Resales Limited and are legally protected by UK & International copyright laws. Under no circumstance may you download, reproduce, publish or distribute any content for commercial purposes, without prior written permission from McCarthy Stone Resales.

McCarthy & Stone Resales Limited, Trading as McCarthy Stone Resales  
Registered Office: 100 Holdenhurst Road, Bournemouth, Dorset, BH8 8AQ.  
Registered in England and Wales No. 10716544



# Malpas Road, Northallerton

## 2 Bed | £130,000

PRICE  
REDUCED

### Summary

Malpas Court was built by McCarthy & Stone purpose built for assisted living for the over 70's. The development consists of 50 one and two-bedroom retirement apartments with design features to make day-to-day living easier. This includes beautifully equipped kitchens with waist height ovens to minimise bending, walk-in showers for ease of use, simple lever taps and slip resistant flooring.

As well as the privacy of your own apartment, there's the opportunity to lead a full and active social life. You can call into the homeowners' lounge whenever you feel like company, and it's a lovely place to meet up with friends or join in the many activities organised by homeowners and the Estate Management team. The lounge is also the perfect space to invite friends and family over for a special celebration. Open every day, our table service restaurant serves tasty and nutritious lunches for our homeowners and their friends and family, at a very reasonable price. All the food is freshly prepared and we can cater for special dietary requirements. For a special occasion or celebration, you're also welcome to book our function room and there is a computer available to use here. Malpas Court also benefits from landscaped gardens and a guest suite for visitors who wish to stay (additional charges apply). For peace of mind, there is an Estate Manager on site and 24-hour emergency call system provided via a personal pendant alarm and with call points in all rooms.

### Local Area

Malpas Court is an Assisted Living development located in the affluent market town of Northallerton, 30 miles north of York. The town centre offers a variety of shops including many high street names as well as independent retailers including a family run department store. There are also 3 major supermarkets in Northallerton offering a wide variety of choice for residents of the town. There are good transport links by bus, with several operators providing local services in and around Northallerton plus the train station located on Boroughbridge Road offers links to Regional and National destinations including York, Newcastle and London.

### Entrance Hall

Front door with spy hole leads to the large entrance hall - the

24-hour Tunstall emergency response pull cord system is situated in the hall. From the hallway there is a door to a walk-in storage cupboard/airing cupboard. Illuminated light switches, smoke detector, apartment security door entry system with intercom. Doors lead to the lounge, bedrooms and bathroom.

### Lounge

Bright and airy lounge with patio doors leading to private patio area. There is a feature electric fire with surround which acts as an attractive focal point in addition to ample room for dining. There are raised electric sockets, TV and telephone points. Partially double glazed door leads onto a separate kitchen.

### Kitchen

Well equipped modern kitchen with tiled floor and a range of low and eye level units and drawers with a roll top work surface. Stainless steel sink with mono lever tap and drainer. Eye level oven, ceramic hob, cooker hood and integral fridge / freezer. Electrically operated kitchen window to front aspect.

### Bedroom One

Double bedroom benefiting from a mirror fronted built in wardrobes. Ceiling lights, TV and phone point.

### Bedroom Two

Spacious second bedroom which could be used for dining. Ceiling lights. TV and phone point.

### Bathroom

Fully tiled and fitted with suite comprising of level access shower and bath. Low level WC, vanity unit with wash basin and mirror above. Electric shaving point, heated chrome towel rail and extractor fan. Slip resistant flooring.

### Service Charge

- Cleaning of communal windows
- Water rates for communal areas and apartments
- Electricity, heating, lighting and power to communal areas
- 24-hour emergency call system
- Upkeep of gardens and grounds
- Repairs and maintenance to the interior and exterior communal areas
- Contingency fund including internal and external redecoration of communal areas

- Buildings insurance

One hour of domestic support per week is included in the service charge at Malpas Court, with additional personal care and support available at an extra charge. This can be from as little as 15 minutes per session which can be increased to suit your needs.

The service charge does not cover external costs such as your Council Tax, electricity or TV, but does include the cost of your Estate Manager, your water rates, the 24-hour emergency call system, the heating and maintenance of all communal areas, exterior property maintenance and gardening. Find out more about service charges please contact your Property Consultant or Estate Manager.

The service charge is £14,396.49 for financial year ending 31/03/2027.

### Car Parking Permit Scheme- subject to availability

Parking is by allocated space subject to availability. The fee is usually £250 per annum, but may vary by development. Permits are available on a first come, first served basis. Please check with the Estate Manager on site for availability.

### Leasehold

Lease length: 125 years from 2011  
Ground rent: £510 per year  
Ground rent review: Jan-26

### Additional Information & Services

- Fibre Broadband available
- Mains water and electricity
- Electric room heating
- Mains drainage

