



High Street, Lewes

Within the South Downs National Park, the county town of Lewes provides a combination of town convenience, coupled with picturesque surrounding countryside. Lewes offers an excellent range of independent shops and includes three supermarkets. The independent Depot Cinema, just two minutes from the High Street, is a state of the art three screen community cinema with gallery, restaurant and outdoor seating area. Lewes has a wide range of cafes, pubs and high quality sports facilities. There are both indoor and outdoor swimming pools, track and tennis facilities, and teams representing football, rugby, cricket and hockey. The internationally recognised Glyndebourne Opera House is only four miles from Lewes.

- Investors Buyers Only - Sitting Tenant
- Central Location on Lewes High Street
- One Bedroom Apartment
- Recently Refurbished





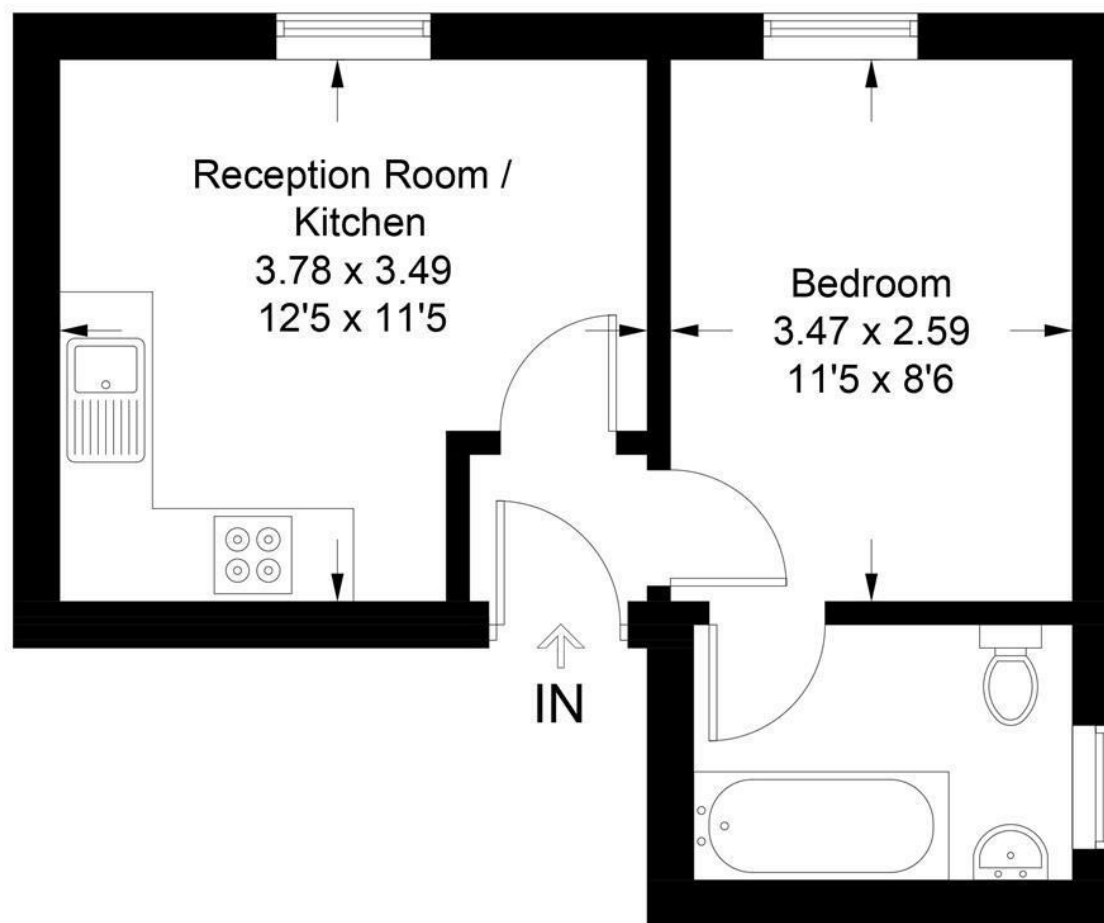

Approximate Gross Internal Area = 27.5 sq m / 296 sq ft

Illustration for identification purposes only, measurements are approximate,
not to scale. Fourlabs.co © (ID1191992)



t: 01273 477377

e: sales@lewesestates.co.uk

Every care is taken in preparing our sales particulars and they are usually verified by the vendor. We do not guarantee appliances, electrical fittings, plumbing, etc; you must satisfy yourself that they operate correctly. Room sizes are approximate. Please do not use them to buy carpets or furniture. We cannot verify the tenure as we do not have access to the legal title. We cannot guarantee boundaries or rights of way. You must take advice of your legal representative.

A light and bright one bedroom apartment conveniently located on Lewes High Street.

This property would be ideal as an Airbnb or holiday let, as well as suiting first time buyers or those looking for a weekend bolt-hole in central Lewes.

Situated on the first floor of this Victorian building, the flat was converted roughly 12 years ago and offers a kitchen, bathroom, sitting room and double bedroom.

Viewing is highly recommended.



draft



52 High Street, Lewes, East Sussex, BN7 1XE t: 01273 477377 e: sales@lewesestates.co.uk www.lewesestates.co.uk

**Lewes
Estates**