



3



3



1



D

DavidJames
the estate agent

Morley Avenue, Nottingham, NG3 5FW

£1,300 Per Calendar Month

About This Property

A well-presented three-storey mid terrace house perfectly located within easy reach of both Mapperley's and Sherwood's excellent amenities as well as frequent bus links to the City Centre. There are three versatile reception rooms including a dining room with adjoining modern kitchen with oven, gas hob and high-spec extractor hood. The first and second floors comprise three double bedrooms complimented by a modern bathroom/WC with white suite and mains shower. Outside there is a private rear garden with lawn, out-house storage and a driveway providing off-street parking for small vehicles (there is also ample unrestricted on-street parking).

TENANCY DETAILS

Available From: NOW

Tenancy Term: Minimum 6 months (12 months preferred)

Furnishing: Unfurnished

EPC Rating: D

Council Band: A

Pets: Not permitted

- Three-storey mid terrace house
- Refurbished 2 years ago
- THREE DOUBLE bedrooms set across two floors
- THREE versatile reception rooms
- Modern kitchen with ample units and integrated oven, hob & high spec extractor hood
- Modern bathroom/WC with white suite and mains shower
- UPVC double glazing, gas central heating
- Private rear garden with lawn & out-house storage
- Small driveway providing off-street parking for small vehicles (unrestricted on-street parking also available)
- Fantastic location, close to Sherwood's & Mapperley's ample amenities & transport links





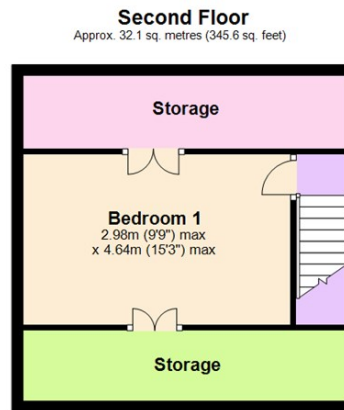
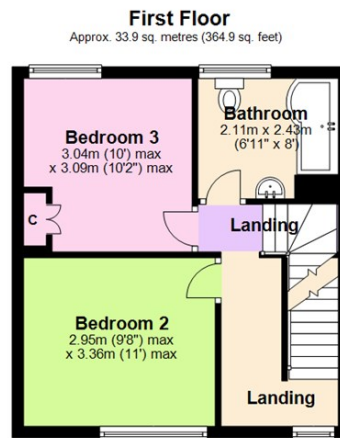
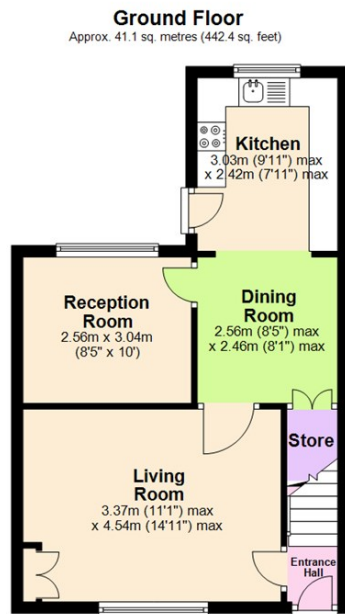

Total area: approx. 107.1 sq. metres (1152.8 sq. feet)

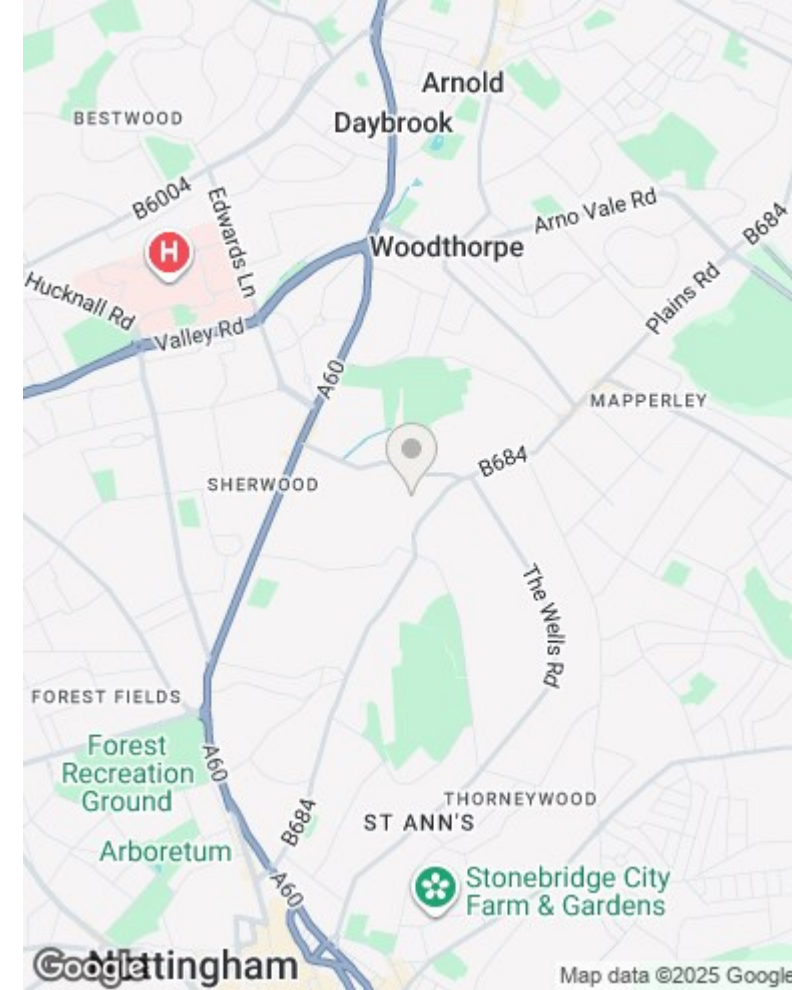

Council Tax Band: A
Nottingham City Council

These particulars are produced in good faith, are set out as a general guide only and do not constitute any part of a contract. No person in the employment of David James Estate Agents Ltd has any authority to make any representation whatsoever in relation to the property. All services, together with electrical fittings or fitted appliances have NOT been tested. All the measurements given in the details are approximate. Floor plans are for illustrative purposes only and are not drawn to scale. The position and size of doors, windows, appliances and other features are approximate only. The photographs of this property have been taken with a 10mm wide-angle lens. No responsibility can be accepted for any loss or expense incurred in viewing. If you have a property to sell you may wish to take advantage of our free valuation service. David James Estate Agents have established professional relationships with third-party suppliers for the provision of services to Clients. As remuneration for this professional relationship, the agent receives referral commission from the third-party company. David James Estate Agents receives the following commission from each third party supplier on a per referral basis: W A Barnes Ltd: £60 including VAT. All Moves UK Ltd: 18% including VAT of the invoice total (£107 including VAT average). MoveWithUs Limited: £188 including VAT (average).

DavidJames
the estate agent

David James Estate Agents
45b Plains Road, Mapperley, Nottingham, NG3 5JU
t: 0115 962 4213 e: lettings@david-james.com

naea | propertymark
PROTECTED

The Property Ombudsman