



56 MEADOW GROVE,
SHIREHAMPTON, BS11 9PH

GOODMAN
& LILLEY



Hallway

Stairs rising to first floor

Lounge

Two windows to front aspect

Kitchen

Contemporary style kitchen wall and base units in limed oak finish, wood effect surface with inset sink and drainer unit, mixer tap over ,integrated fridge freezer and dishwasher, rear aspect double glazed window to conservatory, uPVC double glazed doors leading to conservatory.

Utility Area

plumbing and space for washing machine,

Conservatory

Patio doors leading to rear garden, windows to rear

Landing

Window to side,

Bedroom 1

Window to front.

Bedroom 2

Window to rear,

Bedroom 3

Window to front,

Bathroom

Window to rear, Panel bath with shower over, low level wc, pedestal sink

Gardens

Enclosed by hedging, wall and fencing. mainly laid to lawn with a patio area.

Parking

There is parking to the front of the property.

-
- Three Bedrooms
 - Conservatory
 - Gardens
 - Semi Detached Home
 - Beautifully Presented
 - Parking



£270,000



Ground Floor

Approx. 47.3 sq. metres (509.1 sq. feet)

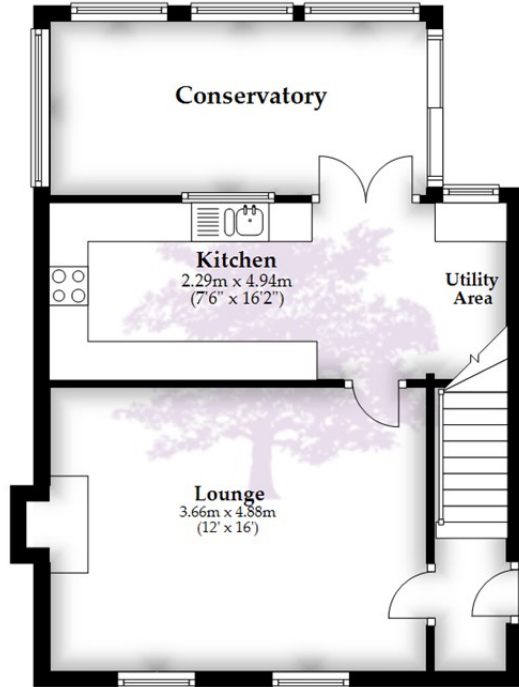

First Floor

Approx. 37.3 sq. metres (401.1 sq. feet)

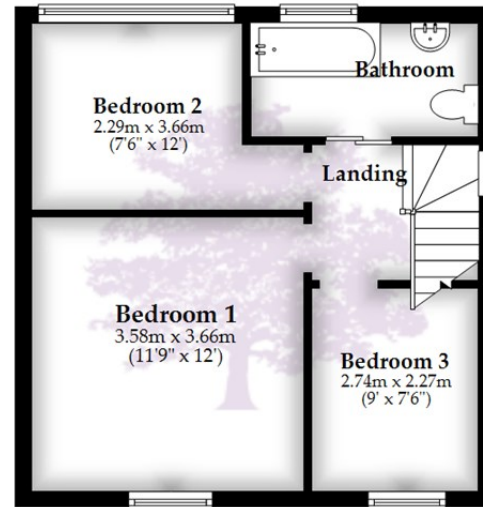

Total area: approx. 84.6 sq. metres (910.1 sq. feet)

HENLEAZE - 0117 2130777
henleaze@goodmanlilley.co.uk

PORTISHEAD - 01275 430440
sales@goodmanlilley.co.uk

SHIREHAMPTON - 0117 2130333
shire@goodmanlilley.co.uk

Zoopla.co.uk

rightmove



WWW.GOODMANLILLEY.CO.UK

These particulars are for general guidance only. They do not form or constitute any part of an offer or contract. Goodman & Lilley has not carried out structural surveys of the property. The services, appliances or specific fittings mentioned in these details have not been tested. Every attempt is made to ensure accuracy, however all photographs, measurements, floor plans and distances are for illustrative purposes only. They must not be relied upon when purchasing carpets and or other fixtures & fittings. Lease details, service charges and ground rents are given as a guide only. They should be checked and confirmed by a licensed solicitor prior to exchange of contracts. The copyright of all details, photographs and floor plans remain exclusive to Goodman & Lilley.