

Energy Efficiency Rating		Current	Potential
Very energy efficient - lower running costs			
(92 plus) A			85
(81-91) B			
(69-80) C			
(55-68) D		68	
(39-54) E			
(21-38) F			
(1-20) G			
Not energy efficient - higher running costs			
England & Wales	EU Directive 2002/91/EC		

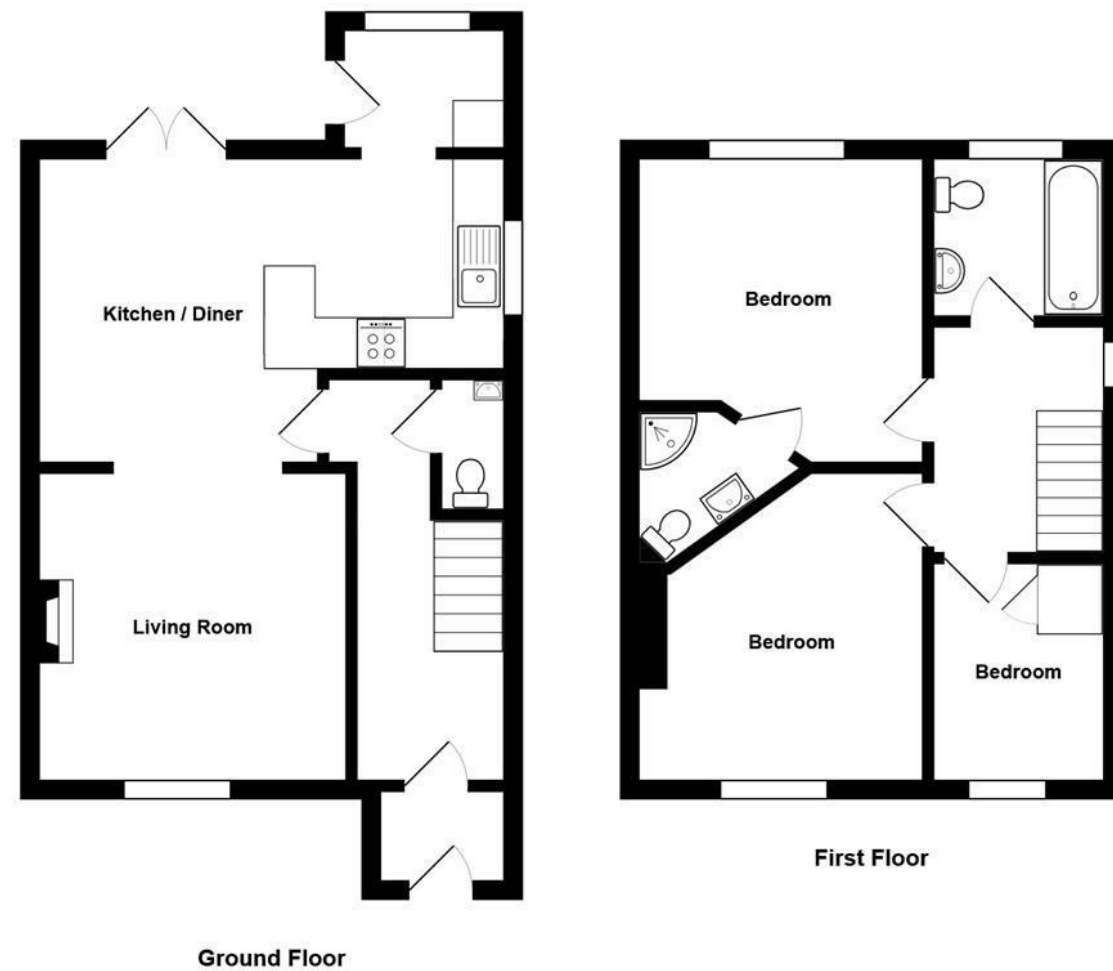

Total Area: 88.6 m² ... 953 ft²

All measurements are approximate and for display purposes only.

Ferndale Hobbs Wall, Farmborough, Bath, BA2 0BJ



Price Guide £425,000

An attractive 1930's built semi detached house enjoying far reaching views, with a large rear garden.

- Modernised and improved in the current ownership
- Entrance hall
- Downstairs cloakroom with wc
- Living room
- Open plan kitchen/dining room
- Rear porch/utility room
- 3 Bedrooms
- En suite shower room & family bathroom
- Parking to the front
- Large rear garden circa 195ft deep

Ferndale Hobbs Wall, Farmborough, Bath, BA2 0BJ

This 1930's semi detached house was extensively refurbished in around 2012. It offers well proportioned family accommodation enjoying the benefit of off street parking and a very large rear garden with far reaching rural views.

Internally the property is approached through a porch to an entrance hall where there is a downstairs cloak/wc. The living room is to the front of the house and is open to a kitchen/dining room furnished with good range of units and with direct access to a decked rear terrace. There is also a useful a utility/rear porch.

On the first floor there are three bedrooms, an ensuite shower room and family bathroom. On the outside, the property has the advantage of off street parking to the front and a very large rear garden over 195ft deep laid mainly to lawn but with great scope to creating a "good life" environment with vegetable plots, chickens etc and enjoying a very pleasant back drop with far reaching rural views.

Hobbs Wall is a community on the edge of the village of Farmborough just over half a mile from the village centre comprising a cluster of properties set back from the A39. The village itself has a community and coffee shop and a well regarded primary school together with garage services and Memorial Hall. There are further amenities at nearby High Littleton which is 1.5 miles away and the Town of Keynsham is some 6.5 miles away and has a railway station and Waitrose Food Store. Midsomer Norton and Radstock are a similar distance and cater for a range of day to day needs.

The situation of the property is ideal for those needing to commute to the cities of Bristol and Bath.

In fuller detail the accommodation comprises (all measurements are approximate):

GROUND FLOOR

CANOPIED ENTRANCE PORCH

Double glazed entrance door to

PORCH

Tiled floor, glazed inner door to

HALLWAY

Double glazed window to side aspect, staircase rising to first floor with storage area beneath. Contemporary radiator.

CLOAKROOM/WC

Double obscure glazed window to side aspect. White suite with chrome finished fittings comprising wc and wash basin with mixer tap, tiled splash back and cupboard beneath. Radiator, tiled floor.

SITTING ROOM 3.75m x 3.69m (12'3" x 12'1")

Double glazed window to front aspect, door to hallway. Contemporary vertical radiators, fireplace recess with flagged hearth. Open to

KITCHEN/DINING ROOM 3.69m reducing to 2.50m x 5.59m (12'1" reducing to 8'2" x 18'4")

Double glazed window to side aspect and double glazed french doors leading to the rear garden with far reaching rural views. Tiled floor, ceiling mounted downlighters. Two vertical contemporary radiators. The kitchen area is furnished with a range of modern wall and floor units with contrasting worksurfaces and tiled surrounds, inset sink with mixer tap, integrated fridge/freezer and dishwasher. Slot in cooker with canopied extractor hood above. Radiator.

REAR PORCH/UTILITY ROOM 1.89m x 1.20m (6'2" x 3'11")

Fitted work surfaces and plumbing for washing machine, further appliance space. Wall hung Worcester gas fired combination boiler. Double glazed window overlooking the rear garden and double glazed door to outside. Radiator.

FIRST FLOOR

LANDING

Access to roof space with folding wooden ladder. Double glazed window to side aspect. Contemporary radiator.

BEDROOM 3.65m x 3.43m (11'11" x 11'3")

Double glazed tilt and turn style window with Juliette balcony overlooking the rear aspect with lovely far reaching views. Vertical contemporary radiator.

ENSUITE SHOWER ROOM

Ceiling mounted downlighters, fully tiled walls and floor. White suite with chrome finished fittings comprising wc, wash basin with mixer tap and cupboard beneath. Corner shower enclosure with thermostatic shower, shaver point, heated towel rail.

BEDROOM 3.72m x 3.43m (to max) (12'2" x 11'3" (to max))

Double glazed window to front aspect, vertical contemporary radiator.

BEDROOM 2.59m x 2.11m (8'5" x 6'11")

Double glazed window to front aspect, vertical contemporary radiator, built in bulkhead cupboard (included in measurements).

BATHROOM 2.0m x 1.91m (6'6" x 6'3")

Double obscure window to rear aspect, fully tiled walls and floor, ceiling mounted downlighters and heated towel rail. White suite with chrome finished fittings comprising wc with concealed cistern, wash basin in vanity unit with mixer tap and bath with mixer tap incorporating shower attachment.

OUTSIDE

FRONT

To the front of the property is a parking area with a pedestrian pathway and cultivated bed to one side.

LARGE REAR GARDEN

In excess of 60m (approx. 195ft) deep and adjoining fields with attractive far reaching rural views. Immediately to the rear of the property is an extensive timber decked terrace on two levels with outside tap and power and a useful undercroft storage area. There is a pedestrian side access to the rear garden. Beyond the terrace the garden is laid predominantly to lawn with hedges and cultivated beds. There is a timber garden shed and open fronted wooden shelter. There are two apple trees at the far end of the plot. The garden is well suited for those with green fingers and offers scope to create a large vegetable plot, chicken run etc. The end of the plot would provide an ideal spot for a garden studio (subject to necessary consents).

TENURE

Freehold.

COUNCIL TAX

According to the Valuation Office Agency website, cti.voa.gov.uk the present Council Tax Band for the property is D. Please note that change of ownership is a 'relevant transaction' that can lead to the review of the existing council tax banding assessment.

ADDITIONAL INFORMATION

Local Authority : Bath & North East Somerset Council.

All mains services are available and connected.

Gas fired central heating.

Good mobile coverage externally & in home via EE & Vodafone. Good externally and variable internally via O2 & Three - source Ofcom.

Ultrafast 1000Mbps broadband available - source Ofcom.

