

2
BED

Modern Bungalow in Convenient Location

39, Malines Avenue, Peacehaven, BN10 7PR



Offers Over £325,000

Freehold

phillipmann
we do more

www.phillipmann.com

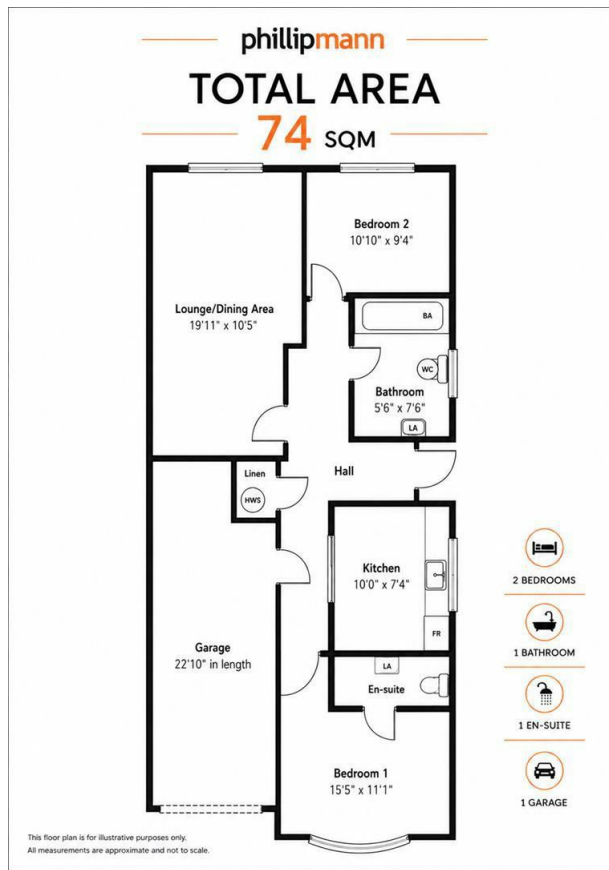

inbrief...

NO CHAIN

Occupying a sought-after position, this attractive modern semi-detached bungalow offers an excellent opportunity to enjoy coastal living in one of the area's most convenient locations. Situated within easy walking distance of regular bus services to Brighton, scenic cliff-top walks and beach access, the property perfectly combines modern living with everyday convenience.

The well-planned accommodation begins with a welcoming entrance hall featuring a useful built-in linen cupboard.

The spacious lounge/dining room sits at the rear of the property and forms the heart of the home, offering ample space for both living and dining areas. Patio doors flood the room with natural light and open directly onto the rear garden, creating an ideal space for relaxing or entertaining.

The fitted kitchen is well equipped with a range of wall and base units, generous worktop space, and room for all the usual appliances. A south facing window provides plenty of natural light and ventilation.

Positioned at the front of the property, the principal bedroom is bright and spacious, benefiting from an en-suite shower room comprising a shower, WC and wash hand basin. The generous second bedroom overlooks the rear garden, making it an ideal guest room, home office or additional double bedroom.

The main bathroom is well presented and comprises a bath with shower over, WC and wash hand basin.

Externally, the property features a block paved front garden, which offers additional off road parking and access to the oversized garage. The garage offers excellent storage or potential for conversion into additional living accommodation. The rear garden has been thoughtfully designed for low maintenance and benefits from gated side access.

This well-positioned bungalow presents a great opportunity to acquire a comfortable and versatile home in an enviable location, ideal for those seeking a relaxed lifestyle close to local amenities and the seafont.



EPC Rating - C
Council Tax Band - C

moreinfo...



Phillip Mann Peacehaven Office
226-230 South Coast Road, Peacehaven, BN10 8JR
01273 586622

To see more details on this & all our homes go to
www.phillipmann.com