

3
BED

Deceptively Spacious, Convenient Location

31, Southview Road, Peacehaven, BN10 8DR



Offers Over £399,950

Freehold

phillipmann
we do more

www.phillipmann.com

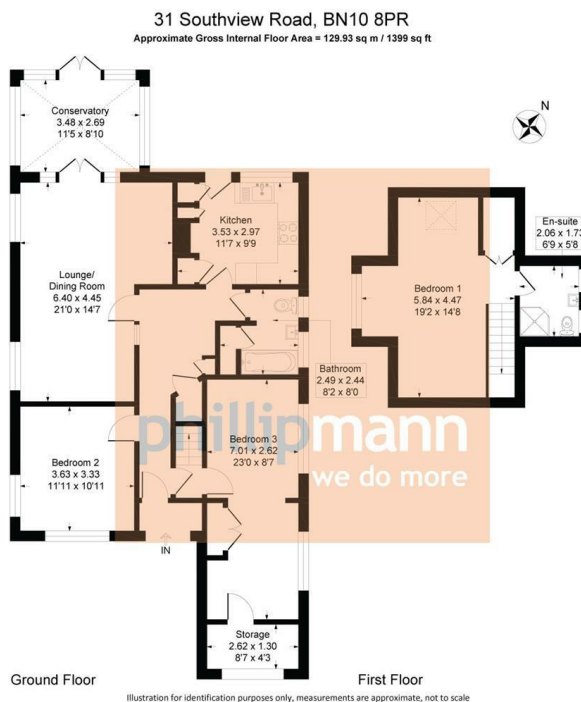

inbrief...

Grab this fantastic chance to acquire this deceptively spacious, detached chalet style bungalow which is situated on this good size level plot in this central, sought after location. The property is positioned in this quiet, yet well connected area and you will find bus routes, schools, local shops doctors surgery and other local amenities all with easy reach. Offering spacious yet versatile accommodation this could suit families, couples or those that work from home. The front door opens into a sizable entrance hall which offers plenty of space for you outdoor attire, under stair storage as well as accessing all ground floor accommodation.

At the front of the property, there are two double bedrooms with ample space for free standing furniture. Facing South, the lounge dining room offers plenty of space for all of your soft furnishings as well as a good size table and chairs. Doors to a conservatory is also a nice addition and this takes in a lovely vista of the rear garden. A modern refitted fitted kitchen with access to garden and bathroom finish the accommodation on the ground floor.

Upstairs, the main bedroom has windows to rear and side, useful eaves storage and ensuite shower room. With ample space covering the first floor, there will easily be space for dressing area and further desk space.

Externally you will find a block paved driveway providing ample parking with a shingle border. The south facing, private and secluded rear garden is mainly paved for ease of maintenance and is the perfect sun trap to soak up those rays.

Viewings Advised



EPC Rating - C

Council Tax Band - D

moreinfo...



Phillip Mann Peacehaven Office
226-230 South Coast Road, Peacehaven, BN10 8JR
01273 586622

To see more details on this & all our homes go to
www.phillipmann.com