

3
BED

A Spacious Three Bedroom House In Norman Road

10, Norman Road, Newhaven, BN99LJ



Price £349,950

Freehold

phillipmann
we do more

www.phillipmann.com

10 Norman Road, BN9 9LJ
 Approximate Gross Internal Floor Area = 152.21 sq m / 1638 sq ft

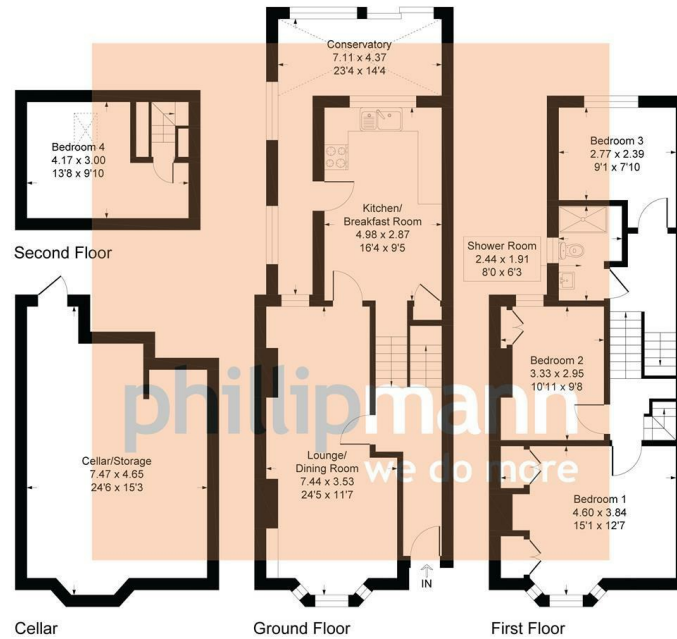

Illustration for identification purposes only, measurements are approximate, not to scale

inbrief...

Phillip Mann estate agents are delighted to offer for sale this well presented Victorian House. The property has been well looked after over the years of ownership and an internal viewing comes highly recommended.

A part glazed entrance door gives access to the entrance hall where there is access to the accommodation. The lounge/diner is a lovely room with wood flooring, feature open fireplace, ample space for a dining table and a bay window overlooks the front.

From the entrance hall, a few steps lead down to the kitchen/breakfast room, this is a lovely size and has been refitted with a good range of wall and base units. There is a built in sink unit along with a fridge/freezer. There is space for a range cooker and breakfast table. The room is complete with part tiled walls, wall mounted boiler, understairs cupboard and a window overlooks the rear. There is access to a large conservatory which is a handy area and overlooks the rear garden. From this area, there is access to a large cellar/storage area which run under the house.

The first floor landing has access to the remainder of the accommodation. Bedroom one is a lovely bright room with built in wardrobes and a bay window overlooks the front of the property. Bedroom two and three are both good size rooms which overlook the rear. There is a shower room which has large shower cubicle, WC and wash hand basin. Completing the property is a useable loft room which is accessed via fitted staircase.

Outside there is a low maintenance rear garden which is fence enclosed and a gate gives access to a rear lane.



Energy Rating D

Council Tax C

moreinfo...



Phillip Mann Newhaven Office
 16 Bridge Street, Newhaven, BN9 9PJ
 01273 517517

To see more details on this & all our homes go to
www.phillipmann.com