

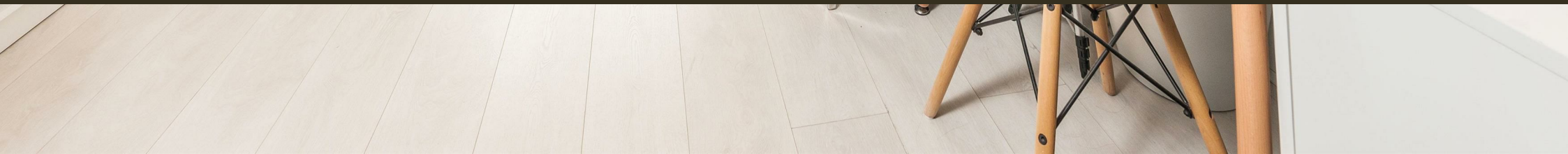

Woods House, 7 Gatliff Road
London SW1W

GARTON JONES.COM



Woods House, 7 Gatliff Road London, SW1W

GARTON JONES.COM

8 Gatliff Road
Chelsea
London
SW1W 8DP

Sales +44 (0) 20 7730 5007
gws@gartonjones.com
www.gartonjones.com

£125,000

A one DOUBLE BEDROOM apartment for sale (25% share). Rent £781.60 per month on the 75% share.

Approx. 498sq.ft (46.3sqm) on the eleventh floor (with lift) of Woods House, a secure building forming part of the popular GROSVENOR WATERSIDE development in Chelsea. This bright property boasts fantastic panoramic views of the London skyline, where you will be able to take in many of London's iconic landmarks. The property further benefits from an open plan reception room with a Juliette style balcony, a smart kitchen, a bathroom and good storage, including built in wardrobes to the bedroom.

24 HOUR CONCIERGE, GYM and SPA. On-site Sainsbury's Local, coffee shop and private kids club. SLOANE SQUARE and VICTORIA station with access to Gatwick Express trains, are within walking distance.

Available through Garton Jones' on-site office at Grosvenor Waterside (underneath Bramah House).

Service Charges inc Ground Rent £3402 pa
Water £145pa and heating/hot water £123pa
Leasehold — approx 110 years remaining

- 498 sq.ft (46.3sqm)
- 1 Double Bedroom
- Open Plan Reception Room
- Modern Integrated Kitchen
- Modern Bathrooms
- 25% Share £133,750
- Juliet Style Balcony and 24 Hour Concierge
- On-Site Sainsbury's, Creche, Coffee Shop & Purple Dragon Private Kids Club
- Close to Local Amenities Including Shops, Restaurants & Transport Link
- Walking Distance to Sloane Square & Victoria Station



EPC certificate available on request.

Woods House

Approximate Gross Internal Area = 505 sq ft / 47 sq m

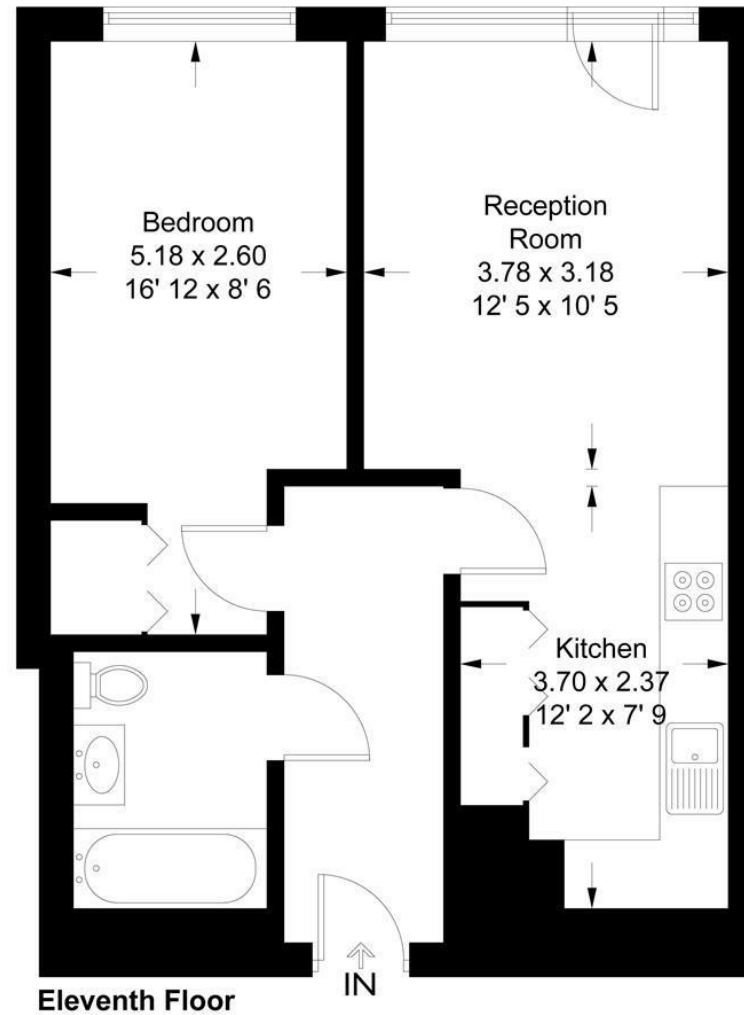

Not to scale, for guidance only and must not be relied upon as a statement of fact
All measurements and areas are approximate only and have been prepared in
accordance with the current edition of the RICS Code of Measuring Practice

