



CARVERS
SALES & LETTINGS

Mulgrave Court
Woodham, Newton Aycliffe, DL5 4TY
Offers in the region of £240,000

Bungalow - Detached



Occupying an elevated site, this DETACHED bungalow provides 3 bedroom living accommodation and is offered for sale with NO ONWARD CHAIN. An internal viewing will reveal a living room with separate dining room, kitchen/breakfast room, conservatory, en-suite shower room/WC and a family bathroom/WC. Externally there is a driveway extending to the side of the property with detached garage and large enclosed gardens to the rear. Whilst the property is in need of modernisation throughout it occupies a popular location off Lowther Drive consisting of "similar" style bungalows.



- Living room with separate dining room
- Kitchen/breakfast room
- Family bathroom/WC
- Sizeable enclosed rear garden
- No onward chain
- Conservatory
- En-suite shower room/WC
- Driveway leading to detached garage
- Modernisation required throughout

Agents Notes

Tenure:- Freehold

Mains gas, (central heating to radiators), electricity & drainage

uPVC double glazing throughout

Council Tax:- Band D

Local Authority:- Durham County Council

Buyer(s) Identification Checks

Should a purchaser(s) have an offer accepted on a property marketed by Carver Residential they will need to undertake an identification check. This is done to meet our obligation under Anti Money Laundering Regulations (AML) and is a legal requirement. We use a specialist third party service to verify your identity, this is not a credit check and will have no effect on credit history. The cost of these checks is £36 inc. VAT per buyer, which is paid in advance, when an offer is agreed and prior to a sales memorandum being issued. This charge is non-refundable.

Property Size

Please note the property size is taken from the Energy Performance Certificate and may not take into account all rooms from the floorplan (due to unheated space not being calculated e.g. conservatory, garage)



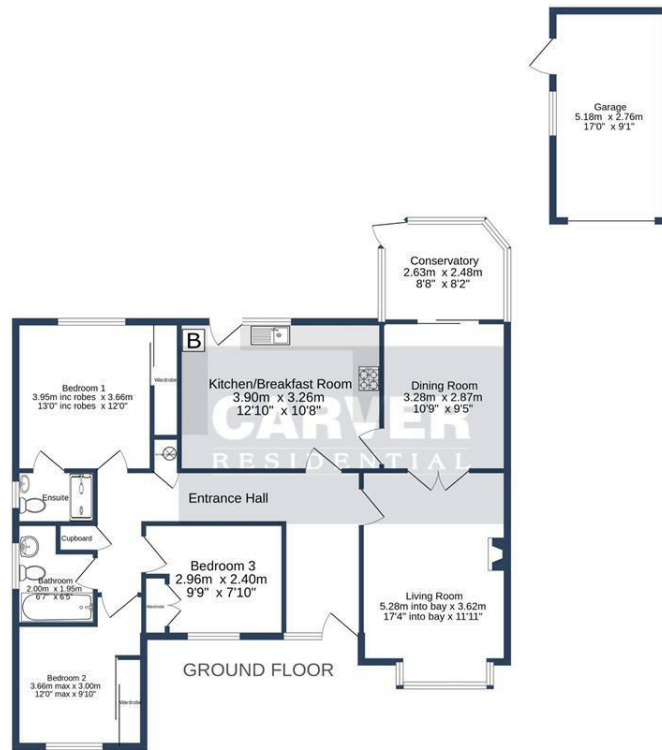

MULGRAVE COURT, NEWTON AYCLIFFE, DL5 4TY.

Whilst every attempt has been made to ensure the accuracy of the floorplan contained here, measurements of doors, windows, rooms and any other items are approximate and no responsibility is taken for any error, omission or mis-statement. This plan is for illustrative purposes only and should be used as such by any prospective purchaser. The services, systems and appliances shown have not been tested and no guarantee as to their operability or efficiency can be given.
Made with Metropage ©2020.

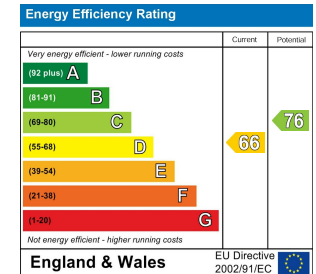

Searching 1,000s of mortgages
Access to 12,000+ products from 90+ lenders across the UK.
Call: 01325 370341 Visit: Any of our offices
Web: mortgageadvicebureau.com/carvers

Your home may be repossessed if you do not keep up repayments on your mortgage.
There may be a fee for mortgage advice. The actual amount you pay will depend upon your circumstances.
The fee is up to 1% but a typical fee is 0.3% of the amount borrowed.

These particulars do not constitute any part of an offer or contract. None of the statements contained in these particulars are to be relied on as statements or representations of fact and any intending purchaser must satisfy themselves by inspection or otherwise to the correctness of each of the statements contained in these particulars. The vendor does not make or give, and neither Carvers nor any person in their employment has any authority to make or give any representation or warranty whatever in relation to this property.