



CARVERS

SALES & LETTINGS

Bamburgh Crescent

Woodham, DL5 4SL

Offers in the region of £130,000

House - Semi-Detached



Situated in the popular Woodham area to the outskirts of Newton Aycliffe this beautifully presented semi-detached property is offered for sale with no onward chain.

Upon entering, you are welcomed by an entrance vestibule that leads into a spacious living room, complete with a staircase that ascends to the first floor. The heart of the home is undoubtedly the modern fitted kitchen/dining room, which features a range of integrated appliances and delightful French doors that open onto the rear garden, creating a seamless flow between indoor and outdoor living.

The first floor comprises two generously sized double bedrooms, providing ample space for relaxation and rest. The family bathroom/WC is equipped with a contemporary white suite, ensuring both style and functionality.

Externally, the property offers an open plan lawned garden to the front, complemented by a gravelled driveway. The sizeable enclosed gardens to the rear are a true highlight, featuring a wood-decked area, lush lawn, and gravelled sections, perfect for entertaining or enjoying quiet moments in the sun.

With no onward chain, this delightful home is ready for you to move in and make it your own. Don't miss the chance to view this wonderful property in a sought-after location.



- Spacious living room
- Two double bedrooms
- Sizeable enclosed rear garden with wood decked, gravelled and lawn areas
- uPVC double glazing & GCH, (rads)
- Popular Woodham location
- Modern fitted kitchen/dining room with a range of integrated appliances and French doors opening to rear garden
- Bathroom/WC with modern white suite
- Driveway
- Beautifully presented throughout
- No onward chain

Agents Notes

Tenure:- Freehold

Mains gas, (central heating to radiators), electricity & drainage

uPVC double glazing throughout

Council Tax:- Band A

Local Authority:- Durham County Council

Buyer(s) Identification Checks

Should a purchaser(s) have an offer accepted on a property marketed by Carver Residential they will need to undertake an identification check. This is done to meet our obligation under Anti Money Laundering Regulations (AML) and is a legal requirement. We use a specialist third party service to verify your identity, this is not a credit check and will have no effect on credit history. The cost of these checks is £36 inc. VAT per buyer, which is paid in advance, when an offer is agreed and prior to a sales memorandum being issued. This charge is non-refundable.

Property Size

Please note the property size is taken from the Energy Performance Certificate and may not take into account all rooms from the floorplan (due to unheated space not being calculated e.g. conservatory and/or garage)



Approx Gross Internal Area
60 sq m / 645 sq ft

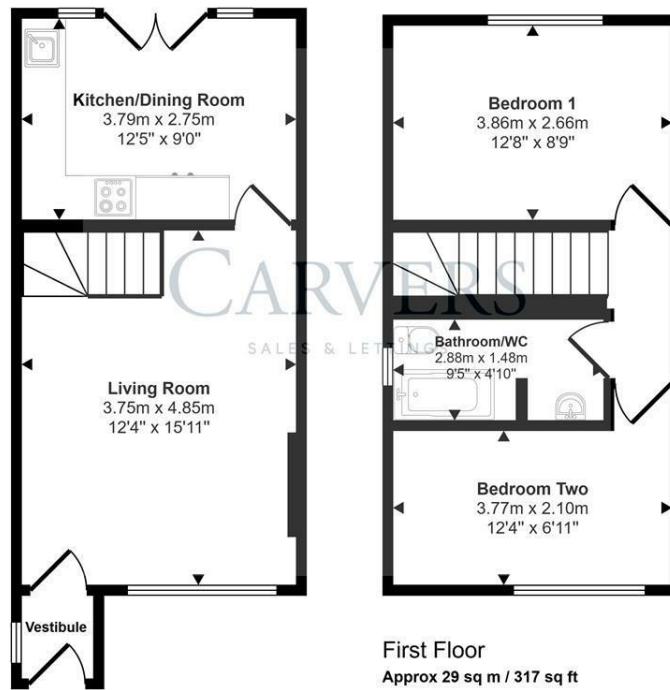

This floorplan is only for illustrative purposes and is not to scale. Measurements of rooms, doors, windows, and any items are approximate and no responsibility is taken for any error, omission or mis-statement. Icons of items such as bathroom suites are representations only and may not look like the real items. Made with Made Snappy 360.

Energy Efficiency Rating		
	Current	Potential
Very energy efficient - lower running costs		
(92 plus) A		
(81-91) B		
(69-80) C		
(55-68) D	72	78
(39-54) E		
(21-38) F		
(1-20) G		
Not energy efficient - higher running costs		
England & Wales	EU Directive 2002/91/EC	

Property size taken from EPC
721.00 sq ft

Searching 1,000s of mortgages
Access to 12,000+ products from 90+ lenders across the UK.
Call: 01325 370341 Visit: Any of our offices
Web: mortgageadvicebureau.com/carvers

Your home may be repossessed if you do not keep up repayments on your mortgage.
There may be a fee for mortgage advice. The actual amount you pay will depend upon your circumstances.
The fee is up to 1% but a typical fee is 0.3% of the amount borrowed.

These particulars do not constitute any part of an offer or contract. None of the statements contained in these particulars are to be relied on as statements or representations of fact and any intending purchaser must satisfy themselves by inspection or otherwise to the correctness of each of the statements contained in these particulars. The vendor does not make or give, and neither Carvers nor any person in their employment has any authority to make or give any representation or warranty whatever in relation to this property.