



CARVERS
SALES & LETTINGS

Mill Close
Ravensworth, DL11 7JY
Price £220,000

House - Terraced



3

1

1

This wonderful terraced home in the popular village of Ravensworth is sure to attract a wide range of attention, whether as a first time purchase or as an investment opportunity. With frontage directly onto the village green in a cosy development of similar properties this three bedroom home must be seen to be appreciated. Internal accommodation consists of an entrance hallway, separate living room, kitchen and utility room to the ground floor. The first floor holds three good sized bedrooms and a bathroom whilst externally the property offers front and rear gardens with residents parking available. Finished to a good standard with modern conveniences the property is ready to enjoy. EPC rating D, North Yorkshire Council tax band C.



- Modern Terraced Build
- Opposite Village Green
- Utility Room
- Gardens Front and Rear
- Three Bedrooms
- Popular Village Location
- Ideal First Purchase or Investment
- Residents Parking Area

General Information

Tenure: Freehold

Services: Oil central heating, mains electric, water and drainage.

Double glazing

Local Authority: North Yorkshire Council (Tax Banding C)

Buyer Identification Checks

Should a purchaser(s) have an offer accepted on a property marketed by Carver Residential they will need to undertake an identification check. This is done to meet our obligation under Anti Money Laundering Regulations (AML) and is a legal requirement. We use a specialist third party service to verify your identity, this is not a credit check and will have no effect on credit history. The cost of these checks is £36 inc. VAT per buyer, which is paid in advance, when an offer is agreed and prior to a sales memorandum being issued. This charge is non-refundable.

Property Size Reference

Please note the property size is taken from the Energy Performance Certificate and may not take into account all rooms from the floorplan (due to unheated space not being calculated e.g. this may potentially exclude a conservatory and/or garage)



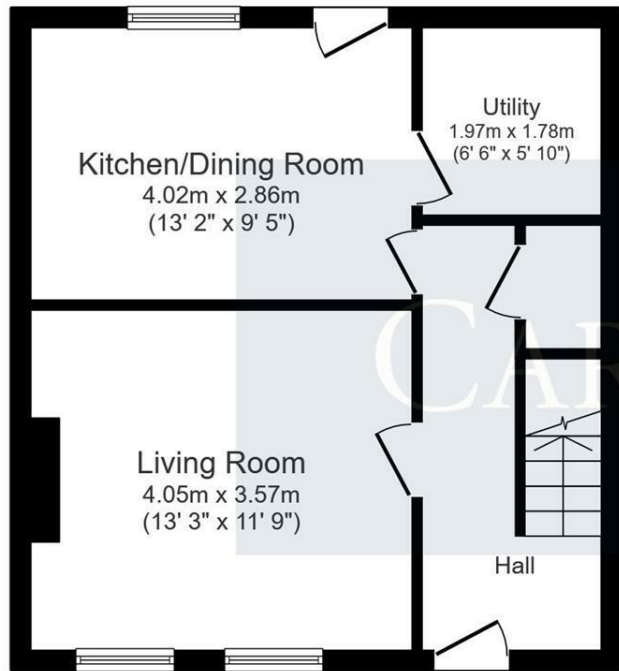

Ground Floor

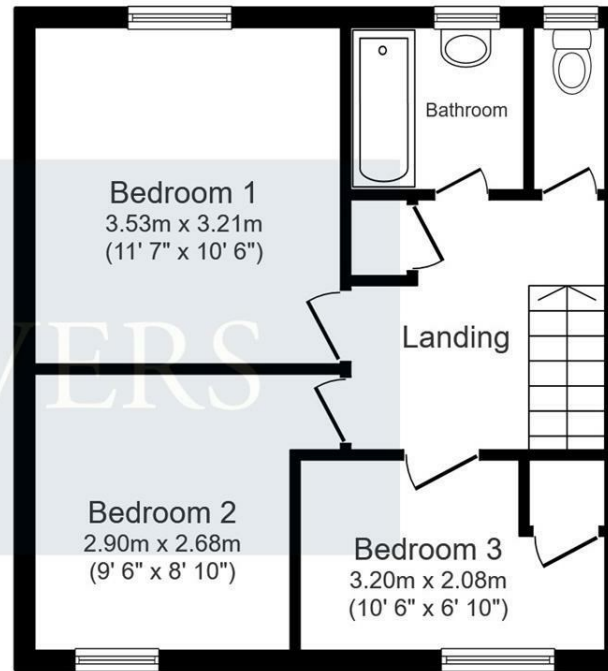

First Floor

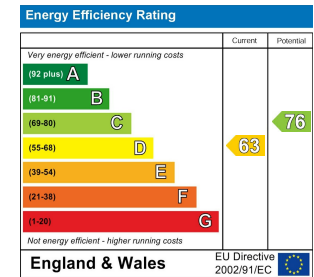

Property size taken from EPC
861.00 sq ft

This floor plan is for illustrative purposes only. It is not drawn to scale. Any measurements, floor areas (including any total floor area), openings and orientations are approximate. No details are guaranteed, they cannot be relied upon for any purpose and do not form any part of any agreement. No liability is taken for any error, omission or misstatement. A party must rely upon its own inspection(s). Powered by www.Propertybox.io

Searching 1,000s of mortgages
 Access to 12,000+ products from 90+ lenders across the UK.
 Call: 01325 370341 Visit: Any of our offices
 Web: mortgageadvicebureau.com/carvers

Your home may be repossessed if you do not keep up repayments on your mortgage.
 There may be a fee for mortgage advice. The actual amount you pay will depend upon your circumstances.
 The fee is up to 1% but a typical fee is 0.3% of the amount borrowed.

These particulars do not constitute any part of an offer or contract. None of the statements contained in these particulars are to be relied on as statements or representations of fact and any intending purchaser must satisfy themselves by inspection or otherwise to the correctness of each of the statements contained in these particulars. The vendor does not make or give, and neither Carvers nor any person in their employment has any authority to make or give any representation or warranty whatever in relation to this property.