



# CARVERS

SALES & LETTINGS

Bankhead Road

Northallerton, DL6 1JD

Offers in the region of £210,000

House - Semi-Detached



A three double bed roomed semi detached family home situated within a popular residential location set back from Bankhead Road. The property benefits from gas fired central heating and Upvc double glazing. The accommodation includes an entrance vestibule, spacious living room/dining room, fitted kitchen and garden room over looking the rear courtyard garden. To the first floor there are three double bedrooms a family bathroom and separate wc. Externally there is a front gravel garden, driveway providing off street parking and access to the garage which has power, light and a pedestrian door to the side. There is a lovely rear courtyard garden with patio area, garden shed and side gate.



- Spacious three double bed roomed semi detached home
- Gas central heating and Upvc double glazing
- Garden room with patio doors to the rear
- Three double bedrooms
- Driveway providing off street parking and access to the garage
- Spacious living room/dining room
- Fitted kitchen with integrated oven and hob
- Lovely rear courtyard garden

#### GENERAL INFORMATION

Tenure: Freehold

Services: Gas central heating, mains electric, water and drainage

Double glazing

Local Authority: North Yorkshire Band B

#### Buyers Identification Check(s)

Should a purchaser(s) have an offer accepted on a property marketed by Carver Residential they will need to undertake an identification check. This is done to meet our obligation under Anti Money Laundering Regulations (AML) and is a legal requirement. We use a specialist third party service to verify your identity, this is not a credit check and will have no effect on credit history. The cost of these checks is £36 inc. VAT per buyer, which is paid in advance, when an offer is agreed and prior to a sales memorandum being issued. This charge is non-refundable.

#### Property Size Information

Please note the property size is taken from the Energy Performance Certificate and may not take into account all rooms from the floorplan (due to unheated space not being calculated e.g. this may potentially exclude a conservatory and / or garage)



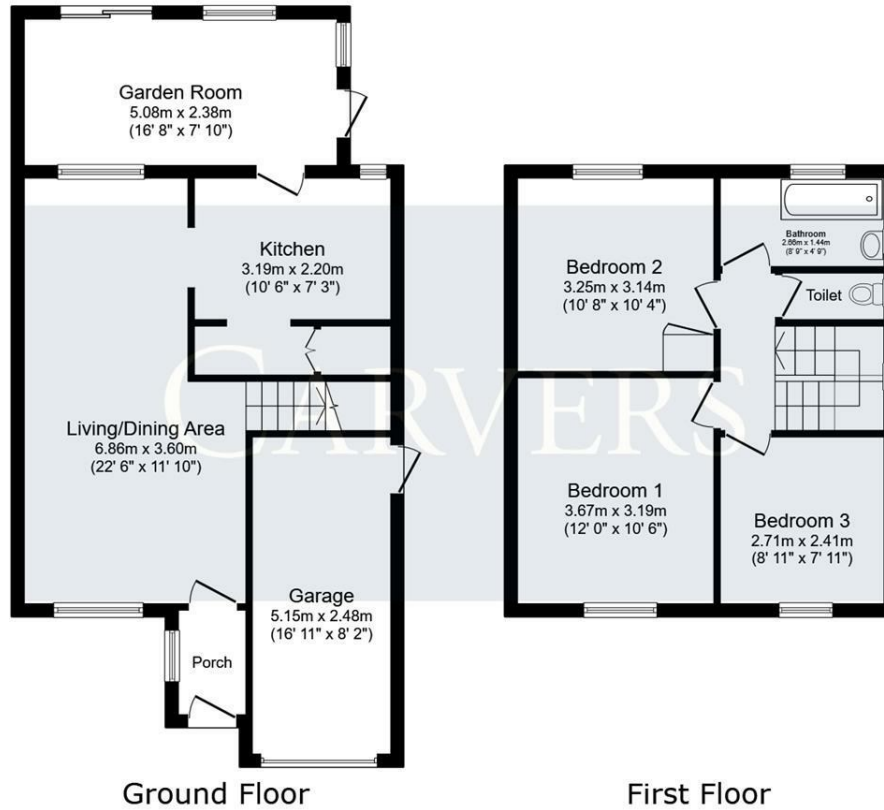

Energy Efficiency Rating		
	Current	Potential
Very energy efficient - lower running costs		
(92 plus) <b>A</b>		
(81-91) <b>B</b>		
(69-80) <b>C</b>		
(55-68) <b>D</b>		
(39-54) <b>E</b>		
(21-38) <b>F</b>		
(1-20) <b>G</b>		
Not energy efficient - higher running costs		
<b>England &amp; Wales</b>	EU Directive 2002/91/EC	

Property size taken from EPC sq ft

This floor plan is for illustrative purposes only. It is not drawn to scale. Any measurements, floor areas (including any total floor area), openings and orientations are approximate. No details are guaranteed, they cannot be relied upon for any purpose and do not form any part of any agreement. No liability is taken for any error, omission or misstatement. A party must rely upon its own inspection(s). Powered by www.Propertybox.io

**Searching 1,000s of mortgages**  
 Access to 12,000+ products from 90+ lenders across the UK.  
 Call: 01325 370341 Visit: Any of our offices  
 Web: [mortgageadvicebureau.com/carvers](http://mortgageadvicebureau.com/carvers)

Your home may be repossessed if you do not keep up repayments on your mortgage.  
 There may be a fee for mortgage advice. The actual amount you pay will depend upon your circumstances.  
 The fee is up to 1% but a typical fee is 0.3% of the amount borrowed.

These particulars do not constitute any part of an offer or contract. None of the statements contained in these particulars are to be relied on as statements or representations of fact and any intending purchaser must satisfy themselves by inspection or otherwise to the correctness of each of the statements contained in these particulars. The vendor does not make or give, and neither Carvers nor any person in their employment has any authority to make or give any representation or warranty whatever in relation to this property.