



MAGGS & ALLEN

211 SOUNDWELL ROAD
KINGSWOOD, BS15 1PT

£16,200 Per Annum

- Takeaway
- Prominent position
- Approximately 576 sq ft



Commercial & Investment
22 Richmond Hill, Clifton, Bristol, BS8 1BA

0117 973 4940
www.maggsandallen.co.uk

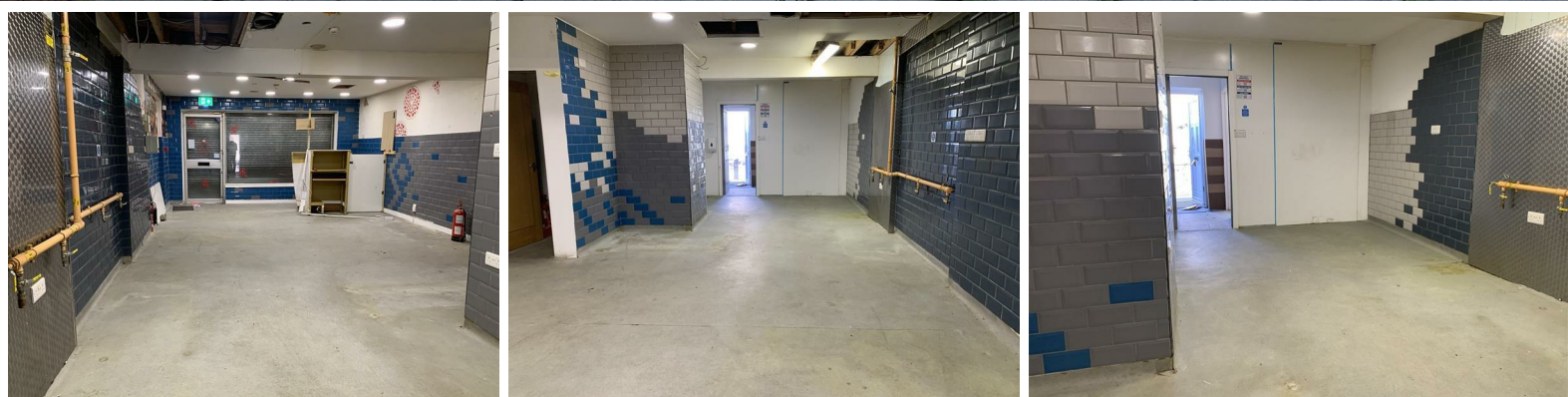

DESCRIPTION

The property comprises a ground floor commercial unit of approximately 576 sq ft, most recently trading as a takeaway. The accommodation is arranged to provide an open plan customer serving area to the front, with an adjoining storage room and WC. The layout offers a flexible footprint suitable for a variety of retail or food related uses, subject to consent.

LOCATION

The property is prominently positioned on Soundwell Road in Kingswood. It lies within close proximity to Tesco Esso Express and is also only a short distance from Kings Chase Shopping Centre, which serves as a key commercial hub for the surrounding community.

LEASE DETAILS

The premises is available to let on an effectively new full repairing and insuring lease. Each party to incur their own respective legal fees.

BUSINESS RATES

The rateable value with effect from April 2023 is £13,250, this currently includes the adjoining shop. We therefore would expect those eligible for small business relief to benefit from 100% once rerated. However, we advise all interested parties to confirm directly with the local authority.

ENERGY PERFORMANCE CERTIFICATE (EPC)

EPC rating: C (valid until August 2035)

FLOOR PLAN

The floor plan is provided for indicative purposes only and should not be relied upon.

VAT

All figures quoted are exclusive of VAT unless otherwise stated.

VIEWINGS

By appointment.

CONTROL OF ASBESTOS REGULATIONS

As per the Control of Asbestos Regulations 2012, the owner or tenant of the property, or anyone else who has control over it and/or responsibility for maintaining it, must comply with the regulations which may include the detection of and/or management of any asbestos or asbestos related compounds contained at the property. Maggs & Allen has not tested or inspected for asbestos and therefore recommend all interested parties to make their own enquiries.

TENANT APPLICATION FEE

The incoming tenant will be charged an application fee of £300 plus VAT (£360 inc VAT) towards the costs incurred in undertaking appropriate credit and reference checks. Accounts will be requested where available and a deposit and/or personal guarantee may be required.

CODE FOR LEASING BUSINESS PREMISES

We advise all interested parties to refer to the RICS Code for Leasing Business Premises, link available via our website.



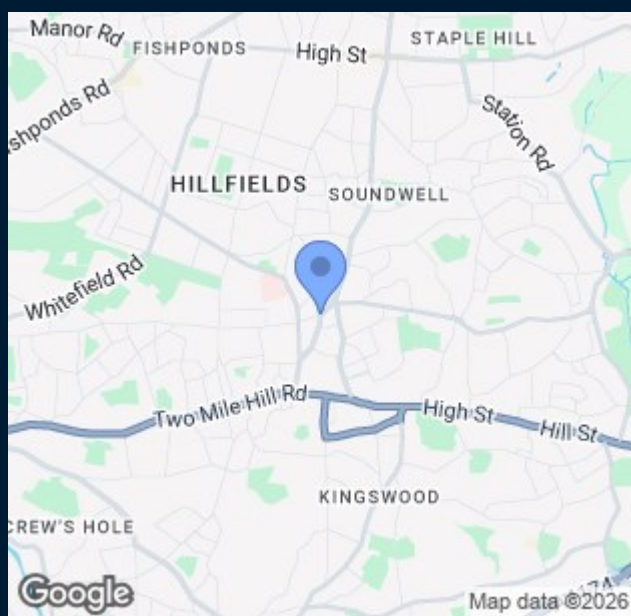

Maggs & Allen use all reasonable endeavours to supply accurate property information in line with the Consumer Protection from Unfair Trading Regulations 2008. These property details do not constitute any part of the offer or contract and all measurements are approximate. It should not be assumed that this property has all the necessary Planning, Building Regulations or other consents. Any services, appliances and heating system(s) listed have not been checked or tested. Please note that in some instances the photographs may have been taken using a wide angled lens and please be advised that any site plans used within our particulars are for illustrative purposes only and may not be to scale. Any distance from schools are for guidance only and you should make your own enquiries with the local authority.

GROUND FLOOR
576 sq.ft. (53.5 sq.m.) approx.

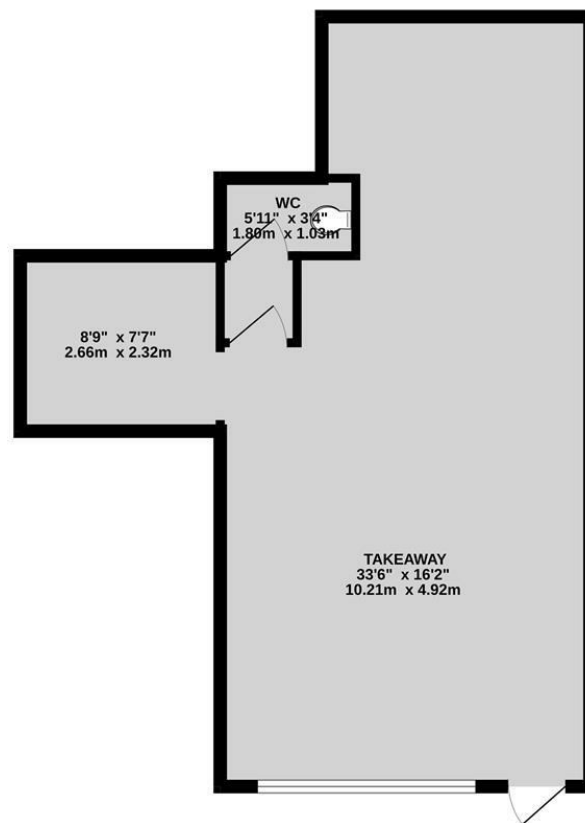

TOTAL FLOOR AREA : 576 sq.ft. (53.5 sq.m.) approx.

Whilst every attempt has been made to ensure the accuracy of the floorplan contained here, measurements of doors, windows, rooms and any other items are approximate and no responsibility is taken for any error, omission or mis-statement. This plan is for illustrative purposes only and should be used as such by any prospective purchaser. The services, systems and appliances shown have not been tested and no guarantee as to their operability or efficiency can be given.
Made with Metropix ©2025



22 Richmond Hill, Clifton, Bristol, BS8 1BA

0117 973 4940

www.maggsandallen.co.uk

**MAGGS
& ALLEN**