

## Savile Park Mills Moorfield Street

Savile Park, Halifax, HX1 3DT

**£695 PCM**





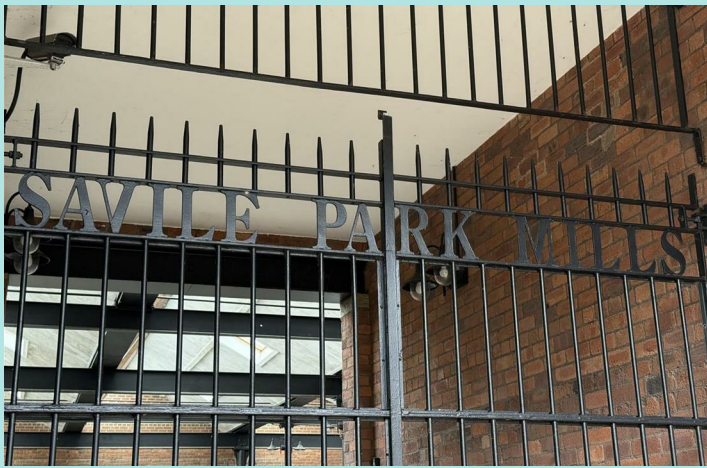

This first floor one bedroom part furnished apartment is ideally suited to a professional single person or couple. The accommodation briefly comprises of an entrance hall, open plan lounge/kitchen with kitchen, double bedroom and shower room. Ideally located close to local amenities and transport connections, an early internal inspection is highly recommended to avoid disappointment.

#### Accommodation

This one bedroom apartment forms part of this bespoke development within the sought after Savile Park residential area. Having secure underground car parking, the apartment comes partly furnished with traditional features throughout and comprises of entrance hall, open plan lounge/kitchen with kitchen having range of base, drawer and wall units including integrated oven and four plate hob, double bedroom with walk in wardrobe, and shower room with three piece white suite.

#### Location

The accommodation is ideally situated near the Bell Hall area and is convenient for local amenities and transport links to Halifax town centre and the surrounding areas. The property is close to Savile Park and Manor Heath with ample green space.

Council tax band: A  
EPC rating: C  
Deposit: £801

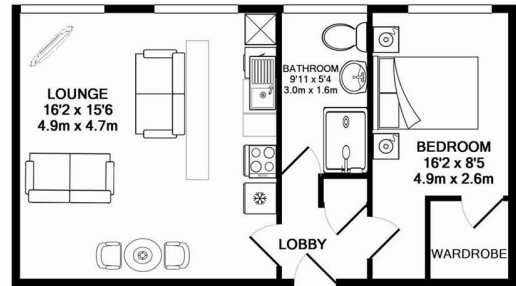

TOTAL APPROX. FLOOR AREA 473 SQ.FT. (44.0 SQ.M.)

Whilst every attempt has been made to ensure the accuracy of the floor plan contained here, measurements of doors, windows, rooms and any other items are approximate and no responsibility is taken for any error, omission, or mis-statement. This plan is for illustrative purposes only.

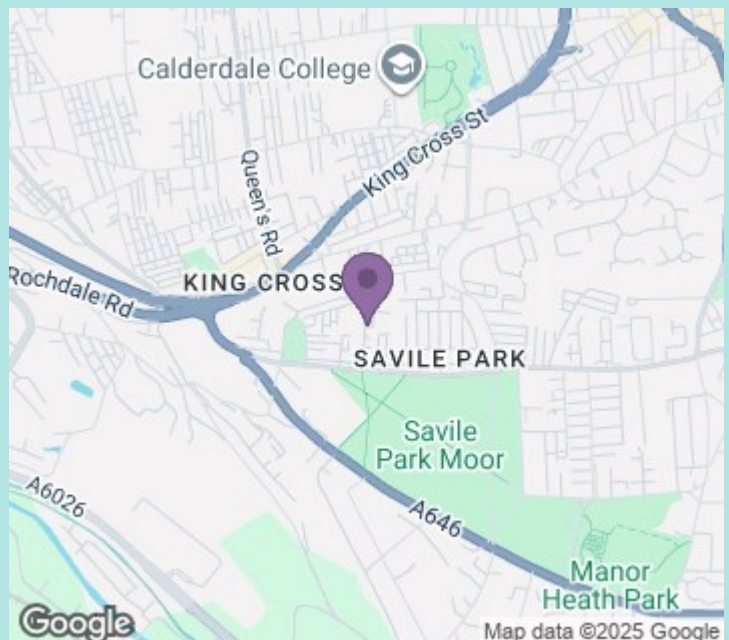

ws-residential.co.uk

01484 711200



These particulars, whilst believed to be accurate are set out as a general outline only for guidance and do not constitute any part of an offer or contract. Intending purchasers should not rely on them as statements of representation of fact, but must satisfy themselves by inspection or otherwise as to their accuracy. No person in this firm's employment has the authority to make or give any representation or warranty in respect of the property.