



3 Bridge Road

Brighouse, HD6 1EP

£735 PCM





An attractive two bedroom apartment converted and forming part of a niche development with just one other apartment. Situated in the heart of Brighouse town centre the property is situated in an ideal location. Internally the property comprises; communal stairwell to first floor level, entrance to hallway, open plan living kitchen, two double bedrooms and bathroom benefiting from four piece white suite. With modern fixtures & fittings throughout an internal inspection is recommended to fully appreciate.

Location:

An attractive two bedroom apartment situated in the heart of Brighouse town centre the property is ideally located for commuter links such as Brighouse railway station & J25 of the M62 motorway network. Benefiting from being a short walk away from a wide range of local amenities.

Accommodation:

The apartment is accessed via secure door directly from Bridge Road. Communal lobby area and stairwell leads to small landing area servicing Apts 1 & 2. The property comprises open plan lounge / kitchen having range of grey coloured timber base, drawer and wall units with laminate work surfaces and benefiting from under cupboard lighting, integrated electric oven, four plate hob and extractor hood, integrated refrigerator and freezer, washer/dryer & dishwasher. Two double bedrooms, and house bath benefiting from three piece white suite to include panel bath, sink pedestal, low flush WC.

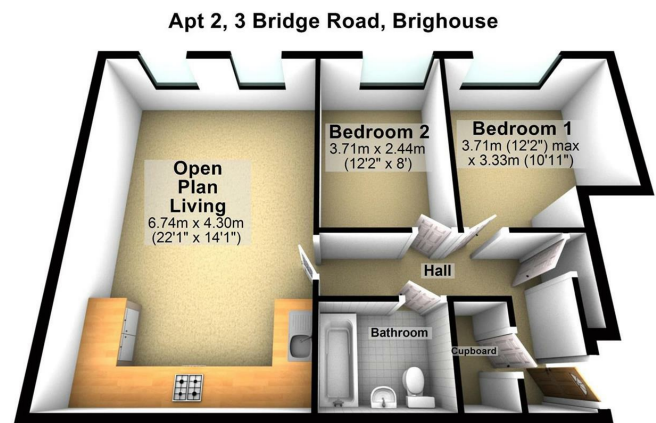

Council tax band: A
EPC rating: E
Deposit: £848

ws-residential.co.uk

01484 711200



These particulars, whilst believed to be accurate are set out as a general outline only for guidance and do not constitute any part of an offer or contract. Intending purchasers should not rely on them as statements of representation of fact, but must satisfy themselves by inspection or otherwise as to their accuracy. No person in this firm's employment has the authority to make or give any representation or warranty in respect of the property.