



## 5 Bethel Terrace

Luddenden, Halifax, HX2 6RE

£695 Per calendar month





Nestled in the charming residential area of Luddenden, Halifax, this delightful mid-terrace home on Bethel Terrace offers a perfect blend of comfort and convenience. On the ground floor is the spacious kitchen with area for dining, lounge, two generously sized double bedrooms, and a house bathroom comprising a three-piece white bathroom suite. Outside, you will find a small outdoor area to the rear.

With its appealing features and prime location, this stone built cottage is a wonderful opportunity for those looking to make Luddenden their home.

#### Location

Luddenden is an attractive and highly regarded village situated just off the Calder Valley - made famous by Hebden Bridge market town, and recently - the filming of Sally Wainwright's drama series 'Happy Valley'. Local convenience stores and a historic public house are found within the village, whilst railway connections in Mytholmroyd and Sowerby Bridge service the larger conurbations of Halifax, Leeds & Manchester.

#### Accommodation

This accommodation briefly comprises kitchen to the rear benefiting from a range of wall, base and drawer units with integrated hob and oven with overhead extractor fan, undercounter washing machine, with space for freestanding fridge/freezer. The kitchen also has room for a small dining area. To the front elevation is the main lounge and entrance hallway leading to the first floor. The house bathroom benefits from a three piece white suite to include, sink pedestal, low flush WC, panelled bath with over head shower. Both bedrooms are of a good size.

Council tax band: A  
EPC rating: D  
Deposit: £801

Ground Floor



First Floor

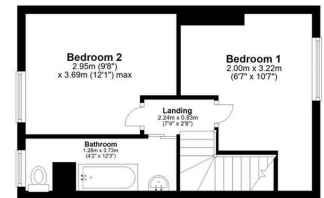

Total area: approx. 60.6 sq. metres (652.3 sq. feet)

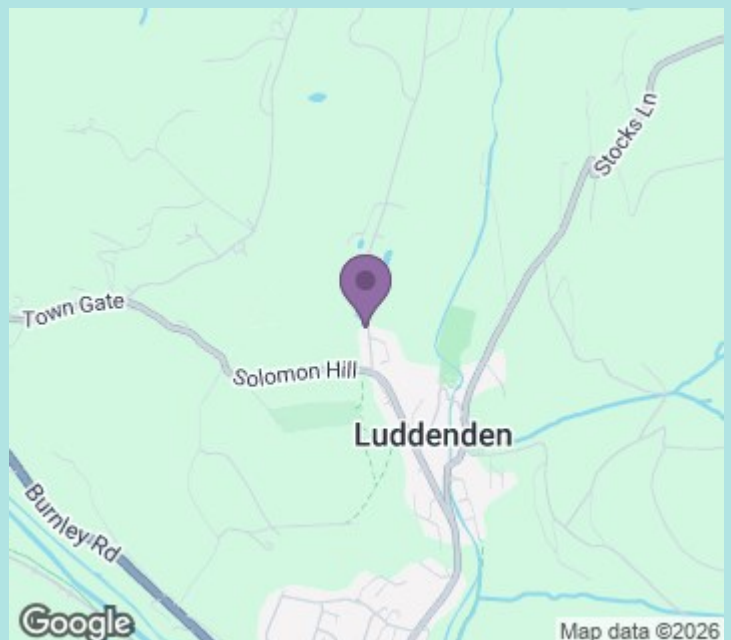

[ws-residential.co.uk](http://ws-residential.co.uk)

01484 711200



These particulars, whilst believed to be accurate are set out as a general outline only for guidance and do not constitute any part of an offer or contract. Intending purchasers should not rely on them as statements of representation of fact, but must satisfy themselves by inspection or otherwise as to their accuracy. No person in this firm's employment has the authority to make or give any representation or warranty in respect of the property.