



3 Culver Street, Newent GL18 1DB
£210,000



3 Culver Street, Newent GL18 1DB

- Two/three bedroom period home believed to date back to the 1400's
- Located in the centre of the market town of Newent
- Pleasant walled courtyard garden
- Character features throughout to include inglenook fireplace and beams
- Kitchen/diner, utility room and ground floor cloakroom
- Spacious attic room suitable for a variety of uses
- Council tax band B - £1878.47 (2025/26)
- EPC E53



1 High Street, Newent, GL18 1AN

01531 828970

newent@naylorpowell.com

www.naylorpowell.com

£210,000

Entrance Hall

Steps with an iron balustrade lead up to a solid wood front door which welcomes you in to a practical, enclosed entrance hall with space for storing coats and shoes. A wooden door with glazed panels leads into the living room.

Living Room

The charming living room boasts an inglenook fireplace with brick surround, space for an electric fire and oak mantelpiece. The room features exposed beams to the walls and ceiling and tiled flooring throughout. A solid wood staircase with carved balustrade leads to the first floor, an opening takes you to the kitchen/dining room and a window overlooks the front aspect.

Kitchen/Dining Room

The traditional kitchen with exposed beams offers ample storage in a range of floor and eye level units. There is a range of integrated appliances to include an electric oven and four ring gas hob and a stainless steel sink with mixer tap set beneath a window overlooking the rear courtyard. There are dual aspect windows to the front and rear and space for a dining table and further storage. A thumb latch oak door leads to the utility room.

Utility Room

A practical room with worktop space and plumbing for a washing machine. A window overlooks the rear aspect and a door leads out to the garden.

Cloakroom

White suite comprising WC and handwash basin. Window to side aspect.

Bedroom One

The double bedroom features exposed beams to the walls and a built-in wardrobe with sliding doors, providing storage space. A window overlooks the front aspect.

Bedroom Two

A further double bedroom with exposed beams to the walls and ceiling and a window overlooking the front aspect.

Shower Room

The modern shower room with part-tiled walls and exposed beams comprises a fully glazed shower cubical, WC and pedestal wash hand basin. There is a radiator with towel rail, oak wall cupboard and a frosted window to the rear aspect.

Attic Room / Bedroom Three

From the first-floor landing, stairs lead to the second floor attic room. The room could suit a variety of uses and features exposed bricks and beams along with a pitched roof and a Velux window.

Outside

The property is accessed via steps with an iron balustrade leading off Culver Street. To the rear of the home is a pleasant, private walled courtyard garden with a block paved patio and mature raised beds.

Location

The market town of Newent sits 8 miles northwest of Gloucester, on the northern edge of the Forest of Dean. Served by three schools, doctors surgery, dentist, sports & leisure centre, excellent motorway links to the M50 & M5 alongside additional local amenities the town lends itself to those looking for an active community.

Material Information

Tenure - Freehold

Council Tax Band B

Forest of Dean District Council - £1878.47 (2025/26)

Electricity supply: Mains

Water supply: Mains

Sewerage: Mains

Heating: Gas central heating

Broadband speed: Standard 19 Mbps, Superfast 80 Mbps

Mobile phone coverage: Vodafone, EE, Three and O2



GROUND FLOOR

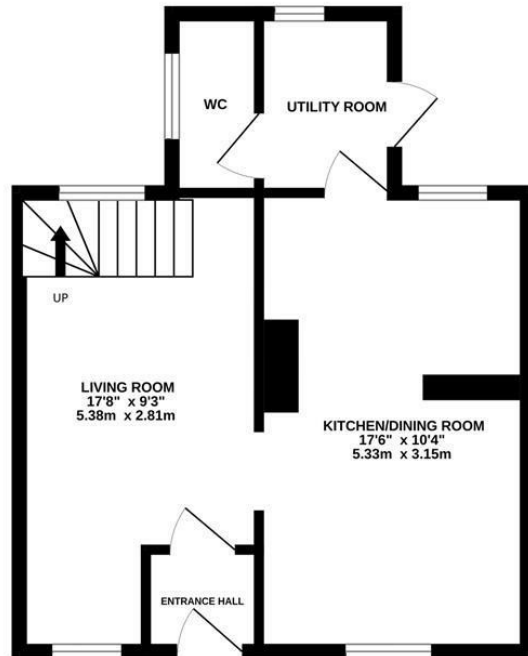

1ST FLOOR

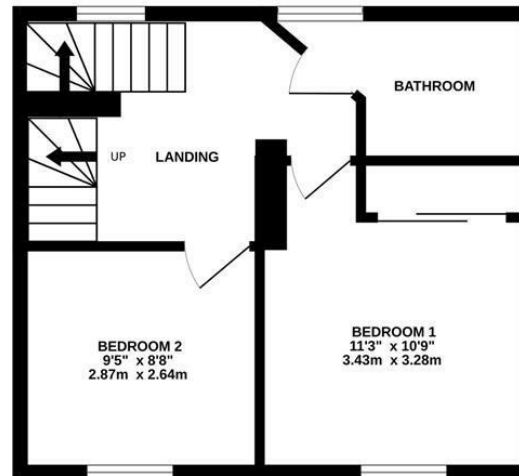

2ND FLOOR

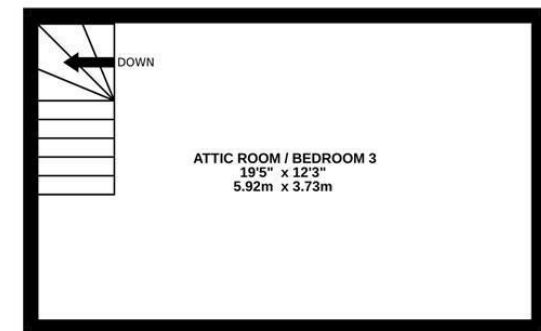

Whilst every attempt has been made to ensure the accuracy of the floorplan contained here, measurements of doors, windows, rooms and any other items are approximate and no responsibility is taken for any error, omission or mis-statement. This plan is for illustrative purposes only and should be used as such by any prospective purchaser. The services, systems and appliances shown have not been tested and no guarantee as to their operability or efficiency can be given.
Made with Metropix ©2025

Disclaimer: These particulars do not form part of any contract and no responsibility is accepted for any errors or omissions in any statement made, whether verbally or written for or on behalf of Naylor Powell.

Floorplans have been prepared for identification purposes only, they are not to scale and no guarantee can be given as to their accuracy.

Prospective purchasers please be aware none of the appliances, boiler, heaters etc. which may have been mentioned in these particulars have been tested and no guarantee can be given that they are in working order. Prospective purchasers should arrange for such items to be tested at their own expense.

