



Ford Farm Poultry Sheds Ford Lane, Newent GL18 1NW

Guide Price £795,000



Ford Farm Poultry Sheds Ford Lane, Newent GL18 1NW

- Rarely available development opportunity
- Three residential units, two of which are partially built
- Rural location
- Vast potential
- Plot approaching 1 acre

Guide Price £795,000

Site summary

A rarely available and fantastic development opportunity in a lovely rural location. The site consists of two partially built three/four bedroom detached family homes and a further building plot for a three bedroom detached bungalow with shared driveway and green spaces.

The area of the whole site is 0.91 of an acre (3705 square metres)

Location

Kilcot and Gorsley are adjoining rural villages located within the Forest of Dean District of

Gloucestershire, about two miles west of the Market town of Newent. The rural location benefits from the local Gorsley Goffs Primary School, the renowned pubs The Kilcot Inn and Roadmaker Inn, local shop and post office, popular coffee house, active Cricket Club at nearby Aston Ingham and bus route and good motorway links to both the M50 and M5.

Further information

Planning reference: P1882/19/FUL via Forest of Dean District Council
To be sold as a whole site
All services to be connected and installed



1 High Street, Newent, GL18 1AN

01531 828970

newent@naylorpowell.com

www.naylorpowell.com



GROUND FLOOR

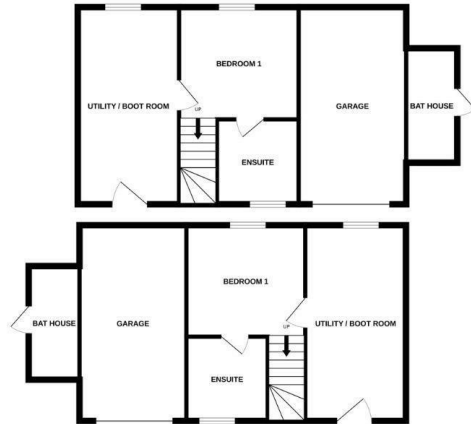

1ST FLOOR

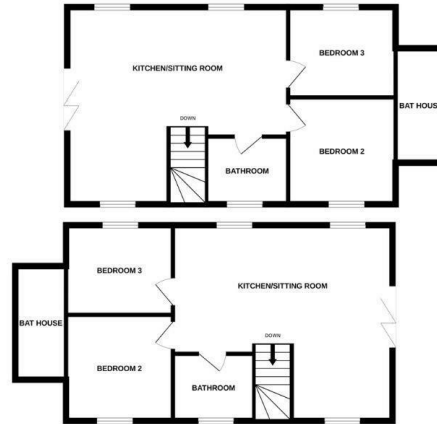

GROUND FLOOR

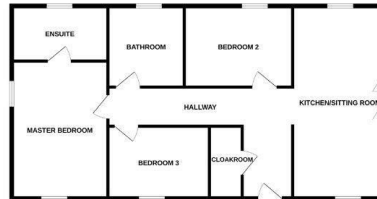

Disclaimer: These particulars do not form part of any contract and no responsibility is accepted for any errors or omissions in any statement made, whether verbally or written for or on behalf of Naylor Powell.

Floorplans have been prepared for identification purposes only, they are not to scale and no guarantee can be given as to their accuracy.

Prospective purchasers please be aware none of the appliances, boiler, heaters etc. which may have been mentioned in these particulars have been tested and no guarantee can be given that they are in working order. Prospective purchasers should arrange for such items to be tested at their own expense.

