



**2 Old Vicarage Church Road, Longhope GL17 0LG**  
**£475,000**



## 2 Old Vicarage Church Road, Longhope GL17 0LG

- Three double bedroom character property
- Generously sized family home offering versatile living accommodation throughout
- Private and enclosed garden
- Ample off road parking and garage
- Situated the highly sought after village of Longhope

**£475,000**

### Entrance Hall

Stepping into the property you are greeted by a spacious entrance hall which benefits wooden flooring throughout and a deep-set bay style window overlooking the front aspect.

### Living Room

Spacious living room featuring a cast iron fireplace with working open fire, original marble surround and granite hearth along with double doors leading into the sun room and a deep-set bay style window overlooking the front aspect of the property to draw in the natural light.

### Dining Room

Generously sized dining room boasting inset wood burner with oak wood mantle, wooden flooring throughout and windows to both the front and rear aspect of the property.

### Sun Room

The sun room stretches the width of the property and offers a spacious and versatile area. Currently utilised by the current owners as a play room, this room overlooks the back garden and benefits from doors to outside.

### Kitchen

From the dining room and through an attractive, original period door you are met with a well appointed country style kitchen boasting a Belfast sink, wooden worktops as well as a central island with space for seating and storage. The kitchen also includes a range of floor and eye level units along with space for a dishwasher, oven and fridge/freezer.

### Utility Room

Just off from the kitchen the utility room provides extra cupboard storage along with wooden worktop space and a Belfast style sink with mixer tap. Window overlooking the rear garden.

### WC

White suite comprising WC and hand wash basin.

### Master Bedroom

Double bedroom with feature bay style window to the front aspect and window to the rear aspect overlooking the back garden.

### Second Bedroom

Double bedroom with a window overlooking the front aspect.



1 High Street, Newent, GL18 1AN

01531 828970

[newent@naylorpowell.com](mailto:newent@naylorpowell.com)

[www.naylorpowell.com](http://www.naylorpowell.com)



GROUND FLOOR

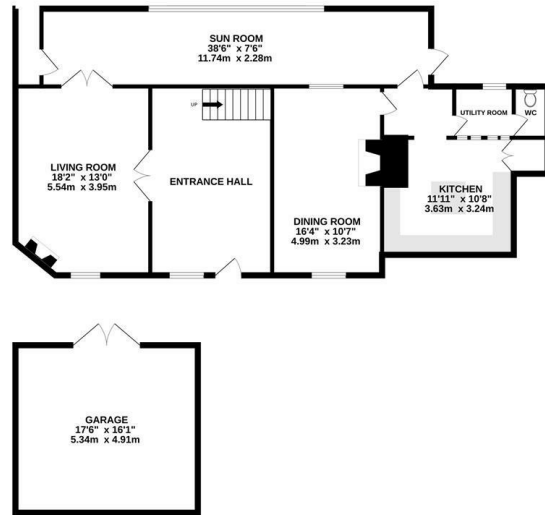

1ST FLOOR

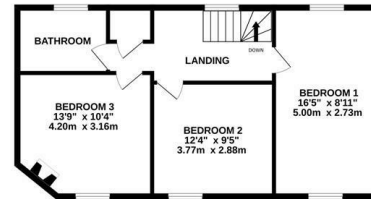

Whilst every attempt has been made to ensure the accuracy of the floorplan contained here, measurements of doors, windows, rooms and any other items are approximate and no responsibility is taken for any error, omission or mis-statement. This plan is for illustrative purposes only and should be used as such by any prospective purchaser. The services, systems and appliances shown have not been tested and no guarantee as to their operability or efficiency can be given.  
Made with Metropix ©2025

Disclaimer: These particulars do not form part of any contract and no responsibility is accepted for any errors or omissions in any statement made, whether verbally or written for or on behalf of Naylor Powell.

Floorplans have been prepared for identification purposes only, they are not to scale and no guarantee can be given as to their accuracy.

Prospective purchasers please be aware none of the appliances, boiler, heaters etc. which may have been mentioned in these particulars have been tested and no guarantee can be given that they are in working order. Prospective purchasers should arrange for such items to be tested at their own expense.

