



85 Court View, Stonehouse GL10 3PJ

£1,000 PCM

np
naylor powell

85 Court View, Stonehouse GL10 3PJ

• Two double bedrooms • Low maintenance rear garden • One allocated off road parking space • Local amenities • Gas heating • EPC D67



Regent House, 1 Bath Road, Stonehouse, GL10 2JD

01453 827640

stonehouse@naylorpowell.com

www.naylorpowell.com

£1,000 PCM

Services & Material information

Rent: £1,000 per calendar month

Holding Deposit: £230 based on 1 weeks' rent of asking price

Security Deposit: £1,153 based on 5 weeks' rent of asking price

Council tax band: B

Local authority and rates: Stroud

District Council - £1,883.49 25/26

Electricity supply: Mains

Water supply: Mains

Sewerage: Mains

Heating: Gas Central Heating

Broadband speed: Standard 15 Mbps, Superfast 80 Mbps, Ultrafast 1000 Mbps

Mobile phone coverage: EE, Three, O2 & Vodafone



GROUND FLOOR
177 sq.ft. (16.5 sq.m.) approx.

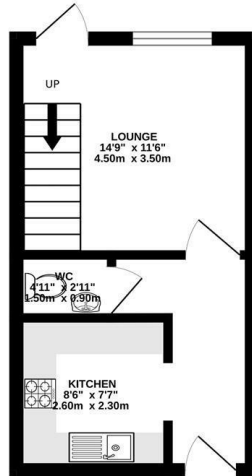

1ST FLOOR
177 sq.ft. (16.5 sq.m.) approx.

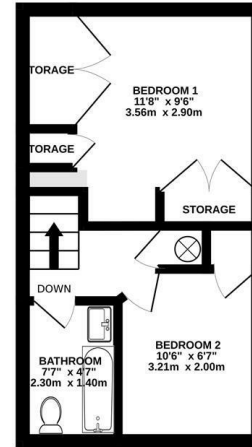

TOTAL FLOOR AREA : 354 sq.ft. (32.9 sq.m.) approx.

Whilst every attempt has been made to ensure the accuracy of the floorplan contained here, measurements of doors, windows, rooms and any other items are approximate and no responsibility is taken for any error, omission or mis-statement. This plan is for illustrative purposes only and should be used as such by any prospective purchaser. The services, systems and appliances shown have not been tested and no guarantee as to their operability or efficiency can be given.
Made with Metagon v2025.

Disclaimer: These particulars do not form part of any contract and no responsibility is accepted for any errors or omissions in any statement made, whether verbally or written for or on behalf of Naylor Powell.

Floorplans have been prepared for identification purposes only, they are not to scale and no guarantee can be given as to their accuracy.

Prospective purchasers please be aware none of the appliances, boiler, heaters etc. which may have been mentioned in these particulars have been tested and no guarantee can be given that they are in working order. Prospective purchasers should arrange for such items to be tested at their own expense.

