



Abbots Way, Stonehouse GL10 2AU
£289,000



Abbots Way, Stonehouse GL10 2AU

• Mid-terrace house tastefully finished throughout • Three bedrooms • Renovated by current owner • Open plan living space • Enclosed garden with rear access • Garage with power and light and driveway parking for one vehicle • Good transport links and close to local amenities • Freehold • Council tax band B (£1,883.49) • EPC rating D64

£289,000



Regent House, 1 Bath Road, Stonehouse, GL10 2JD

01453 827640

stonehouse@naylorpowell.com

www.naylorpowell.com

Porch

Door to porch with wooden door to hallway.

Hallway

Access to living room, kitchen, garage, under-stairs cupboard and stairs rising to the first floor. Radiator.

Open Plan Living Space

uPVC double-glazed window to front and rear elevation and uPVC double-glazed door to rear garden. Gas fireplace. Open plan access to kitchen. Two radiators.

Kitchen

Two uPVC double-glazed windows to rear elevation. Range of wall and base units with appliances to include sink with mixer tap and drainer, four ring electric hob, oven, integrated dishwasher. Space for under-counter fridge/freezer. Breakfast bar.

Bedroom One

uPVC double-glazed window to rear elevation. Radiator.

Bedroom Two

uPVC double-glazed window to front elevation. Radiator.

Bedroom Three

uPVC double-glazed window to front elevation. Radiator.

Shower Room

uPVC double-glazed window to rear elevation. Low-level WC, wash hand basin and walk in shower. Heated towel rail.

Outside

The property has driveway parking for one vehicle. The front garden is laid to patio with raised beds and a lawned area. The rear garden is fully enclosed and has access to a shared footpath. It is mostly laid to lawn with a patio space and footpath alongside side.

Location

The property is located just on the edge of Stonehouse town. Local facilities include a Co-op with a Post Office, restaurants, primary and secondary schools. The property is approximately four miles to Junction 12 of the M5 motorway providing access to Gloucester, Cheltenham and Bristol. Stonehouse railway station has a regular train service to London and Cheltenham. The town is situated approximately three miles west of Stroud and twelve miles south of Gloucester.

Material Information

Tenure: Freehold.

Council tax band: B.

Local authority and rates: Stroud District Council - £1,883.49 (2025/26).

Electricity supply: mains.

Water supply: mains.

Sewerage: mains.

Heating: gas central heating.

Broadband speed: 16 Mbps (basic), 80 Mbps (superfast) and 1,800 Mbps (ultrafast).

Mobile phone coverage: EE, Three, O2 and Vodafone.



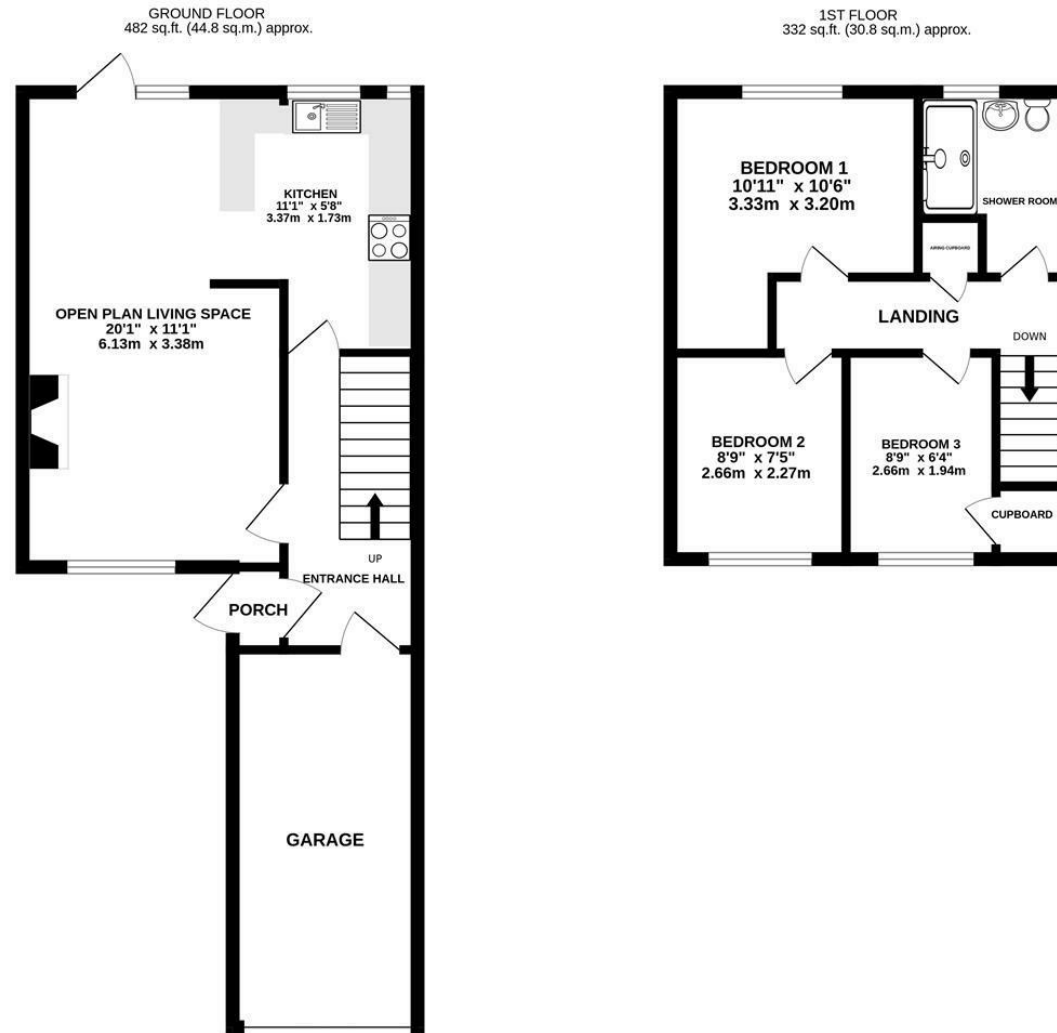

TOTAL FLOOR AREA: 814 sq.ft. (75.6 sq.m.) approx.

Whilst every attempt has been made to ensure the accuracy of the floorplan contained here, measurements of doors, windows, rooms and any other items are approximate and no responsibility is taken for any error, omission or mis-statement. This plan is for illustrative purposes only and should be used as such by any prospective purchasers. The services, systems and appliances shown have not been tested and no guarantee as to their operability or efficiency can be given.

Made with Metropix ©2025

Disclaimer: These particulars do not form part of any contract and no responsibility is accepted for any errors or omissions in any statement made, whether verbally or written for or on behalf of Naylor Powell.

Floorplans have been prepared for identification purposes only, they are not to scale and no guarantee can be given as to their accuracy.

Prospective purchasers please be aware none of the appliances, boiler, heaters etc. which may have been mentioned in these particulars have been tested and no guarantee can be given that they are in working order. Prospective purchasers should arrange for such items to be tested at their own expense.

