



9 St Francis Way Rookery Road, Innsworth GL3 1AR
£230,000



9 St Francis Way Rookery Road, Innsworth GL3 1AR

• Chain free • Garage and parking • Newly fitted shower room • Modern kitchen • Ideal first time buy or buy to let • Well presented throughout • Sought after location of Innsworth • Private and enclosed rear garden • EPC C73 • Tax Band B - Tewkesbury Borough Council - £1,687.63 per annum (2026/27)



59 Hucclecote Road, Hucclecote, Gloucestershire, GL3 3TL

01452 941950

hucclecote@naylorpowell.com

www.naylorpowell.com

£230,000

Porch

Doors to the garage and hall.

Hall

Stairs to the first floor and door to the living room.

Living Room

Window to front elevation, understairs storage cupboard.

Kitchen/Dining Room

A range of base and wall units with worktop over, inset one-bowl sink, space for a washing machine, integrated oven and hob with extractor hood over, tiled flooring, and door to garden.

First Floor Landing

Doors to both bedrooms and the shower room.

Bedroom One

Window to front elevation, wall-mounted gas boiler.

Bedroom Two

Window to rear elevation.

Shower Room

Newly fitted with large shower cubicle, WC, wash hand basin, and window to the rear elevation.

Outside

The property boasts a generously sized garden, complete with a patio area ideal for outdoor dining and entertaining. Additional features include an external power supply, water tap, and a shed with power. Further

enhancing its appeal, the property offers off-street parking alongside a garage, providing ample storage and convenience.

Garage

16'7" x 7'10" (5.06 x 2.40)

Power and light, up-and-over door to front elevation, internal door to porch.

Location

A lively community popular with first-time buyers and families, Innsworth provides ample amenities to include the community centre, local shop, takeaways, infant and junior schooling, alongside good public transport links, being on the bus route to both Cheltenham, Gloucester, and Tewkesbury.

Material Information

Tenure: Freehold.

Local Authority and Rates: Tewkesbury Borough Council - Tax Band B (£1,687.63 per annum) 2026/2027.

Electricity supply: Mains.

Water supply: Mains.

Sewerage: Mains.

Heating: Gas central heating.

Broadband speed: Basic 4 Mbps, Ultrafast 1000 Mbps.

Mobile phone coverage: EE, Three, Vodafone, O2 are all likely.



GROUND FLOOR
533 sq.ft. (49.5 sq.m.) approx.

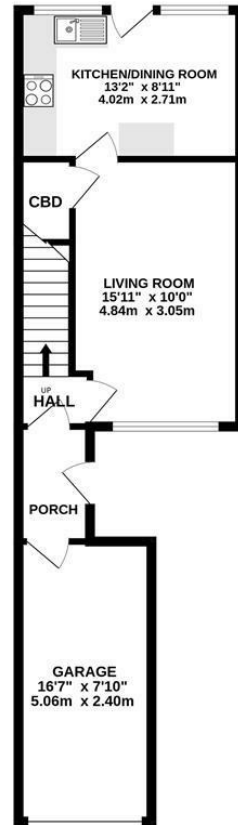

1ST FLOOR
328 sq.ft. (30.5 sq.m.) approx.

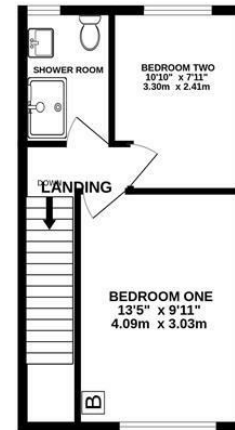

TOTAL FLOOR AREA : 861 sq.ft. (80.0 sq.m.) approx.

Whilst every attempt has been made to ensure the accuracy of the floorplans contained here, measurements of doors, windows, rooms and any other items are approximate and no responsibility is taken for any error, omission or mis-statement. This plan is for illustrative purposes only and should be used as such by any prospective purchaser. The services, systems and appliances shown have not been tested and no guarantee as to their operability or efficiency can be given.
Made with Metropix (52026)

Disclaimer: These particulars do not form part of any contract and no responsibility is accepted for any errors or omissions in any statement made, whether verbally or written for or on behalf of Naylor Powell.

Floorplans have been prepared for identification purposes only, they are not to scale and no guarantee can be given as to their accuracy.

Prospective purchasers please be aware none of the appliances, boiler, heaters etc. which may have been mentioned in these particulars have been tested and no guarantee can be given that they are in working order. Prospective purchasers should arrange for such items to be tested at their own expense.

