



50 Hanover Mill, Quayside NE1 3AB

** IF CASH BUYER, THE VENDOR WILL REDUCE to £210k**
 A SUPERB PENTHOUSE LAYOUT apartment spanning over 1900 sq ft with;

- TWO DOUBLE BEDROOMS
- Entertainment Room
- ONE RECEPTION ROOM
- Study
- Open Plan Kitchen / Diner
- TWO BATHROOMS
- Balcony
- ALLOCATED PARKING
- Tenanted Until July

This unique apartment offers an exceptional amount space and is a MUST SEE.
 Available with no onward chain.

- Home Buyers & Investors
- No Onward Chain
- Two Double Bedrooms
- Entertainment Room
- Open Plan Kitchen/Diner
- One Reception Room
- Two Bathrooms
- Balcony
- Allocated Parking
- Vendor will Reduce Price if Cash Buyer

Price £230,000 Leasehold

101 Percy Street, City Centre, Newcastle upon Tyne, NE1 7RY
 T: 0191 649 7008 | Email: sales@waltonrobinson.com | www.waltonrobinson.com

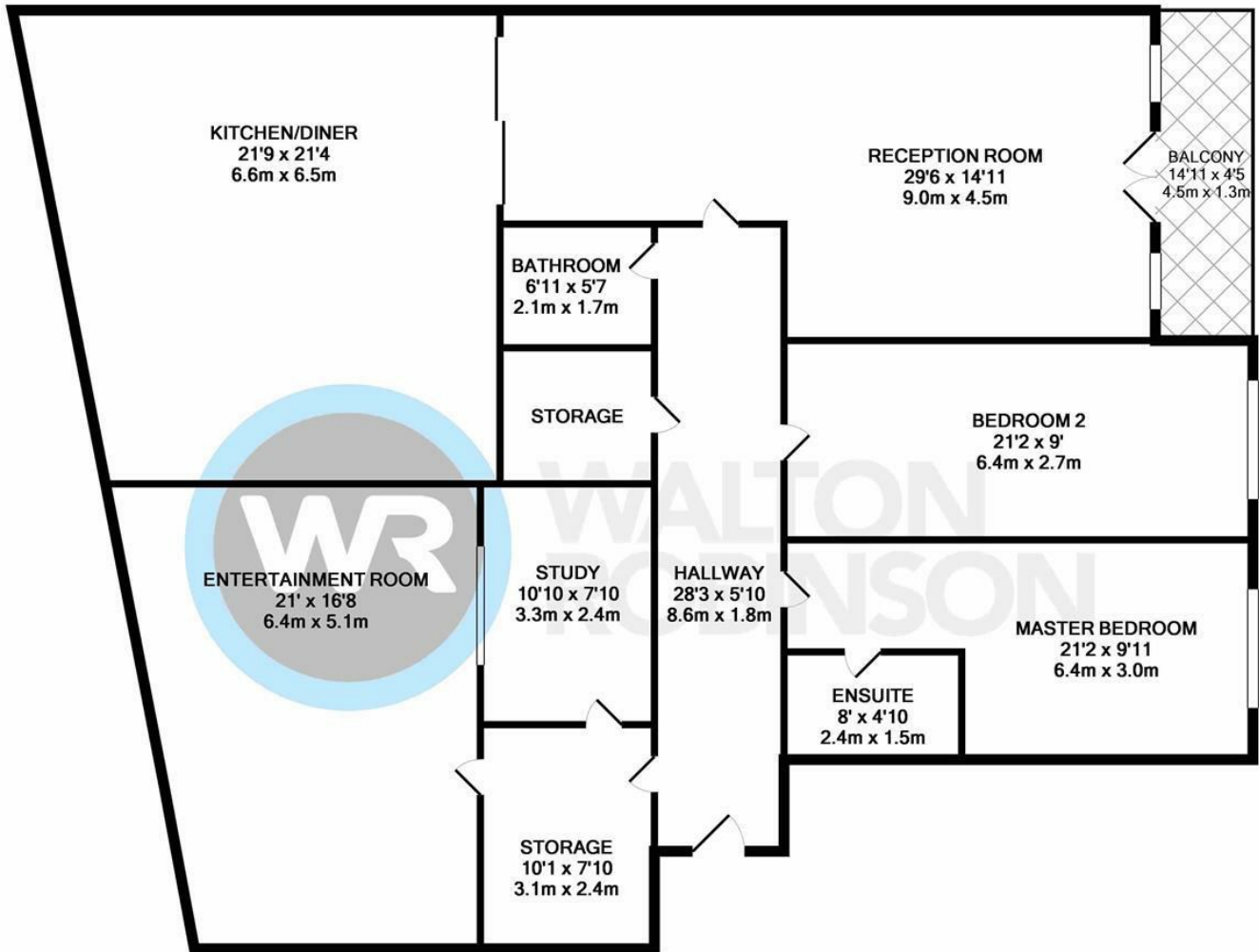

TOTAL APPROX. FLOOR AREA 1920 SQ.FT. (178.3 SQ.M.)

Whilst every attempt has been made to ensure the accuracy of the floor plan contained here, measurements of doors, windows, rooms and any other items are approximate and no responsibility is taken for any error, omission, or mis-statement. This plan is for illustrative purposes only and should be used as such by any prospective purchaser. The services, systems and appliances shown have not been tested and no guarantee as to their operability or efficiency can be given
Made with Metropix ©2019

