

# HA (SHARED)

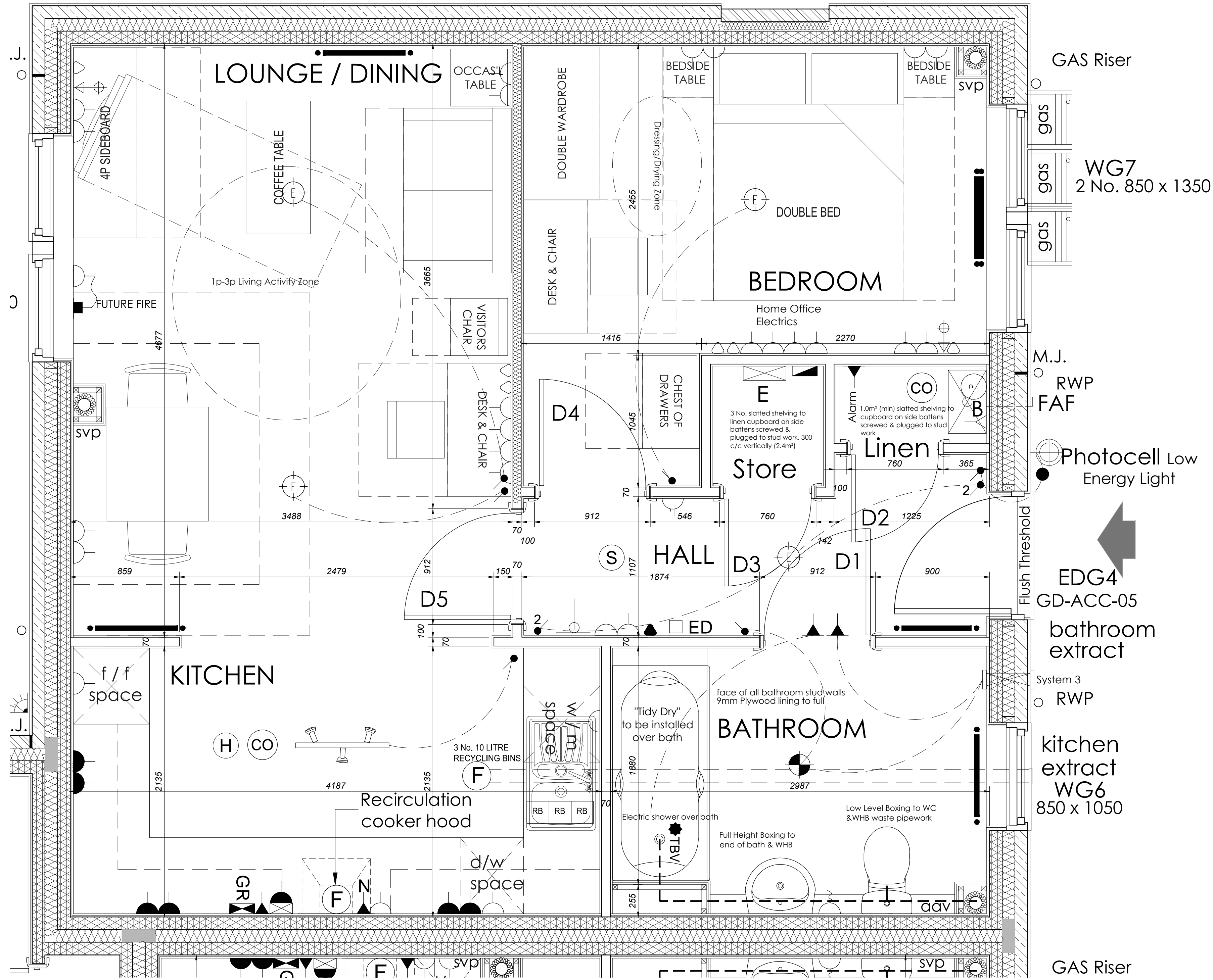

### Electrical Symbols Legend

All electrical work should meet the requirements of Part P Building regulations and must be designed, installed and tested by a person competent to do so. A certificate of electrical installation must be issued on completion.

	Twin switched socket outlet 13A	mounted 450 above f.f.l.
	Twin switched socket outlet 13A	mounted 1050 above f.f.l.
	13A socket in appliance space	separately switched from grid ring
	13A socket in appliance space	separately switched
	Fused isolator switch (N) = Neon indicator	
	Fused connection to boiler where applicable	
	Shaver socket blank	mounted 1800 above f.f.l.
	Cooker control panel	mounted 1050 above f.f.l.
	Combined light & shaver socket over mirror	
	Consumer unit & DB (distribution board)	
	GR	mounted 1050 above f.f.l.
	Thermostat	mounted 1050 above f.f.l.
	Track lighting with spot lights	
	Pendant lamp (to be fitted with a low energy bulb)	
	Batten holder lamp	
	IP44 Rated Batten Lamps	
	IP24 Rated 60w external lamp with integral photocell	
	PIR to external lamps	
	Pelmet lights mounted under kitchen cabinets, wired supply only	
	Switch	mounted 1050 above f.f.l.
	2 way Switch	mounted 1050 above f.f.l.
	Pull switch	
	Digital TV outlet	mounted 450 above f.f.l.
	Telephone junction box	mounted 450 above f.f.l.
	Telephone master socket	mounted 450 above f.f.l.
	Ceiling mounted extract fan	
	Fully automatic smoke detector to BS 5446 (minimum 2No.) interlinked and hardwired to mains	
	Boiler programmer	
	Battery operated carbon monoxide detector fitted in accordance with manufacturers instructions	
	Home Network Socket	
	Bell push	
	Bell sounder	
	Electricity Meter as shown Internally	
	Indicative boiler position	
	Radiator	
	Tubular Heater	
	External tap	
	Immersion heater	
	TBV	In-line thermostatic blending valve to limit hot water supply temperature to a maximum of 48 °C
	Entry phone call/speaker unit	
	Entry phone receiver	
	Light sensor/time switch	

Note dimensions shown are to u/s of electrical plate

A SUITABLE NUMBER (AT LEAST ONE ON EACH FLOOR) OF SELF CONTAINED SMOKE ALARMS MUST BE INSTALLED. THE ALARMS SHOULD BE INTERCONNECTED AND FIXED TO THE CEILING IN A CENTRAL POSITION BUT AT LEAST 300MM FROM ANY LIGHT FITTING. THE ALARM MUST BE FIXED STRICTLY IN ACCORDANCE WITH THE MANUFACTURERS INSTRUCTIONS.

INSTALL BOILER TO HAVE A DRY NOX LEVEL OF LESS THAN OR EQUAL TO 40 mg/kWh.

**Code 3 Water Usage - Housing Association Plots**

**Water Flow Rate & Fill Capacity Schedule**

All WCs (Dual flush) 4/2.6 litres capacity (max.)  
 All toilet taps: 4 litres 1 minute flow rate (max.)  
 All kitchen / utility sink taps: 4 litres 1 minute flow rate (max.)  
 All showers: 6 litres 1 minute flow rate (max.)

### Code for Sustainable Homes Notes - Code 3

- Enr. 4 Refer to External Works drawing for locations of Rotary Lines, spikes to be concreted in place
- Enr. 5 All supplied White Goods to be minimum A Rated
- Enr. 6 Provide dedicated energy efficient fittings, PIR sensors to rear doors and down to dusk cut off control to front doors. Provide vacuum or timer switches to low energy CFL lamp bulbs to communal areas.
- Enr. 8 Refer to External Works drawing for location and size of cycle storage shed. All sheds to be fitted with a steel cycle hoop bolted down to the concrete base slab.
- Enr. 2 Provide a home office to be located in a bedroom other than the master bedroom for dwellings with three or more bedrooms, or to be located in either the living room or bedroom or dining area for dwellings with two or less bedrooms or studio homes. Home office to have minimum 2no. double sockets and either 2no. telephone points or 1 no. telephone point if the dwelling has access to cable or broadband service. Home office to have an operable window with average daylight factor of 1.5% and a minimum wall length of 1.8m.
- Wat.2 Provide detachable water butts connected to the down pipe with automatic overflow into the rainwater system with a tap and child proof lid, as follows:  
 3 and 4 bed homes with private garden: 200 litres minimum  
 Apartments to be fitted with 2no. 200 litre butts for communal use  
 Refer to External Works and Drainage drawings for locations.
- Was.1 Provide 3No internal recycling bins with a total of 30 litres min. capacity with no single bin smaller than 7 litres capacity to be located & fixed in a dedicated kitchen cupboard under the sink or another cupboard next to a non-recyclable waste bin.
- Was.3 Entrance door to have a level threshold in order to provide accessibility to the external compartment bin for disabled people. Refer to External Works drawings for locations.
- Man.4 All external and apartment entrance doors long with all ground floor windows to be Secure by Design Compliant and Certified.

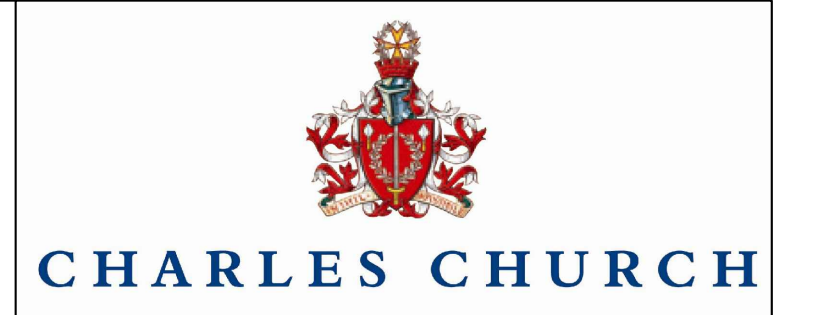

100mm @ A1

DRAWING STATUS:  
**TENDER**

GENERAL NOTES  
 1. DO NOT SCALE  
 2. All dimensions are in millimeters unless stated otherwise

A Energy display device added MG 26/03/15

REV	AMENDMENTS	BY	DATE
-----	------------	----	------



**design lab architectural services**  
 Design Lab Architectural Services  
 65 Oxford Road  
 Canterbury  
 Kent  
 CT1 3QP  
 Tel. no : 01222 478974  
 Email : info@dlarchitecturalservices.com

Drawn : MG Date : JULY 2014  
 Scale : 1:20 Checked : MG

Title :  
**PLOTS 22 - 30  
 FLAT TYPE A2  
 PLOT 28**

Job :  
 HATCHWOOD  
 FARNHAM ROAD, ODIHAM  
 Drg. No :  
**PLOTS 22-30 - 016**  
 Dwg file name:  
 Rev :  
 A1

Flat type A2 Floor Area:			
Gross	49.85 sqm	536 sq ft	
Nett	49.14 sqm	528 sq ft	
<b>WHOLE BUILDING VENTILATION RATE</b>		14.74/s	
No of fans within building		2 No	
Method	Rate l/s	Additions	Total
No of Bedrooms = 1	13		13/s
Total area - 49.14m <sup>2</sup>	14.74		14.74/s
<b>WHOLE BUILDING EXTRACT RATE</b>		21 L/S	
Method	13L/s Kitchen 8L/s Bathroom		Total 21 L/S
<b>FAN SETTINGS</b>		TRICKLE RATE	BOOST RATE
KITCHEN	10 L/S		15 L/S
BATHROOM	10 L/S		
TOTAL	20 L/S		
Background Ventilation - 2500mm <sup>2</sup> Habitable room			
2500 x 2 = 5,000mm <sup>2</sup>			

### TYPE A2 - Internal Opening Schedule

opening reference	door size	structural opening	lintel length	F/R
D1	838 x 1981	912 x 2031	NR	NR
D2	686 x 1981	760 x 2031	NR	NR
D3	686 x 1981	760 x 2031	NR	NR
D4	838 x 1981	912 x 2031	NR	NR
D5	838 x 1981	912 x 2031	NR	NR

BF Blind doors  
 M Modified to suit opening  
 FOR LINTEL REFS, REFER TO MANUFACTURERS SCHEDULE

# BLOCK A - PLOTS 22 - 30 FLAT TYPE A2 - PLOT 28