



6 Waterford Close

Platt Bridge, Wigan, WN2 5BX

£775 PCM



We are delighted to offer For Rent this well presented two bed town house. Within walking distance of all amenities and bus routes into Wigan Town Centre. The House comprises of a entrance hall, ground floor Cloaks, Lounge, modern fitted Kitchen all with laminate flooring. To the first floor is the family Bathroom with shower over bath and two double bedrooms - master with large fitted robes. To the rear of the property is a well maintained garden area with patio, lawn and borders and to the front a driveway. Gas Central Heating and Double Glazing throughout. Internal decor has been finished to a tasteful standard throughout. Early internal viewing is highly recommended.



GROUND FLOOR

Entrance / Hallway

Kitchen / Diner

Lounge

WC

FIRST FLOOR

Landing

Master Bedroom

Bedroom 2

Bathroom

EXTERNAL

Rear Garden

Area Map



Floor Plans

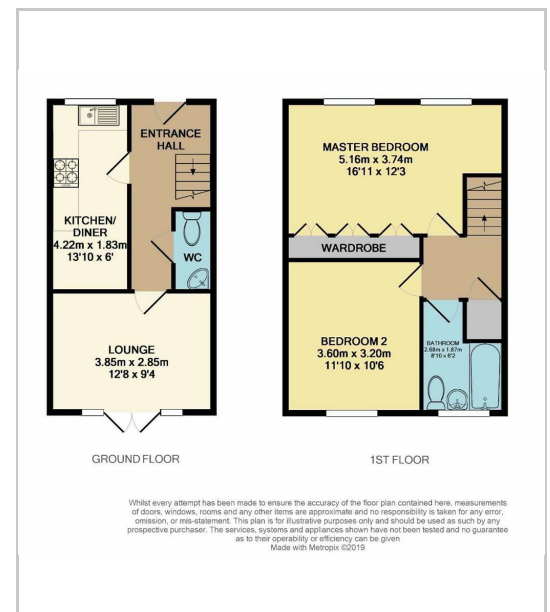

Energy Efficiency Graph

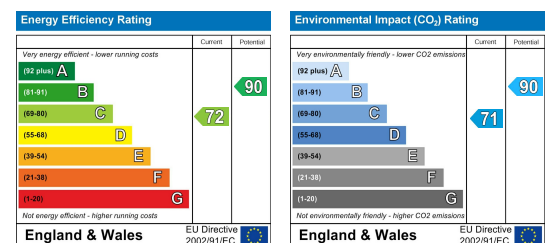

These particulars, whilst believed to be accurate are set out as a general outline only for guidance and do not constitute any part of an offer or contract. Intending purchasers should not rely on the representation of fact, but must satisfy themselves by inspection or otherwise as to their accuracy. No person in this firm's employment has the authority to make or give any representation or warranty in relation to the property.



Sapphire Homes (North) Ltd 80 Market Street, Wigan WNI 1HX
 T 01942 494944 E info@sapphirehomes.co.uk W www.sapphirehomes.co.uk VAT 183 759 366

specialists in sales, Lettings & Property Investments